

Section 14
T. 2 S., R 98 W
6th. P.M.



ACCESS DESCRIPTION:

FROM THE INTERSECTION OF STATE HIGHWAY 13 AND RIO BLANCO COUNTY ROAD 6 PROCEED WESTERLY TO NORTHWESTERLY ALONG COUNTY ROAD 6 ± 27.0 MILES TO THE INTERSECTION WITH COUNTY ROAD 24, PROCEED WESTERLY ALONG COUNTY ROAD 24 ± 2.9 MILES TO THE INTERSECTION WITH A DIRT/GRAVEL ROAD, PROCEED LEFT IN A SOUTHERLY TO WESTERLY TO NORTHEASTERLY DIRECTION ± 4.5 MILES TO THE EXISTING RG 23-14-298 DRILL PAD LOCATION, AS SHOWN HEREON.

REVISED: 6/14/10

RG 23-14-298

Construction Plan Prepared for:
Williams Williams Production, RMT

136 East Third Street
Rifle, Colorado 81650
Ph. (970) 625-1330
Fax (970) 625-2773



BOOKCLIFF
Survey Services, Inc.

SCALE: 1" = 2000'
DATE: 5/19/10
Drawing: 7 of 10
PROJECT: Williams Highlands
DFT: CWS

RG 23-14-298 Drill Pad - Sheet 7
Access

Section 14
T. 2 S., R. 98 W
6th. P.M.

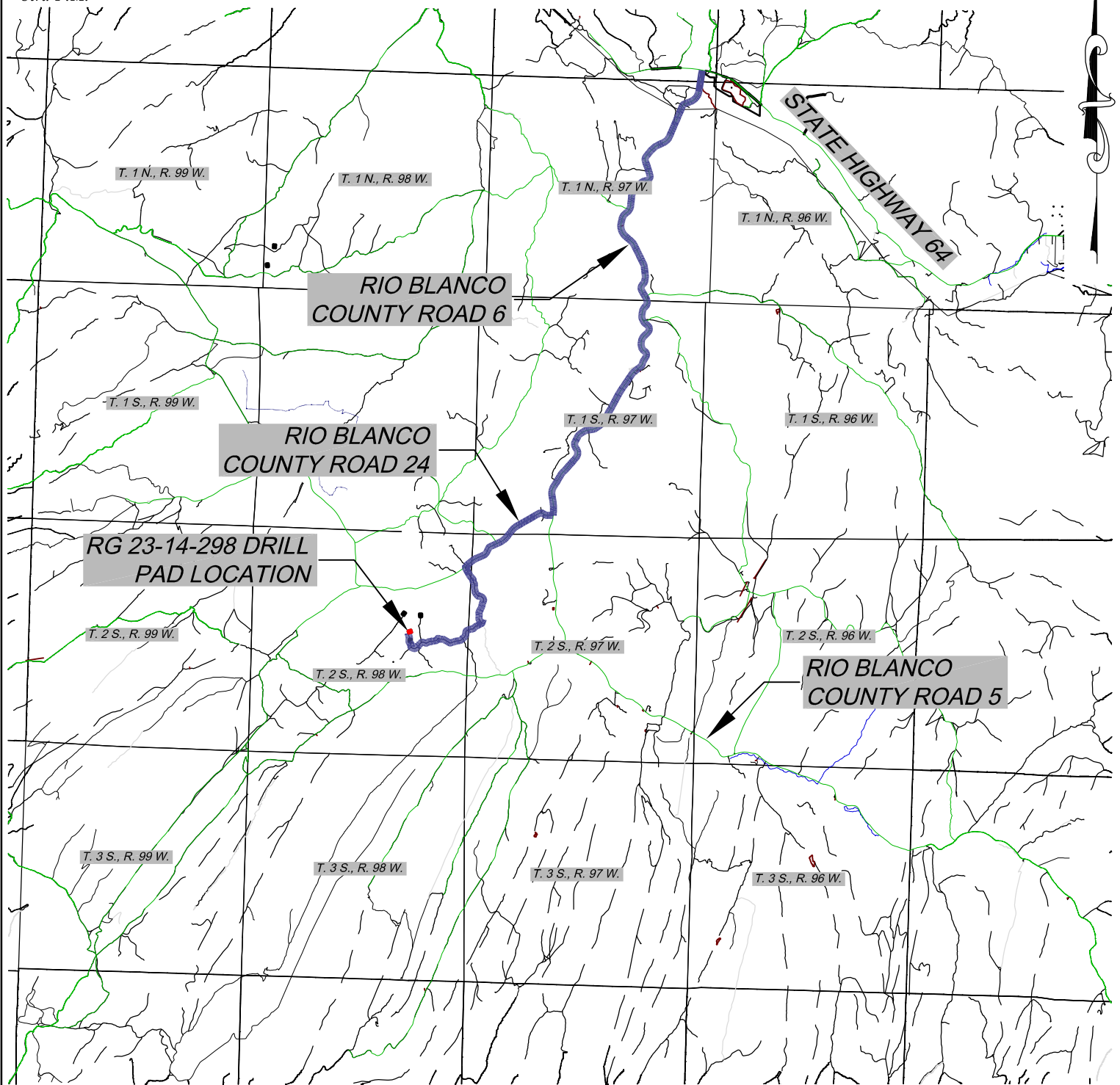

ACCESS DESCRIPTION:

FROM THE INTERSECTION OF STATE HIGHWAY 13 AND RIO BLANCO COUNTY ROAD 6 PROCEED WESTERLY TO NORTHWESTERLY ALONG COUNTY ROAD 6 ± 27.0 MILES TO THE INTERSECTION WITH COUNTY ROAD 24, PROCEED WESTERLY ALONG COUNTY ROAD 24 ± 2.9 MILES TO THE INTERSECTION WITH A DIRT/GRAVEL ROAD, PROCEED LEFT IN A SOUTHERLY TO WESTERLY TO NORTHEASTERLY DIRECTION ± 4.5 MILES TO THE EXISTING RG 23-14-298 DRILL PAD LOCATION, AS SHOWN HEREON.

REVISED: 6/14/10

RG 23-14-298

Construction Plan Prepared for:
Williams Williams Production, RMT

RG 23-14-298 Drill Pad - Sheet 9

REGIONAL ACCESS

136 East Third Street
Rifle, Colorado 81650
Ph. (970) 625-1330
Fax (970) 625-2773



SCALE: 1" = 20000'
DATE: 5/19/10
Drawing: 9 of 10
PROJECT: Williams Highlands
DFT: CWS