

# EXHIBIT A KP KAUFFMAN SURFACES AGREEMENT MILLIKEN RESOURCE

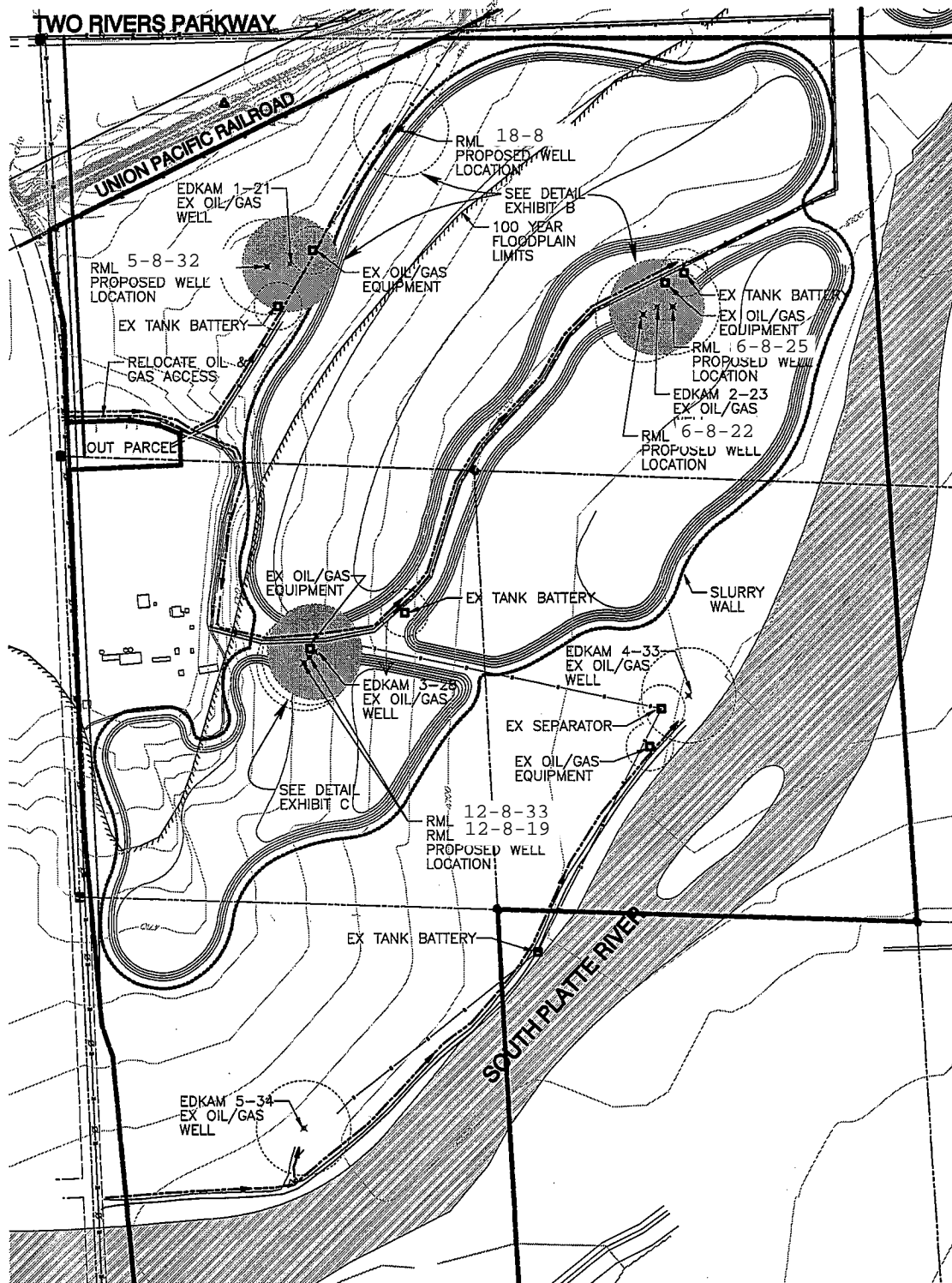

0 250 500  
SCALE 1" = 500'  
DATE: OCT 6, 2008

## LEGEND

——— OIL & GAS ACCESS ROAD



**TJB Consulting Group**

2602 Clover Basin Drive, Suite 2B  
P.O. Box 1348  
Longmont, CO 80502  
303.632.2268  
fax 303.702.0585

Civil Engineering - Site Design - Project Coordination