

EOG RESOURCES, INC.
GARDEN CREEK #09-16H
LOCATED IN WELD COUNTY, COLORADO
SECTION 16, T11N, R62W, 6th P.M.

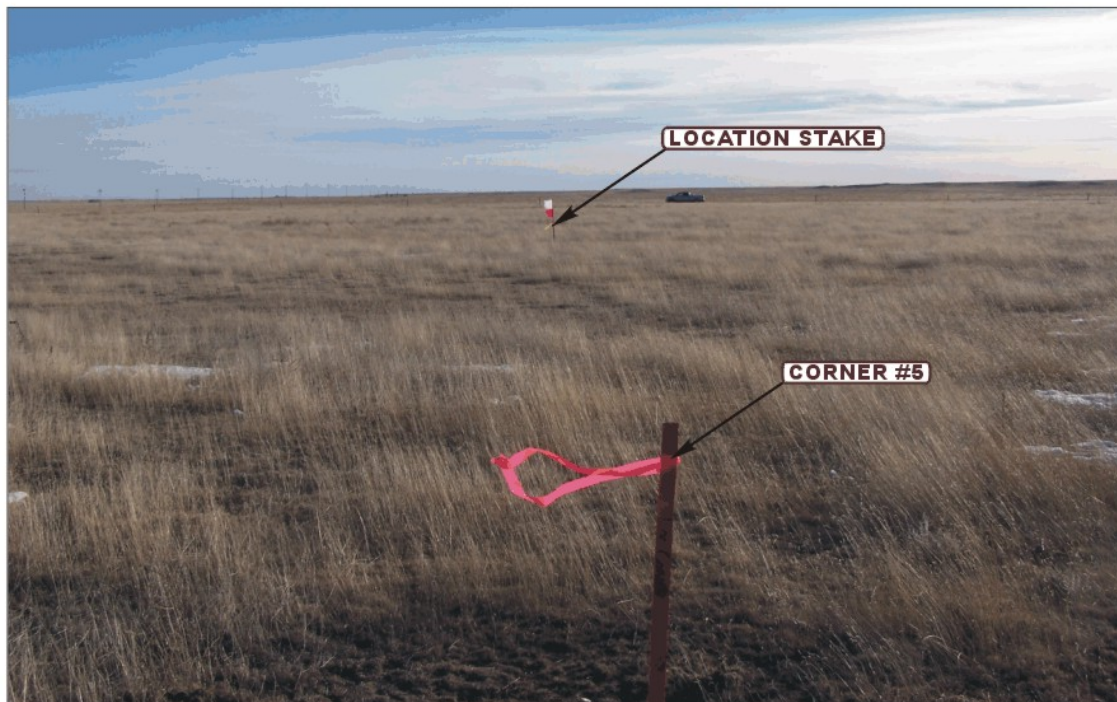

PHOTO: VIEW FROM CORNER #5 TO LOCATION STAKE

CAMERA ANGLE: SOUTHERLY



PHOTO: VIEW FROM BEGINNING OF PROPOSED ACCESS

CAMERA ANGLE: NORTHERLY



UELS

Uintah Engineering & Land Surveying

85 South 200 East Vernal, Utah 84078
435-789-1017 FAX (435) 789-1813

LOCATION PHOTOS

01 05 10
MONTH DAY YEAR

TAKEN BY: B.H.

DRAWN BY: J.H.

REVISED: 00-00-00

PHOTO
P 1

EOG RESOURCES, INC.
GARDEN CREEK #09-16H
LOCATED IN WELD COUNTY, COLORADO
SECTION 16, T11N, R62W, 6th P.M.



PHOTO: VIEW OF LOCATION STAKE

CAMERA ANGLE: NORTHERLY



PHOTO: VIEW OF LOCATION STAKE

CAMERA ANGLE: EASTERLY



UELS Uintah Engineering & Land Surveying
85 South 200 East Vernal, Utah 84078
435-789-1017 FAX (435) 789-1813

LOCATION PHOTOS

01 05 10
MONTH DAY YEAR

PHOTO
P 2

TAKEN BY: B.H.

DRAWN BY: J.H.

REVISED: 00-00-00

EOG RESOURCES, INC.
GARDEN CREEK #09-16H
LOCATED IN WELD COUNTY, COLORADO
SECTION 16, T11N, R62W, 6th P.M.



PHOTO: VIEW OF LOCATION STAKE

CAMERA ANGLE: SOUTHERLY



PHOTO: VIEW OF LOCATION STAKE

CAMERA ANGLE: WESTERLY



UELS

Uintah Engineering & Land Surveying
85 South 200 East Vernal, Utah 84078
435-789-1017 FAX (435) 789-1813

- Since 1964 -

LOCATION PHOTOS

01 05 10
MONTH DAY YEAR

TAKEN BY: B.H.

DRAWN BY: J.H.

REVISED: 00-00-00

PHOTO
P 3

EOG RESOURCES, INC.
GARDEN CREEK #09-16H
LOCATED IN WELD COUNTY, COLORADO
SECTION 16, T11N, R62W, 6th P.M.



PHOTO: VIEW OF REFERENCE AREA

CAMERA ANGLE: SOUTHERLY



PHOTO: VIEW OF REFERENCE AREA

CAMERA ANGLE: WESTERLY



- Since 1964 -

UELS

Uintah Engineering & Land Surveying
85 South 200 East Vernal, Utah 84078
(435) 789-1017 * FAX (435) 789-1813

**REFERENCE AREA
PHOTOS**

TAKEN BY: B.H.

DRAWN BY: J.H.

01 05 10
MONTH DAY YEAR

REVISED: 00-00-00

PHOTO
REF2