

Stanczyk, Jane

From: Craig, Jack [Jack.Craig@lm.doe.gov]
Sent: Wednesday, September 30, 2009 2:07 PM
To: Stanczyk, Jane
Cc: Hutton, Rick
Subject: Refile Applications

The Office of Legacy Management (LM) is reviewing aforementioned refile applications and the location map provided by COGCC for the following wells and their respective locations:

API APDs IN PROCESSING

BOTTOM HOLE LOCATION

NUMBER	WELL NAME	WELL #	LOCATION
045-16075	BATTLEMENT MESA	26-12BNWSW	Sec. 26 7S 95W
39.410888	107.971861		
045-16076	BATTLEMENT MESA	26-12CNWSW	Sec. 26 7S 95W
39.410017	107.971884		
045-16077	BATTLEMENT MESA	26-12DNWSW	Sec. 26 7S 95W
39.409064	107.971877		
045-16078	BATTLEMENT MESA	26-13ANWSW	Sec. 26 7S 95W
39.408132	107.971871		
045-16079	BATTLEMENT MESA	26-13BNWSW	Sec. 26 7S 95W
39.407283	107.971868		
045-16080	BATTLEMENT MESA	26-13CNWSW	Sec. 26 7S 95W
39.406433	107.971865		
045-16086	BATTLEMENT MESA	26-22BNWSW	Sec. 26 7S 95W
107.967228			39.41053

At this time, DOE does not request any additional information but would encourage COGCC to place general language in the permit such that the company would accommodate DOE sampling requests in the future. DOE agrees with the COGCC assessment that the pad is located approximately

1.15 miles from the Rulison site on an existing pad located at NSW Section 26 7S 95W, and the bottom-hole-locations range approximately from 1.08 to 1.31 miles from Project Rulison. From the locations provided all wells fall under the Tier 2 sampling and monitoring of the COGCC Rulison Sample and Analysis Plan and are located in Sector 10 of the Rulison SAP. DOE will continue to review the proposed locations and subsurface orientations of the proposed drilling for documentation when sampling occurs. Thank you for the opportunity to comment on these permit applications. Please e-mail or call at 240-252-8506 if you require further information.

Sincerely

Jack Craig

Stanczyk, Jane

From: Stanczyk, Jane
Sent: Friday, September 25, 2009 2:42 PM
To: 'Craig, Jack'; 'Rick Hutton'
Cc: Nesiin, David; Willis, Rob; Ahlstrand, Dennis; Andrews, David; King, Kevin; Lindblom, Steven; Canfield, Chris; Yokley, Bill; Garrison, Penny; Martin, James; 'Kate Fay'; Milne, James; 'luke@ldanielsonlaw.com'
Subject: Project Rulison - refile permits from Noble NWSW Section 26 7S 95W
Attachments: Project Rulison NOBLE APDs Sec 26 refiles 9-25-09.xls; image005.png; image006.png

Jack and Rick

Noble has submitted refile permits for 7 wells on an existing pad in the NWSW Section 26 7S 95W. The surface location is approximately 1.15 miles from the project well. The bottom hole locations are 1.08 to 1.31 miles from the project well. Noble owns the surface and the minerals. The refile permits have a letter Noble sent to Jack on Sept. 16, 2009. The well info spreadsheet is attached. Please let me know if you need any additional information.

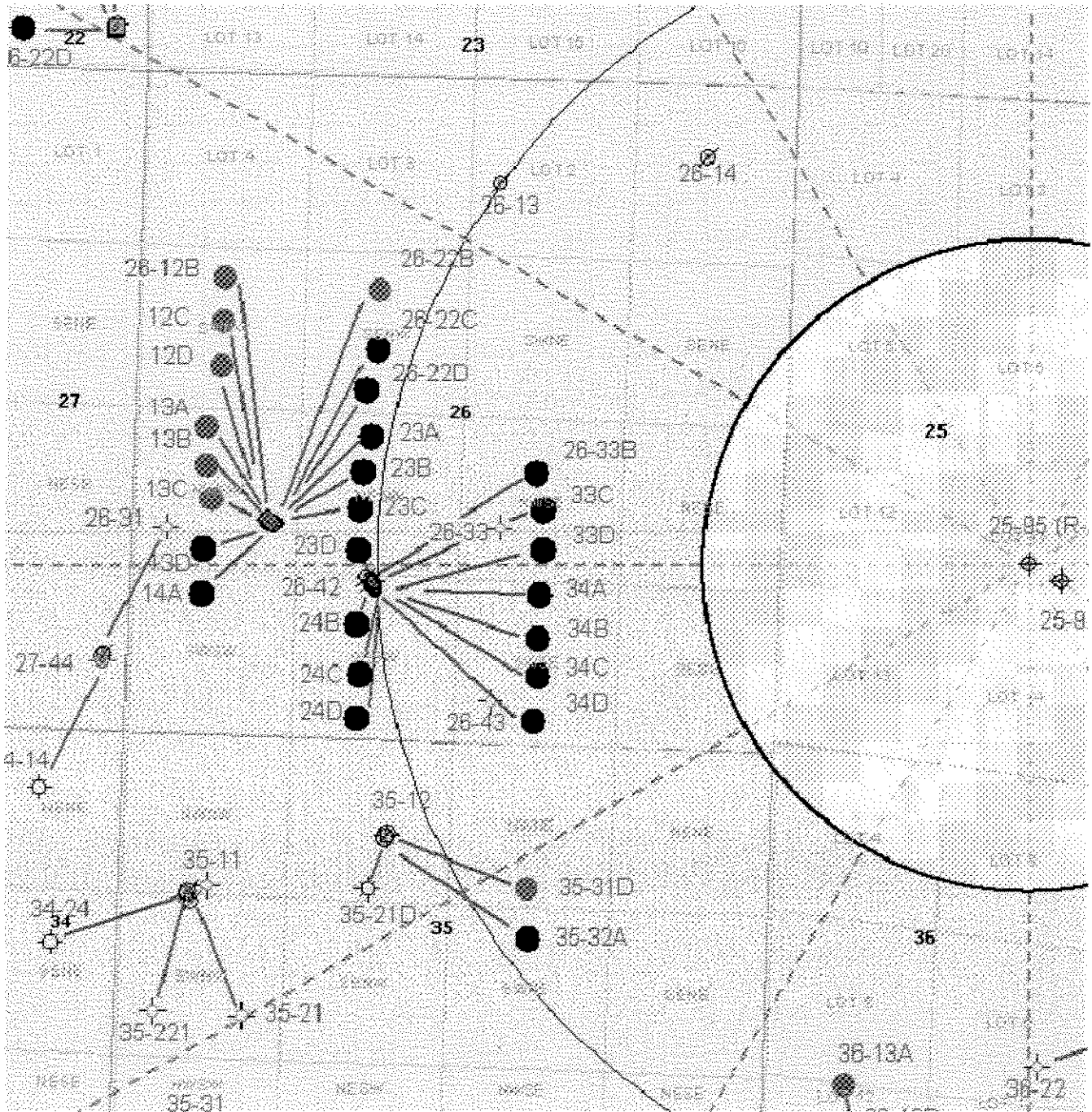

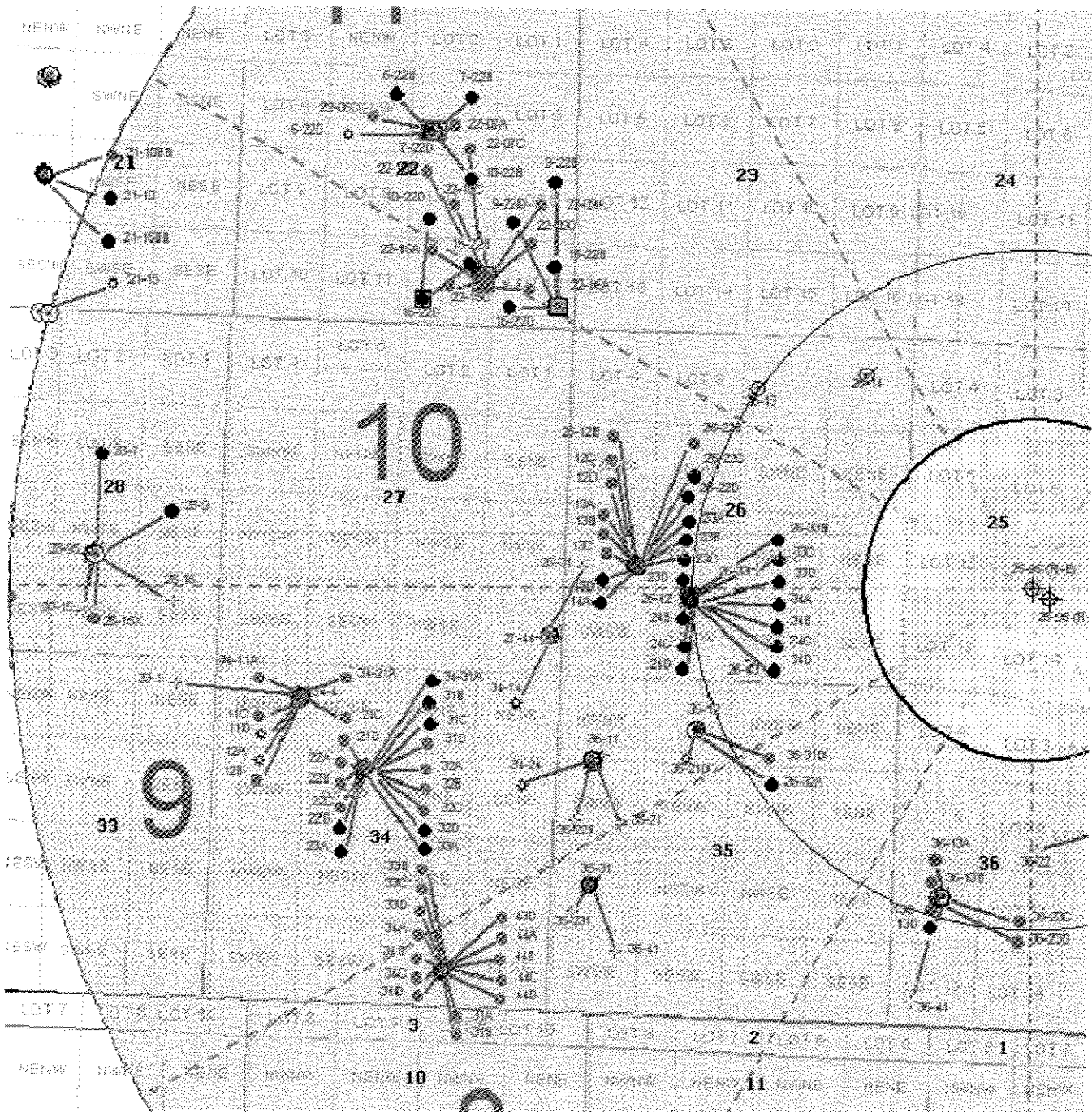

Jane Stanczyk
 Permitting Technician
 Colorado Oil and Gas Conservation Commission
 Phone: (303) 894 2100 ext. 5119
 FAX: (303) 894 2109
 E-mail: jane.stanczyk@state.co.us

Stanczyk, Jane

From: LPavelka@nobleenergyinc.com
Sent: Monday, September 28, 2009 9:10 AM
To: Stanczyk, Jane
Subject: Re: 26K pad refiles

can we take off - buried in cuttings pit? The mud itself is hauled off site, the cuttings are worked in at reclamation time.
thanks

"Stanczyk, Jane" <Jane.Stanczyk@state.co.us>

To <LPavelka@nobleenergyinc.com>

cc

09/25/2009 02:48 PM

Subject: 26K pad refiles

Linda

The mud disposal for all of these says OFFSITE, method = buried in cuttings pit

Wouldn't that be ONSITE disposal????

Jane Stanczyk
Permitting Technician
Colorado Oil and Gas Conservation Commission
Phone: (303) 894 2100 ext. 5119
FAX: (303) 894 2109
E-mail: jane.stanczyk@state.co.us