

**BEFORE THE OIL & GAS CONSERVATION COMMISSION  
OF THE STATE OF COLORADO**

IN THE MATTER OF AN APPLICATION BY  
EXTRACTION OIL & GAS INC. FOR AN ORDER  
POOLING ALL INTERESTS IN AN APPROXIMATE CAUSE NO. 407  
560-ACRE DESIGNATED HORIZONTAL DOCKET NO.  
WELLBORE SPACING UNIT FOR CERTAIN  
PORTIONS OF SECTIONS 18 AND 19, TOWNSHIP  
4 NORTH, RANGE 68 WEST, 6TH P.M. AND TYPE: POOLING  
CERTAIN PORTIONS OF SECTIONS 13 AND 24,  
TOWNSHIP 4 NORTH, RANGE 69 WEST, 6TH  
P.M., FOR THE DEVELOPMENT/OPERATION OF  
THE CODELL FORMATION, WATTENBERG  
FIELD, LARIMER AND WELD COUNTIES,  
COLORADO

**APPLICATION**

Extraction Oil & Gas Inc., Operator No. 10459 ("Extraction" or "Applicant"), by and through its attorneys, Beatty & Wozniak, P.C., respectfully submits this Application to the Oil and Gas Conservation Commission of the State of Colorado ("Commission") for an order pooling all interests in an approximate 560-acre horizontal wellbore spacing unit established for certain portions of Sections 18 and 19, Township 4 North, Range 68 West, 6<sup>th</sup> P.M. and certain portions of Sections 13 and 24, Township 4 North, Range 69 West, 6<sup>th</sup> P.M., for the development and operation of the Codell Formation. In support of its Application, Applicant states and alleges as follows:

1. Applicant is a corporation duly authorized to conduct business in the State of Colorado and has registered as an operator with the Commission.

2. Applicant is an Owner in the below-listed lands:

Township 4 North, Range 68 West, 6<sup>th</sup> P.M.

Section 18: SW $\frac{1}{4}$ SE $\frac{1}{4}$ ; S $\frac{1}{2}$ SW $\frac{1}{4}$

Section 19: N $\frac{1}{2}$ NW $\frac{1}{4}$ ; NW $\frac{1}{4}$ NE $\frac{1}{4}$

Weld County, Colorado

Township 4 North, Range 69 West, 6<sup>th</sup> P.M.

Section 13: S $\frac{1}{2}$ S $\frac{1}{2}$

Section 24: N $\frac{1}{2}$ N $\frac{1}{2}$

Larimer County, Colorado

***Wellbore Spacing Unit ("WSU") No. 1***

560 acres, more or less.

These lands are hereinafter collectively referred to as the "Application Lands" and depicted in Exhibit A, attached hereto.

3. On April 27, 1998, the Commission adopted Rule 318A. which, among other things, allowed certain drilling locations to be utilized to drill or twin a well, deepen a well or recomplete a well and to commingle any or all of the Cretaceous Age Formations from the base of the Dakota Formation to the surface. On December 5, 2005, Rule 318A. was amended to allow interior infill and boundary wells to be drilled and wellbore spacing units to be established. On August 8, 2011, Rule 318A. was again amended to, among other things, address drilling of horizontal wells. The Application Lands are subject to Rule 318A.

4. Upon information and belief, Applicant designated an approximate 560-acre horizontal wellbore spacing unit comprised of the Application Lands, for the below-described well, for the production of oil, gas, and associated hydrocarbons from the Codell Formation. Applicant notified all owners in the proposed wellbore spacing unit pursuant to Rule 318A.e.(5). Applicant did not receive objections to the establishment of the proposed horizontal wellbore spacing unit within the 30-day response period:

- a. Enright 16C Well (API No. to be assigned) - Codell Formation - WSU #1.

This well is hereinafter referred to as the "Subject Well."

5. Acting pursuant to the relevant provisions of §34-60-116(6) & (7), C.R.S., and Rule 530., Applicant seeks an order pooling all interests, including, but not limited to, any nonconsenting interests, in WSU No. 1 established for the Application Lands, for the development and operation of the Codell Formation.

6. Applicant requests that the Commission's pooling order be made effective as of the earlier of the date of this Application, or the date that the costs specified in §34-60-116(7)(b), C.R.S. are first incurred for the drilling of the Subject Well within WSU No. 1.

7. Further, Applicant requests that the interests of any owners with whom the Applicant has been unable to secure a lease or other agreement to participate in the drilling of the Subject Well, are made subject to the cost recovery provisions of §34-60-116(7), C.R.S., effective as of the earlier of the date of the Application, or the date the costs specified in §34-60-116(7)(b), C.R.S. are first incurred for the drilling of the Subject Well.

8. The granting of this Application is in accord with the Oil and Gas Conservation Act, found at §§34-60-101, et seq., C.R.S., and the Commission rules.

9. Applicant requests that relief granted under this Application should be effective on oral order by the Commission, and Applicant hereby agrees to be bound by said oral order.

10. The undersigned certifies that copies of this Application will be served on each interested party as required by Rule 507 within seven (7) days of the filing hereof, as required by Rule 503.e.

WHEREFORE, Applicant respectfully requests that this matter be set for hearing, that notice be given as required by law and that upon such hearing, the Commission enter its order:

A. Pooling all interests in WSU No. 1 established for the Application Lands, for the development and operation of the Codell Formation, effective as of the earlier of the date of this Application, or the date that the costs specified in §34-60-116(7)(b), C.R.S. are first incurred for the drilling of the Subject Well within WSU No. 1.

B. Providing that the interests of any owners with whom the Applicant has been unable to secure a lease or other agreement to participate in the drilling of the Subject Well, are made subject to the cost recovery provisions of §34-60-116(7), C.R.S., effective as of the earlier of the date of the Application, or the date the costs specified in §34-60-116(7)(b), C.R.S. are first incurred for the drilling of the Subject Well.

C. For such other findings and orders as the Commission may deem proper or advisable in the premises.

DATED this 12<sup>th</sup> day of April, 2018

Respectfully submitted,

EXTRACTION OIL & GAS INC.

By: Jobediah J. Rittenhouse

Jillian Fulcher

James P. Parrot

Jobediah J. Rittenhouse

Beatty & Wozniak, P.C.

Attorneys for Applicant

216 16th Street, Suite 1100

Denver, Colorado 80202

(303) 407-4499

jfulcher@bwenergylaw.com

jparrot@bwenergylaw.com

jrittenhouse@bwenergylaw.com

Applicant's Address:  
Extraction Oil & Gas Inc.  
ATTN: Jason Rayburn  
370 17th Street, Suite 5300  
Denver, CO 80202

**VERIFICATION**

STATE OF COLORADO                    )  
  ) ss.  
CITY & COUNTY OF DENVER         )

Annie Pierini, Landman for Extraction Oil & Gas Inc., upon oath deposes and says that she has read the foregoing Amended Application and that the statements contained therein are true to the best of her knowledge, information and belief.

EXTRACTION OIL & GAS INC.

  
\_\_\_\_\_  
Annie Pierini

Subscribed and sworn to before me this 12<sup>th</sup> day of April, 2018, by Annie Pierini, Landman for Extraction Oil & Gas Inc.

Witness my hand and official seal.

My commission expires: 1/25/22

  
\_\_\_\_\_  
Notary Public

HALEY ZEPESKI  
NOTARY PUBLIC  
STATE OF COLORADO  
NOTARY ID 20184004172  
MY COMMISSION EXPIRES JAN 25, 2022

**EXHIBIT A**

Reference Map for Pooling Application

Township 4 North, Range 68 West, 6<sup>th</sup> P.M.

Section 18: SW $\frac{1}{4}$ SE $\frac{1}{4}$ ; S $\frac{1}{2}$ SW $\frac{1}{4}$

Section 19: N $\frac{1}{2}$ NW $\frac{1}{4}$ ; NW $\frac{1}{4}$ NE $\frac{1}{4}$

Weld County, Colorado

Township 4 North, Range 69 West, 6<sup>th</sup> P.M.

Section 13: S $\frac{1}{2}$ S $\frac{1}{2}$

Section 24: N $\frac{1}{2}$ N $\frac{1}{2}$

Larimer County, Colorado

***Wellbore Spacing Unit ("WSU") No. 1***

560 acres, more or less

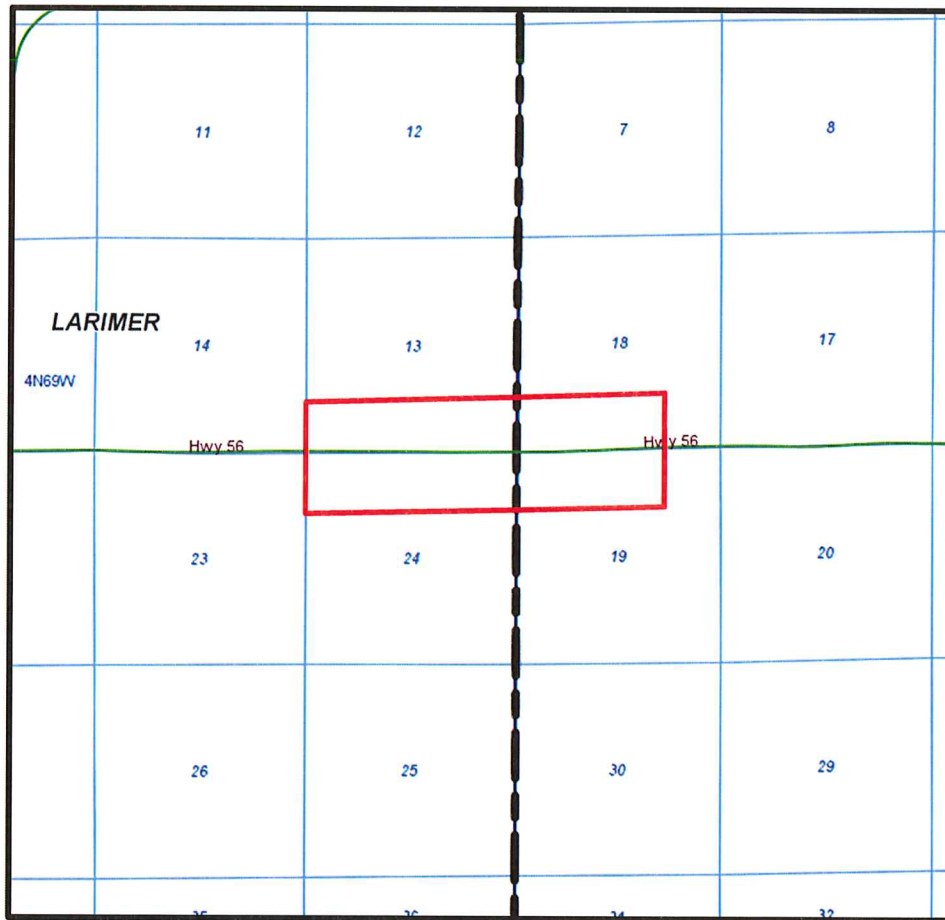

 = Application Lands



## EXHIBIT A

### INTERESTED PARTIES

The names and addresses of the interested parties (persons who own any interest in the mineral estate of the tracts to be pooled, except owners of overriding royalty interest) according to the information and belief of the Applicant are set forth in this Exhibit A.

AARON D. FRISON AND VIRGINIA A. FRISON,  
JOINT TENANTS  
150 E. TURNER AVE.  
BERTHOUD, CO 80513

ALAN E. NICHOLS AND SHEREE NICHOLS,  
JOINT TENANTS  
620 MOUNT MASSIVE ST.  
BERTHOUD, CO 80513

ALEXANDER STALEY AND MEGAN STALEY,  
JOINT TENANTS  
525 MOUNT MASSIVE ST.  
BERTHOUD, CO 80513

BETH J. RAYON  
145 RED CLOUD AVE.  
BERTHOUD, CO 80513

BILLY DEAN WAGNER  
205 REDCLOUD AVE.  
BERTHOUD, CO 80513

BRETT H. MCMURRY AND SHARI L.  
MCMURRY, JOINT TENANTS  
840 PYRAMID PEAK ST  
BERTHOUD, CO 80513

CHARLES D. CARLSON  
312 E COUNTY ROAD 8  
BERTHOUD, CO 80513

CHRISTINE C. GRAY  
560 WINDOM PEAK LN.  
BERTHOUD, CO 80513

CHRISTOPHER M. BUCKRIDGE  
665 TORREYS PEAK LN.  
BERTHOUD, CO 80513

CLIFFORD M. ALPS  
5430 STRAIN VRAIN ROAD  
LONGMONT, CO 80503

CYNTHIA L. CARLSON  
312 E COUNTY ROAD 8  
BERTHOUD, CO 80513

DACK J. COUSINO AND JENNIFER COUSINO,  
JOINT TENANTS  
760 GRAYS PEAK LN.

BERTHOUD, CO 80513

DAVID ASHLEY STEPP  
3800 PIKE RD UNIT 26-204  
LONGMONT, CO 80503

DAVID MURRAY AND DONNA MURRAY, JOINT  
TENANTS  
545 MOUNT MASSIVE ST  
BERTHOUD, CO 80513

DENNIS DOSTAL AND CHRISTINE DOSTAL,  
JOINT TENANTS  
735 MT. MASSIVE ST.  
BERTHOUD, CO 80513

DIANE M. STILWILL AND PATRICK A. STILWILL,  
JOINT TENANTS  
660 TORREYS PEAK LN.  
BERTHOUD, CO 80513

DOUGLAS R. PENNOCK & LINDA M.  
PENNEOC, SUCCESSOR CO-TRUSTEES OF  
THE PHILLIP R. PENNOCK, JR. TRUST  
329 E. STATE HIGHWAY 56  
BERTHOUD, CO 80513

EARL NICHOLS AND KAREN NICHOLS, JOINT  
TENANTS  
790 GRAYS PEAK LN.  
BERTHOUD, CO 80513

ERIC FALLDIN AND JILL FALLDIN, JOINT  
TENANTS  
640 MOUNT MASSIVE ST.  
BERTHOUD, CO 80513

ERIN K. CONLON  
483 HWY 56  
BERTHOUD, CO 80513

GARY LEE GARRISON AND MARY J.  
GARRISON, JOINT TENANTS  
855 PYRAMID PEAK ST  
BERTHOUD, CO 80513

GEORGE BROOKS ESPINOZA  
765 GRAYS PEAK LN.  
BERTHOUD, CO 80513

HPA BORROWER 2016-2 LLC

180 N STETSON AVE STE 3650  
CHICAGO, IL 0

JEFF WICKS AND KELLI WICKS, JOINT  
TENANTS  
580 MOUNT MASSIVE ST  
BERTHOUD, CO 80513

JEREMY L. MARKEY  
830 HUMBOLDT PEAK LN  
BERTHOUD, CO 80513

JESSE F. ORNELAS AND KIMBERLY D. EVANS-  
ORNELAS, JOINT TENANTS  
880 PYRAMID PEAK ST.  
BERTHOUD, CO 80513

JOHN DAY AND JANELLE DAY  
624 E. COUNTY ROAD 8  
BERTHOUD, CO 80513

JOHNSON FAMILY TRUST  
890 HUMBOLDT PEAK LN  
BERTHOUD, CO 80513

KARLA D. HIGGS  
835 PYRAMID PEAK ST  
BERTHOUD, CO 80513

KOOLSTRA-FISKE, LLLP  
433 SW 16  
LOVELAND, CO 80537

KURT ALBERS AND URSULA ALBERS, JOINT  
TENANTS  
165 QUANDARY AVE  
BERTHOUD, CO 80513

LARRY D. PYGOTT AND PAMELA A. PYGOTT  
175 QUANDRY AVE.  
BERTHOUD, CO 80513

LEONA KAY METCALFE  
1005 S.W. 22ND ST.  
LOVELAND, CO 80537

LESTER B. THORNE SR. AND KAREN C.  
THORNE, JOINT TENANTS  
625 PYRAMID PEAK ST.  
BERTHOUD, CO 80513

LINDA M. SMOKE  
716 COUNTY ROAD 8  
LOVELAND, CO 80537

LISA ANNE PLANTE-KELLY  
685 PYRAMID PEAK ST.  
BERTHOUD, CO 80513

LORENZO MANRIQUEZ AND MARIA N.,  
MANRIQUEZ, JOINT TENANTS  
585 MOUNT MASSIVE ST.

BERTHOUD, CO 80513

MARIA G. HEGAN  
680 MOUNT MASSIVE ST.  
BERTHOUD, CO 80513

MARTA LOACHAMIN  
620 PYRAMID PEAK ST.  
BERTHOUD, CO 80513

MELVIN L. LYNCH  
780 MOUNT MASSIVE ST  
BERTHOUD, CO 80513

MICHAEL J. MILLER AND TAMI R. MILLER,  
JOINT TENANTS  
902 E COUNTY ROAD 8  
BERTHOUD, CO 80513

MICHAEL T. COOK AND MARILYN P. COOK,  
JOINT TENANTS  
970 E. COUNTY ROAD 8  
BERTHOUD, CO 80513

PEAKVIEW HOMES, INC.  
845 PYRAMID PEAK ST  
BERTHOUD, CO 80513

PEAKVIEW MEADOWS SECOND OWNERS  
ASSOCIATION, INC.  
446 E. 4TH ST.  
LOVELAND, CO 80537

RACHEL A. REESE AND GARRETT M. REESE,  
JOINT TENANTS  
645 TORREYS PEAK LN.  
BERTHOUD, CO 80513

REGINA A. CHAVES AND MARK L. CHAVES,  
JOINT TENANTS  
660 PYRAMID PEAK ST.  
BERTHOUD, CO 80513

RICH BODDY  
830 PYRAMID PEAK ST  
BERTHOUD, CO 80513

RONALD T. BALDRIDGE AND TERRI R. S.  
BALDRIDGE, JOINT TENANTS  
215 REDCLOUD AVE.  
BERTHOUD, CO 80513

RYAN SHEETS  
860 PYRAMID PEAK ST  
BERTHOUD, CO 80513

SCOTT D. TAYLOR AND KAREN LYNNE  
TAYLOR, JOINT TENANTS  
895 PYRAMID PEAK ST.  
BERTHOUD, CO 80513

SHEILA A. HABERKON



165 REDCLOUD AVE  
BERTHOUD, CO 80513

SILVER STREAM CONSTRUCTION, INC.  
660 MOUNT MASSIVE ST.  
BERTHOUD, CO 80513

STEVEN E. COSEO AND GLADYS F. COSEO,  
JOINT TENANTS  
105 QUANDARY AVE.  
BERTHOUD, CO 80513

THE DAVIS FAMILY TRUST, EDWARD M.  
DAVIS AND SUSAN M. DAVIS, TRUSTEES,  
DATED OCTOBER 23, 2015  
11346 LEWISTOWN STREET  
COMMERCE CITY, CO 80022

THEODORE A. BURLESON AND TRACI L.  
BURLESON, JOINT TENANTS  
870 MOUNT MASSIVE ST.  
BERTHOUD, CO 80513

TIM PRICE AND HELENE PRONK, JOINT  
TENANTS  
890 MT. MASSIVE ST.  
BERTHOUD, CO 80513

TIMOTHY ROBERT SMITH AND AMY SMITH,  
JOINT TENANTS  
775 GRAYS PEAK LN  
BERTHOUD, CO 80513

TOM LATINA  
155 REDCLOUD AVE  
BERTHOUD, CO 80513

TRAIK R. KYLLO AND SHANNON M. KYLLO,  
JOINT TENANTS  
500 1ST ST.  
BERTHOUD, CO 80513

WILLIAM A. KOENIG AND STEPHANIE C.  
KOENIG, JOINT TENANTS  
P.O. BOX 1154  
BERTHOUD, CO 80513

WILLIAM FAGLER AND AGNES FAGLER, JOINT  
TENANTS  
428 E COUNTY ROAD 8  
BERTHOUD, CO 80513

WILLIS W. CRAMER  
RFD 1, BOX 86  
BERTHOUD, CO 80513

OLGA J. MARKHAM  
650 EAST HIGHWAY 56, POST OFFICE BOX  
424  
BERTHOUD, CO 80513

CORPORATION OF THE PRESIDING BISHOP  
OF THE CHURCH OF JESUS CHRIST OF  
LATTER DAY SAINTS, A UTAH CORPORATION  
50 EAST NORTH TEMPLE, FLOOR 12  
SALT LAKE CITY, UT 84150

THE LITTLE THOMPSON GRANGE, #454 INC. A  
COLORADO CORPORATION  
BOX 137  
BERTHOUD, CO 80513

R. BRUCE FICKEL II  
PO BOX S  
BERTHOUD, CO 80513

AARON JAMES LASKO AND CHRISTINE YI  
LASKO, AS JOINT TENANTS  
103 E. INDIANA AVENUE  
BERTHOUD, CO 80513

TREVOR G. FARNAM AND TONYA C. FARNAM,  
AS JOINT TENANTS  
107 E. INDIANA AVENUE  
BERTHOUD, CO 80513

MICHAEL A. PATRICK AND DIXIE D. PATRICK,  
AS JOINT TENANTS  
111 E. INDIANA AVENUE  
BERTHOUD, CO 80513

GREGORY W. ALEXANDER AND GLENNA M.  
ALEXANDER, AS JOINT TENANTS  
115 E. INDIANA AVENUE  
BERTHOUD, CO 80513

KATHRYN EASON  
202 VICTORIA STREET  
BERTHOUD, CO 80513

KRISTIN S. BENNETT  
206 VICTORIA STREET  
BERTHOUD, CO 80513

DAVID W. CLARK AND CARLYLE C. CLARK, AS  
JOINT TENANTS  
210 VICTORIA STREET  
BERTHOUD, CO 80513

JOSEPH N. LEWIS AND SANDRA LOU LEWIS  
305 HUBBELL STREET  
BERTHOUD, CO 80513

WILLIAM R. REAVEY AND MARTHA J. REAVEY,  
AS JOINT TENANTS  
302 VICTORIA STREET  
BERTHOUD, CO 80513

KATHRYN J. KENNY  
306 VICTORIA STREET  
BERTHOUD, CO 80513

MICHAEL A. STEIN AND CARLA M. STEIN, AS  
JOINT TENANTS  
310 VICTORIA STREET  
BERTHOUD, CO 80513

James Hergenreder  
1358 Trail Ridge Road  
Longmont, CO 80501

Ricky L. Parks and Karen L. Parks, as Joint  
Tenants  
3931 Sedona Hills Drive  
Loveland, CO 80537

The Zancanella Family Trust  
303 Hubbell Street  
Berthoud, CO 80513

Jerold W. Douthit and Susan K. Douthit, as Joint  
Tenants  
207 Hubbell Street  
Berthoud, CO 80513

Edith A. Resler  
203 Hubbell Street  
Berthoud, CO 80513

Gerald J. Ward and JoAnn Ward, as Joint Tenants  
100 E. Indiana Avenue  
Berthoud, CO 80513

Tracy Brekke  
207 Victoria Street  
Berthoud, CO 80513

Joel J. Werner and Renee L. Werner, as Joint  
Tenants  
307 Victoria Street  
Berthoud, CO 80513

Sharon S. Merchant and Howard E. Merchant, as  
Joint Tenants  
315 Victoria Street  
Berthoud, CO 80513

Stacey Lynn Schulte and Sarah Christine Schulte,  
as TIC  
PO Box 1083  
Berthoud, CO 80513

Maria A. Buckles  
310 Hubbell Street  
Berthoud, CO 80513

Judith Lee Roberts and Terry Alan Roberts, as  
Joint Tenants  
306 Hubbell Street  
Berthoud, CO 80513

Sara Michelle Fahrenbruch and Steven J. Wykoff,  
as Joint Tenants  
302 Hubbell Street

Berthoud, CO 80513

Rick L. Foster and Nancy Faye Davis, as Joint  
Tenants  
208 Hubbell Street  
Berthoud, CO 80513

Julie A. Kocjancic  
202 Hubbell Street  
Berthoud, CO 80513

Town of Berthoud  
PO Box 1229  
Berthoud, CO 80513

Donald A. Clover Jr. and Denise M. Clover, as  
Joint Tenants  
515 E. County Road 8  
Berthoud, CO 80513

Michelle L. Helbert  
102 E. Welch Ave.  
Berthoud, CO 80513

John D. Sommers and Karin P. Sommers, as Joint  
Tenants  
106 E. Welch Ave.  
Berthoud, CO 80513

Caleb Alan Lee and Candice Ann Lee, as Joint  
Tenants  
425 E. County Road 8  
Berthoud, CO 80513

ADAM S. ERDESKY AND MARYA C. ERDESKY,  
JOINT TENANTS  
635 MOUNT MASSIVE ST  
BERTHOUD, CO 80513

ALEXANDER MICHAELIS  
765 MT. MASSIVE ST.  
BERTHOUD, CO 80513

ARMAND V. DANFORTH AND LORRAINE C.  
DANFORTH, JOINT TENANTS  
830 MOUNT MASSIVE ST.  
BERTHOUD, CO 80513

BILLIE J. JACKSON  
875 PYRAMID PEAK STREET  
BERTHOUD, CO 80513

BRANDON DAVID HODAPP AND DANIELLE  
JOLENE HODAPP, JOINT TENANTS  
115 QUANDARY AVE.  
BERTHOUD, CO 80513

CHARLES B. JOHNSON  
155 REDCLOUD AVE.  
BERTHOUD, CO 80513

CHARLES D. CRUTCHFIELD AND  
KHWANKAMON CRUTCHFIELD, JOINT  
TENANTS  
775 PYRAMID PEAK ST.  
BERTHOUD, CO 80513

CHRISTOPHER E. RAMPONE  
585 PYRAMID PEAK ST  
BERTHOUD, CO 80513

CLAY SHARP  
580 WINDOM PEAK LN.  
BERTHOUD, CO 80513

CONSTANCE D. WALLACE  
665 MOUNT MASSIVE ST.  
BERTHOUD, CO 80513

CYNTHIA LEE ROCEK AND ROGER DONALD  
ROCEK, JOINT TENANTS  
160 E. TURNER AVE.  
BERTHOUD, CO 80513

DAVID A. BLAKE AND KAREN A. BLAKE, JOINT  
TENANTS  
640 TORREYS PEAK LN  
BERTHOUD, CO 80513

DAVID B. OVERHOLT AND DINA A. SCHEMM-  
OVERHOLT, JOINT TENANTS  
892 E. COUNTY ROAD #8  
BERTHOUD, CO 80513

DENNIS A. JEFFREY AND RAYLYNN JEFFREY,  
JOINT TENANTS  
755 MOUNT MASSIVE ST.  
BERTHOUD, CO 80513

DEREK J. OTT  
785 MOUNT MASSIVE ST.  
BERTHOUD, CO 80513

DOUGLAS D. DIETZ  
140 E TURNER AVE  
BERTHOUD, CO 80513

DUSTIN KNAPP AND SARAH KNAPP, JOINT  
TENANTS  
745 MOUNT MASSIVE ST.  
BERTHOUD, CO 80513

EDMUND DAVID MONAK  
545 PYRAMIND PEAK ST.  
BERTHOUD, CO 80513

ERIC T. CLARK AND LARISSA E. CLARK, JOINT  
TENANTS  
545 WINDOM PEAK LN.  
BERTHOUD, CO 80513

GARY L. BOUGHTON AND JEANNE D.  
BOUGHTON, JOINT TENANTS

520 WINDOM PEAK LN.  
BERTHOUD, CO 80513

GEORGE ACKERMAN AND JOSHUA  
ACKERMAN, JOINT TENANTS  
180 E. TURNER AVE.  
BERTHOUD, CO 80513

HECKEL CONSTRUCTION, LLC  
2046 PARK DR  
LOVELAND, CO 80538

JAMES C. DOYLE AND CECILIA JAMIESON,  
JOINT TENANTS  
620 TORREYS PEAK LN  
BERTHOUD, CO 80513

JEFFREY M. LARSON AND NINA M. LARSON,  
JOINT TENANTS  
895 HUMBOLDT PEAK LANE  
BERTHOUD, CO 80513

JEREMY R. GERK AND JAMIE K. GERK, JOINT  
TENANTS  
565 PYRAMID PEAK ST.  
BERTHOUD, CO 80513

JESUS E. CERECERES  
875 MOUNT MASSIVE ST.  
BERTHOUD, CO 80513

JOHN HATTEN AND SUZANNE HATTON, JOINT  
TENANTS  
135 QUANDARY AVE  
BERTHOUD, CO 80513

JOY E. WOODRUFF  
840 MOUNT MASSIVE ST.  
BERTHOUD, CO 80513

KIM WIECK AND CHRIS WIECK, JOINT  
TENANTS  
580 PYRAMID PEAK ST.  
BERTHOUD, CO 80513

KRISTI BODDY  
830 PYRAMID PEAK ST  
BERTHOUD, CO 80513

KYLE GLENDON TILLEY  
775 MOUNT MASSIVE ST.  
BERTHOUD, CO 80513

LEE H. ROBINSON AND FRANCELLE  
ROBINSON, JOINT TENANTS  
1213 #A HIGHWAY 70  
SAVERY, WY 82332

LEROY BOUDREAU AND ROSANNE R.  
BOUDREAU, JOINT TENANTS  
520 PYRAMID PEAK ST  
BERTHOUD, CO 80513

LINCOLN ENERGY PARTNERS II, LLC  
852 BROADWAY AVE, SUITE 300  
DENVER, CO 80203

LINDA R. ARMOUR AND ROSS W. ARMOUR,  
JOINT TENANTS  
804 EAST COUNTY ROAD 8  
BERTHOUD, CO 80513

LISA J. SPITZ  
205 QUANDARY AVE  
BERTHOUD, CO 80513

LUCAS B. CAUDILL AND STEPHANIE M.  
CAUDILL, JOINT TENANTS  
685 MOUNT MASSIVE ST  
BERTHOUD, CO 80513

MARSHA K. GROTH  
145 REDCLOUD AVE  
BERTHOUD, CO 80513

MATTHEW KENT VANDER WALL AND EMILY  
CHRISTINE VANDER WALL, JOINT TENANTS  
120 E TURNER AVE  
BERTHOUD, CO 80513

MICHAEL B. HUSS AND MISTY A. HUSS, JOINT  
TENANTS  
780 GRAYS PEAK LN.  
BERTHOUD, CO 80513

MICHAEL JAY COPPLE AND ANDRIA L.  
COPPLE, JOINT TENANTS  
785 GRAYS PEAK LN  
BERTHOUD, CO 80513

ORVAL L. GATES AND MURIEL P. GATES,  
JOINT TENANTS  
2421 FLORA DR  
LOVELAND, CO 80537

PEAKVIEW MEADOWS OWNERS  
ASSOCIATION, INC.  
845 PYRAMID PEAK ST  
BERTHOUD, CO 80513

PHILIP COULIMORE AND TERRY KIEFFER-  
COULIMORE, JOINT TENANTS  
PO BOX 7  
BERTHOUD, CO 80513

RALPH DRAKE AND JULIANNE L. DRAKE,  
JOINT TENANTS  
870 HUMBOLDT PEAK LN.  
BERTHOUD, CO 80513

RENA HUTCHINSON  
125 QUANDARY AVE  
BERTHOUD, CO 80513

RONALD FLAMION AND KATHIE FLAMION,  
JOINT TENANTS  
525 WINDOM PEAK LN  
BERTHOUD, CO 80513

RONNIE R. HILL  
870 PYRAMID PEAK LN.  
BERTHOUD, CO 80513

SARA RAVER  
PO BOX 1692  
BERTHOUD, CO 80513

SCOTT J. KIRK AND CYNTHIA H. KIRK, JOINT  
TENANTS  
765 PYRAMID PEAK ST  
BERTHOUD, CO 80513

SHROUT FAMILY INVESTMENTS, LLC  
801 GILLASPIE DR APT 102  
BOULDER, CO 80305

STEPHEN L. DAY  
618 E. COUNTY ROAD 8  
BERTHOUD, CO 80513

SUSAN H. JANKE  
860 MOUNT MASSIVE ST  
BERTHOUD, CO 80513

THE JONES TRUST UDT JUNE 2, 1990  
175 REDCLOUD AVE  
BERTHOUD, CO 80513

THOMAS W. WRIGHT AND JUDITH G. WRIGHT,  
JOINT TENANTS  
850 HUMBOLDT PEAK LN.  
BERTHOUD, CO 80513

TIMOTHY L. AMBROSE AND JILL M. AMBROSE,  
JOINT TENANTS  
795 GRAYS PEAK LN  
BERTHOUD, CO 80513

TODD L. GABRIEL AND MARIA L. GABRIEL,  
JOINT TENANTS  
845 PYRAMID PEAK ST.  
BERTHOUD, CO 80513

TOWN OF BERTHOUD, COLORADO  
P.O. BOX 1229  
BERTHOUD, CO 80513

TYLER SCHLAGEL AND ARIKA L. SCHLAGEL,  
JOINT TENANTS  
145 QUANDARY AVE.  
BERTHOUD, CO 80513

WILLIAM DOMBROWSKI, WILLIAM EDWARD  
DOMBROWSKI AND SHERYL LYNN  
DOMBROWSKI, JOINT TENANTS  
812 E. COUNTY ROAD 8

BERTHOUD, CO 80513

WILLIAM H. MONCRIEF AND SHARON M.  
MONCRIEF, JOINT TENANTS  
541 WINTERBERRY WAY  
SAN JOSE, CA 95129

OLGA J. MARKHAM, AS PERSONAL  
REPRESENTATIVE OF THE ESTATE OF  
HARVEY R. MARKHAM, SR., DECEASED  
650 EAST HIGHWAY 56, POST OFFICE BOX  
424  
BERTHOUD, CO 80513

JASON ALAN MILLS AND MINDY JILL MILLS, JT  
642 HANGIS COURT  
BERTHOUD, CO 80513

MANLEY R. NELSON, DECEASED  
20441 WCR 3  
BERTHOUD, CO 80513

CHARLES R. LEEPER JR. AND TANYA M.  
LEEPER, AS JOINT TENANTS  
101 E. INDIANA AVENUE  
BERTHOUD, CO 80513

JANEEN L. BARRETT AND EDWARD E.  
BARRETT, AS JOINT TENANTS  
105 E. INDIANA AVENUE  
BERTHOUD, CO 80513

SHELLY BOEDEKER  
109 E. INDIANA AVENUE  
BERTHOUD, CO 80513

RICHARD L. HALL AND CLARICE M. HALL, AS  
JOINT TENANTS  
113 E. INDIANA AVENUE  
BERTHOUD, CO 80513

JAMES E. TUNNICLIFF AND W. LORELLE  
TUNNICLIFF, AS JOINT TENANTS  
200 VICTORIA STREET  
BERTHOUD, CO 80513

SIMON H. DAMBERGER, HEINZ H.  
DAMBERGER, AND MARIA L. DAMBERGER, AS  
JOINT TENANTS  
204 VICTORIA STREET  
BERTHOUD, CO 80513

ROBERT R. PITMON AND JOAN L. PITMON, AS  
JOINT TENANTS  
208 VICTORIA STREET  
BERTHOUD, CO 80513

RONNIE EDWARDS AND ELLEN EDWARDS,  
AS JOINT TENANTS  
212 VICTORIA STREET  
BERTHOUD, CO 80513

M. YVETTE BERNDT AND MANFRED BERNDT  
300 VICTORIA STREET  
BERTHOUD, CO 80513

ARTHUR JOHN VANDERZEE  
4300 BEAVER HOLLOW SE  
CEDAR RAPIDS, IA 52404

ARLEEN JANE CORBETT  
308 VICTORIA STREET  
BERTHOUD, CO 80513

THE DAVIS FAMILY TRUST DATED OCTOBER  
23, 2015 EDWARD M. DAVIS AND SUSAN M.  
DAVIS, TRUSTEES  
11346 LEWISTOWN STREET  
COMMERCE CITY, CO 80022

Pamela G. Worster Trust U/A 8-08-05 Pamela G.  
Worster, Trustee  
PO Box 1174  
Berthoud, CO 80513

Sandra Lou Lewis, Joseph N. Lewis, and Shauna  
c. Brekke, as Joint Tenants  
305 Hubbell Street  
Berthoud, CO 80513

Ronald R. Ormsbee and Lois L. Ormsbee, as Joint  
Tenants  
301 Hubbell Street  
Berthoud, CO 80513

Lynn A. Larsen and Bette Jeanne Larsen, as Joint  
Tenants  
205 Hubbell Street  
Berthoud, CO 80513

Monica S. Signer and David M. Signer, as Joint  
Tenants  
201 Hubbell Street  
Berthoud, CO 80513

Bonnie E. Glass  
104 E. Indiana Avenue  
Berthoud, CO 80513

Leonard E. Carter and Emily Diane Carter  
213 Victoria Street  
Berthoud, CO 80513

Thomas M. Wickman  
3795 Panther Drive  
Loveland, CO 80537

Diane Brotemarkle  
101 E. Welch Avenue  
Berthoud, CO 80513

James J. Hinshaw and Janice K. Hinshaw, as  
Joint Tenants  
105 E. Welch Avenue

Berthoud, CO 80513

Harold E. Hall and Elizabeth A. Hall, as Joint  
Tenants  
308 Hubbell Street  
Berthoud, CO 80513

The Fry Family Trust dated June 2, 2004  
304 Hubbell Street  
Berthoud, CO 80513

Jeffery S. Postek  
300 Hubbell Street  
Berthoud, CO 80513

Joann Juskie  
204 Hubbell Street  
Berthoud, CO 80513

Jane F. King  
200 Hubbell Street  
Berthoud, CO 80513

Mark Chaffe  
444 1st Avenue  
Berthoud, CO 80513

Jarron M. Erker and Bethany H. Erker, as Joint  
Tenants  
100 E. Welch Ave.  
Berthoud, CO 80513

Shawn P. Smith and Thanh K. Vo-Smith, as Joint  
Tenants  
104 E. Welch Ave.  
Berthoud, CO 80513

Fannie Mae, a.k.a. Federal National Mortgage  
Association organized and existing under the laws  
of the United States of America  
13455 Noel Road, Suite 600  
Dallas, TX 75240

Julie A. Hanscome Living Trust  
525 East County Road 8  
Berthoud, CO 80513

**BEFORE THE OIL AND GAS CONSERVATION COMMISSION  
OF THE STATE OF COLORADO**

IN THE MATTER OF AN APPLICATION BY  
EXTRACTION OIL & GAS INC. FOR AN ORDER  
POOLING ALL INTERESTS IN AN APPROXIMATE CAUSE NO. 407  
560-ACRE DESIGNATED HORIZONTAL DOCKET NO. 180600445  
WELLBORE SPACING UNIT FOR CERTAIN  
PORTIONS OF SECTIONS 18 AND 19, TOWNSHIP TYPE: POOLING  
4 NORTH, RANGE 68 WEST, 6TH P.M. AND  
CERTAIN PORTIONS OF SECTIONS 13 AND 24,  
TOWNSHIP 4 NORTH, RANGE 69 WEST, 6TH  
P.M., FOR THE DEVELOPMENT/OPERATION OF  
THE CODELL FORMATION, WATTENBERG  
FIELD, LARIMER AND WELD COUNTIES,  
COLORADO

**SUPPLEMENTAL AFFIDAVIT OF MAILING**

STATE OF COLORADO                    )  
  ) ss.  
CITY AND COUNTY OF DENVER        )

Jo Cooks, of lawful age, and being first duly sworn upon her oath, states and declares:

That she is a Legal Assistant at Beatty & Wozniak, P.C., attorneys for Extraction Oil and Gas, and on 19th day of April, caused a copy of the above captioned Application to be deposited in the United States Mail, postage prepaid, addressed to following.

MANLEY R. NELSON, DECEASED  
911 S. COLUMBINE ST.  
DENVER, CO 80209

  
\_\_\_\_\_  
Jo Cooks

Subscribed and sworn to before me this 19th day of April, 2018.

Witness my hand and official seal.

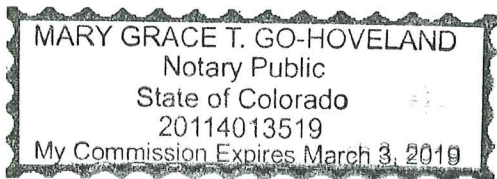

  
\_\_\_\_\_  
Notary Public