

BEFORE THE OIL AND GAS CONSERVATION COMMISSION
OF THE STATE OF COLORADO

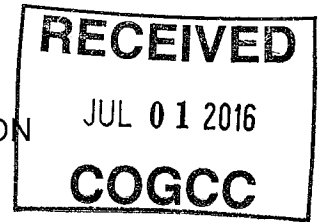

IN THE MATTER OF THE APPLICATION OF)
EXTRACTION OIL & GAS, LLC FOR AN)
ORDER POOLING ALL INTERESTS IN THE)
CODELL AND NIOBRARA FORMATIONS IN)
THREE 560-ACRE WELLBORE SPACING)
UNITS COVERING CERTAIN LANDS IN)
SECTIONS 16 AND 17, TOWNSHIP 5 NORTH,)
RANGE 65 WEST, 6TH P.M., WATTENBERG)
FIELD, WELD COUNTY, COLORADO.)

Cause No. 407
Docket No. 160800327
Type: POOLING

APPLICATION

Extraction Oil & Gas, LLC ("Extraction" or "Applicant"), Operator No. 10459, by its attorneys, Welborn Sullivan Meck & Tooley, P.C., respectfully submits this Application to the Oil and Gas Conservation Commission of the State of Colorado ("Commission" or "COGCC") for an order pooling all interests in three approximate 560-acre wellbore spacing units ("WSU") established for the S $\frac{1}{2}$ N $\frac{1}{2}$, N $\frac{1}{2}$ S $\frac{1}{2}$ of Section 16 and the SE $\frac{1}{4}$ NW $\frac{1}{4}$, NE $\frac{1}{4}$ SW $\frac{1}{4}$, S $\frac{1}{2}$ NE $\frac{1}{4}$, N $\frac{1}{2}$ SE $\frac{1}{4}$ of Section 17, Township 5 North, Range 65 West, 6th P.M., Weld County, Colorado for the development and production of oil, gas and associated hydrocarbons from the Cdell Formation in WSU No. 2 and the Niobrara Formation in WSU Nos. 1 and 3. In support thereof, the Applicant states as follows:

1. Applicant is a limited liability company duly authorized to conduct business in the State of Colorado.
2. Applicant owns a leasehold interest in the following lands ("Application Lands"):

Township 5 North, Range 65 West, 6th P.M.
Section 16: S $\frac{1}{2}$ N $\frac{1}{2}$, N $\frac{1}{2}$ S $\frac{1}{2}$
Section 17: SE $\frac{1}{4}$ NW $\frac{1}{4}$, NE $\frac{1}{4}$ SW $\frac{1}{4}$, S $\frac{1}{2}$ NE $\frac{1}{4}$, N $\frac{1}{2}$ SE $\frac{1}{4}$

Weld County, Colorado.

A reference map of the Application Lands is attached hereto.

1. Rule 318A.a.(4)D. provides, in relevant part, that where a drilling and spacing unit does not exist for a horizontal well, the horizontal wellbore spacing unit shall be comprised of the governmental quarter-quarter sections in which the wellbore lateral penetrates the productive formation as well as any governmental quarter-quarter sections that are located less than four hundred sixty (460) feet from the portion of the wellbore lateral that penetrates the productive zone

regardless of section or quarter section lines. Rule 318A.a.(4)D. further provides that a horizontal wellbore spacing unit may overlap portions of another horizontal wellbore spacing unit or other wellbore spacing unit designated in accordance with subsection a.(4)C. The Application Lands are subject to this Rule.

2. Applicant plans to drill and complete the following wells in individual wellbore spacing units covering the Application Lands in the corresponding formation:

- a. **WSU No. 1:** Vetting 12 well (API No. Pending). Estimated spud date second quarter 2016. Located 2,003 feet FNL and 496 feet FWL, Section 15, Township 5 North, Range 65 West, 6th P.M. to produce oil, gas and associated hydrocarbons from the Niobrara Formation;
- b. **WSU No. 2:** Vetting 13 well (API No. Pending). Estimated spud date second quarter 2016. Located 2,000 feet FNL and 520 feet FWL, Section 15, Township 5 North, Range 65 West, 6th P.M. to produce oil, gas and associated hydrocarbons from the Codell Formation; and
- c. **WSU No. 3:** Vetting 14 well (API No. Pending). Estimated spud date second quarter 2016. Located 1,997 feet FNL and 544 feet FWL, Section 15, Township 5 North, Range 65 West, 6th P.M. to produce oil, gas and associated hydrocarbons from the Niobrara Formation.

Hereinafter, the "Wells."

3. Pursuant to the relevant provisions of Section 34-60-116(6) & (7), C.R.S., and COGCC Rule 530, Applicant seeks an order pooling all interests in the Application Lands for the development and operation of the Codell Formation in WSU No. 2 and the Niobrara Formation in WSU Nos. 1 and 3.

4. Applicant certifies that, at least thirty-five (35) days prior to the date of the scheduled protest deadline for this Application, each owner which Applicant was able to locate, not already leased or voluntarily pooled, will be provided with the well proposals and information required by Rule 530 and tendered a reasonable offer to lease (if an unleased mineral owner), or participate and bear costs associated with the drilling and completion of the Wells.

5. Applicant requests that a pooling order be entered as a result of this Application and that it be made effective as of the earlier of the date of this Application, or the date costs specified in Section 34-60-116(7)(b)(II), C.R.S., are first incurred for the drilling of the wells the Codell Formation in WSU No. 2 and the Niobrara Formation in WSU Nos. 1 and 3.

6. The granting of this Application would be in accord with the Oil and Gas Conservation Act, found at Section 34-60-101, *et seq.*, C.R.S., and Commission rules.

7. The names and addresses of the interested parties (persons who own an interest in the mineral estate of the tracts to be pooled, except owners of overriding royalty interest) are attached hereto and marked Exhibit A. Applicant certifies that copies of this Application will be

served on all locatable interested parties within seven (7) days of the date hereof, as required by Commission Rule 507.b.(2), and that at least thirty-five (35) days prior to the date of the scheduled protest deadline for this Application, each such owner not already leased or voluntarily pooled will be offered the opportunity to lease, or to participate in the drilling of the Wells, and will be provided with the information required by Rule 530.

WHEREFORE, Applicant respectfully requests that this matter be set for hearing, that notice be given as required by law and that upon such hearing this Commission enter its order:

A. Pooling all interests in the Application Lands for the development and operation of the Codell Formation in WSU No. 2 and the Niobrara Formation in WSU Nos. 1 and 3.

B. Providing that the pooling order is made effective as of the date of this Application, or the date that the costs specified in Section 34-60-116(7)(b)(II), C.R.S., are first incurred for the drilling of a well in the Codell Formation in WSU No. 2 and the Niobrara Formation in WSU Nos. 1 and 3 on the Application Lands, whichever is earlier;

C. Providing that the interests of any owners, with whom the Applicant has been unable to secure a lease or other agreement to participate in the drilling of the authorized wells, are pooled by operation of statute, pursuant to Section 34-60-116(7), C.R.S., and made subject to the cost recovery provisions thereof;

D. For such other findings and orders as the Commission may deem proper or advisable in the premises.

Dated this 30th day of June, 2016

Respectfully submitted,
WELBORN SULLIVAN MECK & TOOLEY, P.C.

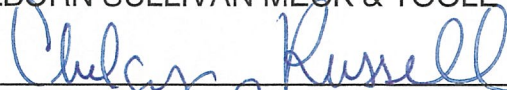
By:  _____

Joseph C. Pierzchala
Chelsey J. Russell
Welborn Sullivan Meck & Tooley, P.C.
Attorney for Applicant
1125 - 17th Street, Suite 2200
Denver, CO 80202
303-830-2500
jpierzchala@wsmtlaw.com
crussell@wsmtlaw.com

Applicant's Address:

370 17th Street, Suite 5400
Denver, CO 80202
Attn: Drew Stout, Landman
Phone: 720-557-8325

VERIFICATION

STATE OF COLORADO)
) ss.
CITY & COUNTY OF DENVER)

Drew Stout, Landman with Extraction Oil & Gas, LLC, upon oath deposes and says that he has read the foregoing Application and that the statements contained therein are true to the best of his knowledge, information and belief.

EXTRACTION OIL & GAS, LLC



Drew Stout, Landman

Subscribed and sworn to before me this 30th day of June, 2016 by Drew Stout, Landman for Extraction Oil & Gas, LLC.

Witness my hand and official seal.

MELISSA A. MORMAN
NOTARY PUBLIC
STATE OF COLORADO
NOTARY ID 19894012434
MY COMMISSION EXPIRES AUGUST 29, 2017

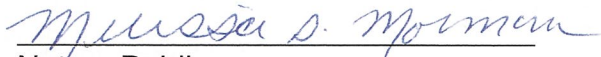

Notary Public
My Commission Expires: 8/29/2017

EXHIBIT A
VETTING NORTH

1111 E 24TH ST LLC
24TH ST PROPERTIES LLC
3 MARGARITAS XX INC
4 BY 4 LLC
4K REAL ESTATE LLC
824 24ST LLC
A & G CONCEPTS INC
AAM INVESTMENTS LLC
ABREGO MIRIAM MOTA
ACEVEDO ANA M
ACUNA ALFREDO
VILLALPANDO MOLINA-
ARMENDARIZ VILMA G
ADAME JOSE C REY
ADAME RHONDA YVETTE
ADLER PAMELA
ADRIAN O. TARIN AND LUZ
ESTELA TARIN
AFFORDABLE COMMUNITY
HOUSING
AGUERO EDWARD A
AGUILERA CANDELARIO
LOPEZ
ALBANO AMANDA L
ALBERTS CLARA
ALCUDIA-PEREZ
ANGELICA
ALIG CHRISTOPHER J
ALMANZA EDMUNDO I
ALMANZA HECTOR
GONZALEZ JUDITH
ALVAREZ JUAN E
ALVAREZ MONICA
ALVIDREZ DINO C
AMERICAN HOMES 4 RENT
PROPERTIES FIVE
ANDERSON LARRY D
ANDERSON SARAH A
Ann Toliver. (5.555556%)
ANTOMMARIA AMY
APARESO RAMIRO
ARBALLO MARTINA
ARCHABALD JOSEPH
DAVID
ARGUELLO YVONNE
ARREDONDO
ARREDONDO SARA
ARREDONDO VICTOR
MANUEL
ARREDONDO JULIANA
ARREOLA JUSTINO
ARREOLA TAYDE
ARTZ JESSICA
ASHLAND DEBRA
AVALOS JOSE R

AVILA JUAN
AVILA RAUL
B & B LOCAL
CONSTRUCTION LLC
B&B LLC
B&B LOCAL
CONSTRUCTION LLC
BAKER BECKY ANN
BAKER DONALD L
BALZER PAMELA A
BALZER TIMOTHY J
BANEY TERRIE L
Barbara Scott Moore
BARRAZA NOLBERTO
PINEDA
BARRIOS ALEJANDRO
MADERA
BARRIOS ALEJANDRO
MADERA
BARRIOS CELIA MADERA
BARRIOS OLGA
BAYSWATER BLINHEIM
HOLDINGS II, LLC
BAYSWATER
EXPLORATION AND
PRODUCTION LLC
BEATON DENNIS C
BEATON LINDA M
BECKEY RICHARD
BERNAL MARIO CEJA
Betty Marie Fay
(16.666667%)
BIG DOG ENTERPRISES
LLC
BLAKE AVENUE
PROPERTIES LLC C/O
AMY & JASON LYNCH
BLAKELEY SHARON C
BLAKELEY JOHNNY M
BLAKLEY ALAN R
BLAND ALAN W
BLAND KATHI M
BLOSZ SARA
BMC WEST CORPORATION
BOLTZ BRADLEY A
BOLTZ LAURIE ANN
BONELL GOOD
SAMARITAN CENTER
BONITA HOMES LLC
BONITA HOMES LLC
BORYS RICHARD M
BOWER KEVIN C
FODNESS JENNIFER A
BOWL FORT COLLINS LLC
BOYD YUEBO FENG

BOYS CLUB OF GREELEY
INC
BREEDEN EDWARD E
BRICENO JUAN VILLEGAS
VILLEGAS MARIA
BROWN A M
BROWN CHRIS A
BROWN THELMA M
STEEL SHARON F BROWN
STEEL JAMES
BRUCKNER TRUCK SALES,
INC.
BUENO VERONICA
BULLOCK PAYDEN LEROY
BUNI ABCILLAHL JAMA
BURNELL JIMMIE B
BUSTILLOS RAMON
BUSTILLOS ALMA
PATRICIA
BUSTILLOS RAMON
BUSTILLOS ALMA
BUTZINE CHARLES P
BUTZINE CHARLES P
BUTZINE ROSEMARY E
BUTZINE ROSEMARY E
BUXMAN LARRY D
C & D INVESTMENT CO
CABALLERO DAVID
CABALLERO SALUD
CALDERON VICTOR
CONTRERAS
CAMPBELL TERRY
CAMPBELL TARA
CANALES FELIX
CANALES MIGUEL ANGEL
CARDENAS DINO J
CARRANZA JOSE C
CARRANZA JUAN CARLOS
MEJIA
CARTER JAMIE O
CARTER KELLY L
CARTWRIGHT SHARRON L
SHULMAN JANA L
CASTRO ENRIQUE
ABUNDIS
CASTRO SAUL LOZANO
CATHOLIC CHARITIES &
COMMUNITY SERVICES
CATHOLIC CHARITIES &
COMMUNITY SERVICES
CAZARES ROSA M
CEDAR AVENUE
PROPERTIES LLC
CEMER ROBERT L
CEMER LINDA MARIE

EXHIBIT A
VETTING NORTH

CENTRAL WELD CO
WATER DISTRICT
CHARLOTTE WORSTER
(50%)
CHAVEZ ELISEO
RODRIGUEZ
ORDUNO CESAR ESPARZA
CHAVEZ LUIS
CHENOWETH CHRISTAIN
R
CHRISTOFFERSEN EDWIN
K AND DIANA S
CIRCLE CORP
CITY OF GREELEY
CLARK GENEVA A. TRUST
COLORADO CORN
ADMINISTRATIVE
COMMITTEE
COLORADO STATE LAND
BOARD
CONLEY JAMES L
CONLEY JAMES L
COOPER SHERRY LYNN
COOPER STEVE DBA
CORDOVA ERMINIO
COREAS PETRONA
NAVARRO CARLOS E
CORRALES JOAN
ANTONIO
COWAN KEITH
COX CURTIS J
COX VANESSA B
CROP PRODUCTION
SERVICES INC
CRUZ EDUARDO POZO
Crystal K. Toliver
(5.555556%)
CUNNINGHAM CHRISTIE L
CURRIE & WALKER LLC
DAILY DAN M
DANNAR JUDY L
DE LA CRUZ SOFIA
DEEP BLUE L P
DELGADO OLIVA
DEMURONO PROPERTIES
LLC
DESANTIAGO JUAN
DIAZ ARGELIA
DIAZ J MARTIN
DIETZ WILLIAM F
DIETZ WILLMA J
DOLLARD LINNEA S
DOLLARD ROBERT G
DOMINGUEZ ILDEFONSA
DONOHOUE TAMARA S

DONOHOUE PATRICK
DORMAN DUANE R
DORMAN JENNIFER M
DOUGLAS C UYEMURA
DOROTHY Y UYEMURA
(0%)
DOWNING MARISE R
DOWNING MARY V
DOWNS DARIN R
DOWNS ROSE L
DVORAK NEAL
E SPEAR INVESTMENTS
LLC
E.S.K LLC
EAST MEADOWS
ASSOCIATION INC
ECKSTROM JENNIFER
CAPOCCIONI MARY
HOFFMANN JACOB
Edwin Gow
Paul N. Gow
Midori Gow (50%)
Edwin K Christoffersen;
Diana S Christoffersen
EL BANDIDO NIGHT CLUB
LLC
EL RICK INVESTMENTS
LLC
ELLIOTT WANETA R
ELLSWORTH CLARA L
END-IRA INC FBO FBO
JEREMY LEWCHUK IRA
EQUITY ASSOCIATES
LIMITED
ERICKSON DANA R (50%)
ERICKSON TRACY ANNE
TRUST (50%)
ESCALERA RUBEN
ESCOBAR ALEX
ESPINOZA LORENZO
MENDOZA MARIA JESUS
ESPINOZA TITO
ESTRADA MEDALIA
EVANGELICAL LUTHERAN
GOOD SAMARITAN
EZ STORAGE LLC
F & H HOLDINGS LLC
F & S PETROLEUM INC
F&H HOLDINGS LLC
FALCONER SYLVIA A
FAMILY FABRICARE LLC
FARRINGTON CHILDREN'S
TRUST
FARRINGTON PATRICIA H
TRUST

FARRINGTON WALTER L III
FARRINGTON WALTER L
JR
FERGUSON BARBARA J
FERGUSON JAMES A
FERNANDEZ ENRIQUE
FERNANDO ANGELA
FEUERSTEIN JOHN E
FINLEY LLOYD
FIRST FARM BANK
FOOTE DAVID L
FORD DEREK M
FORD JENNIFER DANIELLE
FORSYTHE W H AND
CAREN S
FOSTER MARC D
FOX JUSTIN
FRANKLIN CHARLES W
FRASER JOHN (60% INT)
FRESNILLA TIMOTHY J
FRESNILLA RAMONA L
FRIAS BERNARDO
HERNANDEZ SOPHIA
FRICK ROBERT L
FRICK LORETTA J
GALICIA AMY JO
GALICIA GABRIEL
GALLEGOS VINCENTE
GALLEGOS LISA
GARAY PORTILLO ISAIAS
GARCIA ADRIANA
GARCIA CONNIE DIANE
GARCIA ELIAS I
GARCIA ENRIQUE PARRA
PARRA MARIA D
GARCIA MARIA VENANCIA
GARCIA MARTIN
GARCIA RAFAEL HERRERA
GARCIA SONYA RIOS
GARCIA LAZARO H
GARDEA EDGAR
GARDEN CITY
ENTERTAINMENT INC
GASTON KARRIE J
Geroge Sperry (12.50%)
GERRISH CARRIE L
GILBERT PAUL M
GILBERT DAWN L
GILBERT REBECCA
GOMEZ ALEJANDRO
RODRIGUEZ
GOMEZ MARIA C GUZMAN
GOMEZ ROBERTO
GONZALES DANIEL
THOMAS

EXHIBIT A
VETTING NORTH

GONZALEZ CRISELDO
GONZALEZ-CASTANON
JOSE MANUEL
GONZALEZ CASTANON
MARIA GUADALUPE
GOOD SAMARITAN
HERITAGE COMMUNITIES
LLC
GOODMAN JOHN D TRUST
GRAHAM CARMEN
GRAJEDA OSCAR
GRAJEDA ANGELINA
GREELEY COLUMBUS
CLUB ASSOCIATION INC
GREELEY SEED REAL
ESTATE LLC
GREENE TASHA RAE
GREGORIO JOSHUA DAVID
GREGORIO CELESTINE N
Gregory J Scallon
GROOM JULIA
DIMMITT TRACY
GTA PROPERTIES LLC
GUERRERO FRANK JR
GUERRERO MARIA DIANA
GUTIERREZ HERIBERTO
HALLINAN CYNTHIA
HALLINAN ASHLEY
HALLINAN TIMOTHY
HAMMONS IMPLEMENT
INC
HAMOA PROPERTIES LLC
HARMAN MANAGERS
INVESTMENT
HART JUDY G
HATCH MARK
HATCH CINDA
HAUG CHRISTOPHER
WILLIAM
HAUG LYNN BASSETT
HAYDEN THOMAS H
HERNANDEZ FREIA H
HERNANDEZ ISMAEL
CAMACHO
HERNANDEZ JOHN
HERNANDEZ JORGE
HERNANDEZ CATHERINE
HERNANDEZ JOSE LUIS
HERNANDEZ MARCOS
HERNANDEZ RUTH A
HERNANDEZ UVALDO
HERRERA JOSE A
HERRERA JOSE F
HERRERA MARTIN
HERRERA MARIA

HERRERA MELISSA A
HERRERA-CABALLERO
JORGE VEGA CRISTINA
CABALLERO MA
HIJAR DONALD A
HIJAR JANINE A
HILLSIDE BAPTIST
CHURCH
HOBBS MARK
HOBBS IVONE
HOFFMAN KATHRYN E
HOLGUIN IGNACIO
Holly S. King
HOLSTEIN STANLEY E
HOMEBUILDERS & DESIGN
BY LG INC
HOMECOMINGS
FINANCIAL NETWORK LLC
A/K/A HOMECOMINGS
FINANCIAL NETWORK INC
HORST KRISTI L
HORST LAWRENCE E
HOUSING AUTHORITY OF
CITY OF GREELEY
HUERTA ADAM LEE
HUERTA PEDRO M.
HUMPHREY NANCY (20%
INT)
IKENOUE GARY A (75.01
INT)
IKENOUE KENNETH E
(24.99 INT)
INDEPENDENT ORDER OF
ODD FELLOWS OF COLO
J & G PROPERTIES LLC
J & W ENTS LLC
JAQUEZ JOSE
PLASCENCIA JASMINE S
JIMENEZ JOSE MACIEL A
JIMENEZ PEREZ PEDRO
JMP'S CORPORATION LLC
JONES ANTIONETTE R
JONES MARJORIE
ARMENTROUT
JONES WILEY B JR
JONES PAUL T
JOSEPH C. FILIPPONI
Judith K. Toliver (5.555556%)
KIM SOON BOON
KJT INVESTMENTS INC
KNOX BILL G
KNOX LILA R
KOSMICKI DAVID D
KRAMER ELAINE FERN
KRAMER TIM

KREPS ROBERT D &
JEANNE M 1/2
KWON LILY
KWON YOUNG JIN
LAM RESOURCES LLC
LANDER ARMANDO JR
LARA SANTIAGO TORRES
LARSON MARK A
LARSON KAROLYNN S
LASART MICHAEL
MILLER PAMELA J
BOWEN ALLAN F
LASART MICHAEL
LASART SHERRY
LEDERMAN HEIDI
LEDERMAN JEFF
LEE ROBERT E
LEEVERS DEVELOPMENT
LLC
LEI INVESTMENTS LLC
LEINWEBER GARY R
LEINWEBER DIANE H
LEOS JUANA ANGELICA
LEWCHUCK JEREMY R IRA
LEWCHUCK JEREMY R IRA
LIBSACK TIMOTHY
LOCKMAN RONALD J
LOCKMAN SHERYL L
LOMA JOSE A
LOMA RAMON
LOOKHART DEAN
LOPEZ ALBERTO
LOPEZ LUCIO AVALOS
LOPEZ ROLANDO CASAS
LOPEZ TOMAS BLAS
LOREDO VIOLETA
LOVELY HOWARD JR
LOVELYREALESTATEINVE
STMENTS LLC
Ludene West (5%)
LUNA REGINALDO
CONCHAS
LUNA CAROLS CONCHAS
LUNA RODRIGUEZ
FEDERICO
NARANJO BONIFACIO
LUNA-IBARRA ALVARO
LUNBERRY OLIVER W JR
LUNBERRY KATHY E
LUNN STEPHEN L
M&C HOLDINGS LLC
Mac Kenzie Enterprises, Inc.
MACKENZIE EMMETT E JR
LOVING TRUST
MADERA MARIANO

VETTING NORTH

EXHIBIT A
VETTING NORTH

MADERA VIRGINIA
BARRIOS DANIEL MADERA
MADERA VIRGINIA
MADERA MARIANO
MADRIGAL JESUS S
MARTINEZ MARIA DE
JESUS GARCIA
MAIN LORRAINE R
MAINLAND HOLDINGS LLC
MANRIQUEZ DAEN
MARDI GRAS PROPERTIES
LLC
MARQUEZ ALVARO
MARTIN E L
MARTIN ERNEST L
REVOCABLE TRUST
MARTIN JEAN M
MARTINEZ ELIAS RAMOS
LOMA OLIVIA
MARTINEZ ENEDINA
MARTINEZ JOEL
MARTINEZ LUCIA T
MATEO MARIO TOMAS
TOMAS NOLASCO
SANTIAGO
MATTHEWS JAMES
WILLIAM
MATTHEWS MARGARET M
MCCANN LINDA C
MCCLURE MELISSA SUE
MCDONALD'S CORP.
MCDONALDS
RESTAURANTS OF CO INC
MCKEE SHYLA (BN)
MEDINA DONNA S
MEDINA LUPE
SEGELKE THERESA
MEDINA RAMON
MEDINA LINDA T
MEDRANO MARIA
ENRIQUETA
MENDOZA JOSE
MEREDITH JAMES M
MEREDITH MIRIAM A
MEYER GEORGINA
MEYERS LETA M
MEYERS LLOYD A (HEIRS
OF)
MEZA CHRISTIAN
MEZA JULIAN A
MEZA MARIA ELENA
VENEGAS
MICHAEL B. SMITH AND JO
ELLEN SMITH
Michael I. Schaffer

MIECZKOWSKI GARY A
MIECZKOWSKI MARCELLA
R
MILAN PROPERTIES LLC
MILLER JESSE O
MILO GENERATIONS LP
MOHNEY MICHAEL
MOLINAR JOHN JOSEPH
MOLINAR BRENDA LEE
MONHOLAND SETH
MONHOLAND CHELSEA
MONTES ALVARO
MOORE SHEILA RAE
MORALES FRANCISCO
MORENO MARIA
MORENO OSCAR
MORGAN SARAH E
MOSQUEDA JOSE M
MOSQUEDA JOSEFINA
MOSQUEDA ROGELIO
MOSSMAN SAMUEL A
MOSSMAN VICKI S
MUCK ALICE H
MUCK DENNIS R
MUCK DONALD H
MURPHY & HOFFMAN
JOINT VENTURES LP
MYERS MARK M
NAJARRO GOMEZ
BERNABE FERNANDO
NAJERA EVARISTO H
NAJERA JOSEPHINE J
Nancy Winters (5%)
NARANJO LEO
NAVA FABIAN
NCO RENTALS LLC
NELSON DEBRA J
NOLA INVESTMENTS LLC
NOLLER JUSTIN L
NYX, LLC
OB PROPERTIES LLC
OCHOA ANDREA
OJEDA JUANITA
OJEDA FERNANDO
OLIVER ANNETTE
ORLANDO ESPARZA-
GONZALEZ
ORTEGA MIGUEL
ORTIZ IGNACIO
PACHECO ROLOLFO
PALOMARES ALONSO
PARAMO JOSE JUAN
AGUILAR
PARKVIEW SOUTH
PROPERTIES LLC

PARRA FRANCISCO P
PARRA ALMA B
PARRA-GONZALEZ
ENRIQUE
PAZ NORMA I
PEIRCE MICHAEL J
PEREA ANDY
RIVERA DE NUMO SARA
PERRY CAROL J
PERRY GREGORY G
PERRY TERESA A
PETTENGILL STAN A
PFANKUCH JOHNSTOWN
VENTURE LLC
PIETRYKA WAYNE
RICHARD
PIONEER POST CLUB OF
GREELEY
POMA ROJAS ARMANDO
DAVID
ORDONEZ-ALVARADO
MERCEDES
POUDRE VALLEY LODGE
No. 12 THE
POWELL SHANE
Principal Energy, LLC
(27.50%)
PRO GLASS & PAINT
PRO GLASS & PAINT LLP
PUBLIC SERVICE CO COLO
QUINTERO MARIA DEL
CARMEN
RAGSDALE FRANK J
RAISLEY DEBRA S
RAISLEY DENA K
RAISLEY JEFF G
RAISLEY JERRY
RAKOWSKI MITCHELL R
RAKOWSKI DIANE M
RAMIREZ ORACIO
RAMIREZ ROGELIO
RAMIREZ
RAMIREZ ANGELICA
HERNANDEZ
RAMOS ENRIQUE FLORES
REIBER BRADEN A
REIBER CHERYL A
REIBER DAVID V
REIF CASEY A
RENQUIST WILLIAM
CHARLES
RENQUIST JESSICA
NICOLE
RENQUIST MARIA
REYES CAROLINA

VETTING NORTH

EXHIBIT A
VETTING NORTH

ANALCO PABLO
REYES GUADALUPE
REYES MARIA S
REYES SAUL
REYES MARIA LUCILA
CONTRERAS REYES NOEL
IVAN
RICHMARK DEVELOPMENT
LLC
RICHMARK MINERAL
PARTNERS LLC
RIOJAS JAIME
RIOJAS MARIA D
RIOS MANUEL J AMAME
RIOTT JOHN W
RIOTT SHARLA L
RIZO JOSE M
RIZO REFUGIO
RIZO DOLORES
RIZO YVONNE V
DOMINGUEZ ANGELO A
RJ&C INVESTMENTS LLC
ROBINS MICHAEL T
HENDERSON RANDALL R
ROBISON THOMAS C
RODRIGUEZ GABRIEL T
RODRIGUEZ VELIA
RODRIGUEZ GUADALUPE
RODRIGUEZ ROY RAMON
RODRIGUEZ ISMAEL
RODRIGUEZ JOSE A
RODRIGUEZ JOSE
ROSALES
GONZALEZ DANAY NOELIA
RODRIGUEZ JUAN M
DE LOS ANGELES
RODRIGUEZ MARIA
RODRIGUEZ KRISTY J
RODRIGUEZ MARCO
ANTONIO
RAMOS TERESA
ROGAKIS THERESA J
ROGERS JOHN C
ROGERS ANGELA M
THORNE MICHELE L
ROMERO HELEN
BENAVIDES JERRY
ROMERO RAMON G
GARCIA MARIA LUZ
Ronald R. Schafer
Barbara L. Schafer
ROSALES OBED ROJAS
ROSENOFF ROBERT
LEROY
ROTH MIRIAM

ROTH RAYMOND E
ROTH VERDA D
ROWLAND BILLY J
ROYBAL SAMMIE
ROYBAL URSULA
RPM HOLDINGS LLC
RPM PROPERTIES RLLLP
RUIBAL DIANA LYNN
RUIZ KATHY
RUIZ CARLOS
RUIZ MANUEL G
RUIZ MANUEL S
GUZMAN CYNTHIA
RUSSELL KELLY J
RYAN CAROL
SAENZ DULCES N
HERNANDEZ
HERNANDEZ LORENZA
SAENZ LOIDA AGUIRRE
SAENZ LORENZO F
BORREGO
BORREGO CECILIA
SAINT ELMO & COMPANY
LLC
SALAZAR CONSUELO
SALAZAR DOMINGO SR
SALDIVAR SAUL
SANCHEZ CHRISTINE A
SANCHEZ HELEN A
SANCHEZ ROBERTO
GOMEZ
SANDOVAL CLARENCE J
SANDOVAL VICTOR M
SANDOVAL CARLITA
SATER JARRED
SATER JARRED PAUL
SCHAEFER
REHABILITATION CENTER
INC
SCHMIDT WILLIAM H
SCHOOL DIST No. 6
SCHOOL DIST No. 6
SCHOTT BRENDA
SCHOTT RONALD
SCHWINDT GREELEY LLC
SCHWINDT NICHOLE
SEGURA TAMMY LEE
SEPULVEDA JESUS
SERL RONALD L
SERRANO CRISTIAN
BANUELOS
SHAW BARBARA A
SHAW JAMES L
SLAYMAKER JEFF D
SLEIGHT BEVERLY GRACE

SLEIGHT RANDALL
BRADFORD
SMITH MICHAEL A
SMITH NANCY H
SMITH RICHARD D SR
SNYDER ALLAN D
SNYDER SHERRY L
SOCIETY DBA
SOTELO MARIA T
SOTELO JUAN U
SOTO RAMON
RAMOS DO CASTRO OLGA
SOTO SIDY
SOULONG SALAMAH
SOUTHERN FOODS
GROUP LP
SPRATT KENNETH
SSMD LLC
SUAREZ MIRIAM
VALENZUELA ALFREDO
LOPEZ
SWAN STEPHEN
LOCKWOOD LAURA
T & B HOLDINGS LLC
TAFOYA THEODORE A JR
TAFOYA JANA E
TALAMANTES JUAN
TANAKA DALE KEVIN
THOMAS KEVIN M
THOMAS WENDY M
THOMSEN RYAN L
THREE BEARS LLC
TIM KRAMER & STEVE
COOPER PROPERTY
MGMT
TODD ALEXANDER F
TODD CAROL A
TODD WILLIAM W
TORRES ELOY MUNOZ
TORRES SEVERA
TRAPP BILLY
TRIGOS MARTIN DAVID
TRIGOS MARIA CARMEN
TRIMAC
TRANSPORTATION
CENTRAL INC
TRIMBER CYNTHIA J
TROWBRIDGE WILLIAM
TRUEMAN TRAVIS A
TRUJILLO YASMIN V
MONTREAL
TURNER MONOLITO M
TURNER SHALA
TUSKA CHRISTOPHER J
TUSKA ANA M

VETTING NORTH

EXHIBIT A
VETTING NORTH

UNION COLONY BANK
United States of America
UPTON ELIZABETH ANN
URTUSUASTEGUI MANUEL
URTUSUASTEGUI RAQUEL
V F W No. 2121
VALDEZ MICHAEL
VALDEZ KOLENE
VALENCIA FRANCISCO P
VALLEJO CRYSTAL M
MORA RAÚL VALLEJO
VALLES AURELIO
VALLES AURELIA
VAN DRIEL VICENTA
VASQUEZ JULIAN
VASQUEZ LORENZO
VASQUEZ LUIS CARLOS
VILLALOBOS
VEGA-HERRERA GABRIEL
VELAZQUEZ DE LA CRUZ
SOTERO
GARCIA MARTINEZ
CANDELARIA MARIA
VELEZ MARIA D
VERGARA LAURA
ELIZABETH
VILLALOBOS MAYRA Z
VILLALOBOS ALEJANDRO
VILLANUEVA MELITON
VILLANUEVA REYNALDO
VILLANUEVA TERESA C
VILLARREAL CRESENCIO
VILLARREAL J MANUEL
VILLARREAL JAVIER
VILLELA JOSE ANTONIO
WALLACE CHARLES
JONATHAN
WALLER THOMAS
WALTER EDDIE G
WALTER NANCY V
WALTER SCOTT
WAREHIME CODY L
WASILIK BERNADETTE
WBJP 5, LLC
WELLS RANCH LLLP
WESTCO FAMILY LIMITED
PARTNERSHIP
WESTERN EQUIPMENT &
TRUCK INC
WHITCOMB VERA M
WHITE DENISE I
WHITE ELEPHANT LLC
WHITE PHILIP R AND
DENISE

WIEDEMAN TERRY L &
JANICE L 1/2 INT
WIGHT LAURA M
WILCZYNSKI TED J
WILCZYNSKI TOM
WILSON MARTHA JO
Winifred June Kane
(16.666667%)
WISNEWSKI BETHEL
WISNEWSKI JERRELL
WOLF BERNICE
WOLF RICHARD
WOODS SHEILA
WRIGHT ANDREW K
YASMAR LLC
ZAMARRIPA EDUARDO
ZENDEJAS MIGUEL
PAYAN ANN MARIA
ZIGMAN MARVIN AND LOIS
BEBE TRUST 11/30/1989
ZUNUN ANTELMO

SPACING UNIT: SE/4 NW/4 & NE/4 SW/4 & S/2 NE/4 & N/2 SE/4 SEC 17, S/2 N/2 & N/2 S/2 SEC 16, T5N, 65W UNIT ACREAGE: 560

NAME: VETTING NORTH

WELL NAME	SURFACE LOCATION			LANDING POINT BEGIN HORIZONTAL COMPLETION ZONE			BOTTOM HOLE END HORIZONTAL COMPLETION ZONE			COMPLETION ZONE BEARING	COMPLETION ZONE LENGTH
	DIST.	DIR.	FWL	DIST.	DIR.	FWL	DIST.	DIR.	FWL		
VETTING 12	2003'	FNL	496'	2654'	FNL	460'	2649'	FNL	2337'	S89°23'44"W	7803.74'
VETTING 13	2000'	FNL	520'	2475'	FSL	460'	2475'	FSL	2338'	S89°24'14"W	7803.12
VETTING 14	1997'	FNL	544'	2310'	FSL	460'	2310'	FSL	2339'	S89°24'14"W	7802.54



0 2000
SCALE: 1"= 2000'
U.S. SURVEY FEET

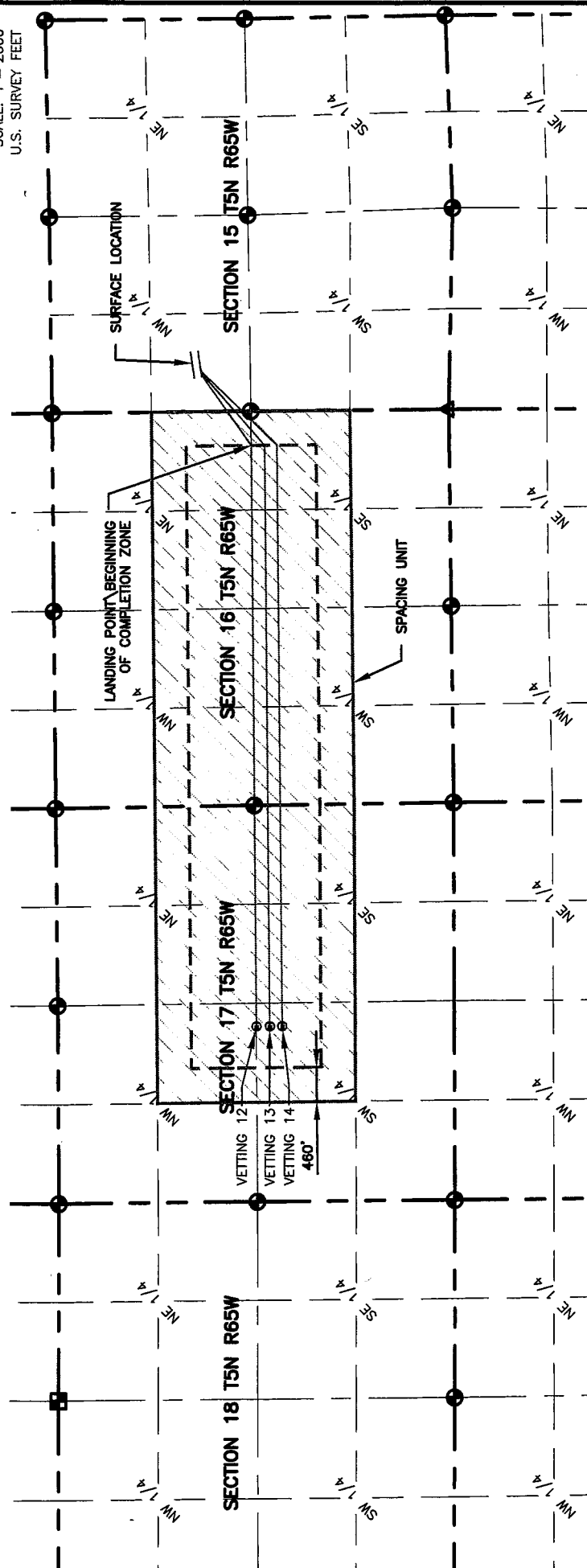

- LEGEND**
- ALIQUOT CORNER
 - ⊙ BOTTOM HOLE
 - ⊙ COMPUTED ALIQUOT CORNER FROM MONUMENT ACCESSORIES
 - ⊙ COMPUTED FROM GLO RECORDS

PLANNED SPACING UNIT EXHIBIT
VETTING 15-H
VETTING NORTH SPACING UNIT

4715 Innovation Drive 970.226.0342 | P
Fort Collins, CO 80525 970.226.0879 | F
www.LRA-inc.com

LAMP RYNEARSON & ASSOCIATES

DRAWN BY: KJW
DATE: 10/30/15
PATH/FILENAME: P:_Engineering\0215036 Vetting 15 H\DRAWINGS\EXHIBITS\0215036PSU-Vetting-N.dwg

PROJECT - TASK NUMBER: 0215036.00
PG-04 PG-6

BOOK AND PAGE: SURFACE - LOCATION SW /4, NW /4, SEC 15 T5N R65W

SECTION LINE: SIXTEENTH LINE
QUARTER SECTION LINE

BEFORE THE OIL AND GAS CONSERVATION COMMISSION
OF THE STATE OF COLORADO

IN THE MATTER OF THE APPLICATION OF)
EXTRACTION OIL & GAS, LLC FOR AN ORDER)
POOLING ALL INTERESTS IN THE CODELL)
AND NIOBRARA FORMATIONS IN THREE 560-)
ACRE WELLBORE SPACING UNITS)
COVERING CERTAIN LANDS IN SECTIONS 16)
AND 17, TOWNSHIP 5 NORTH, RANGE 65)
WEST, 6TH P.M., WATTENBERG FIELD, WELD)
COUNTY, COLORADO.)

Cause No. 407
Docket No. 160800327
Type: POOLING

AFFIDAVIT OF MAILING

STATE OF COLORADO §
CITY AND COUNTY OF DENVER §

I, Joseph C. Pierzchala, of lawful age, and being first duly sworn upon my oath, state and declare:

That I am the attorney for Extraction Oil & Gas, LLC and that on or before July 8, 2016, I caused a copy of the attached Application to be deposited in the United States mail, postage prepaid, addressed to the parties listed on Exhibit A to the Application.

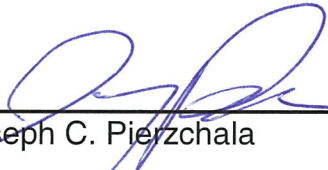

Joseph C. Pierzchala

Subscribed and sworn to before me July 8, 2016

Witness my hand and official seal.

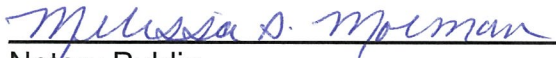

Notary Public
My commission expires: 8/29/2017

