

BEFORE THE OIL AND GAS CONSERVATION COMMISSION
OF THE STATE OF COLORADO

IN THE MATTER OF THE APPLICATION OF)
EXTRACTION OIL & GAS, LLC FOR AN)
ORDER POOLING ALL INTERESTS IN THE)
NIOBRARA FORMATION IN ONE 800-ACRE)
WELLBORE SPACING UNIT COVERING)
CERTAIN LANDS IN SECTIONS 16, 17 AND)
18, TOWNSHIP 5 NORTH, RANGE 65 WEST,)
6TH P.M., WATTENBERG FIELD, WELD)
COUNTY, COLORADO.)

Cause No. 407
Docket No. 160800326
Type: POOLING

APPLICATION

Extraction Oil & Gas, LLC ("Extraction" or "Applicant"), Operator No. 10459, by its attorneys, Welborn Sullivan Meck & Tooley, P.C., respectfully submits this Application to the Oil and Gas Conservation Commission of the State of Colorado ("Commission" or "COGCC") for an order pooling all interests in one approximate 800-acre wellbore spacing unit ("WSU") established for the S $\frac{1}{2}$ NW $\frac{1}{4}$, N $\frac{1}{2}$ SW $\frac{1}{4}$ of Section 16, the S $\frac{1}{2}$ N $\frac{1}{2}$, N $\frac{1}{2}$ S $\frac{1}{2}$ of Sections 17 and 18, Township 5 North, Range 65 West, 6th P.M., Weld County, Colorado for the development and production of oil, gas and associated hydrocarbons from the Niobrara Formation in WSU No. 1. In support thereof, the Applicant states as follows:

1. Applicant is a limited liability company duly authorized to conduct business in the State of Colorado.
2. Applicant owns a leasehold interest in the following lands ("Application Lands"):

Township 5 North, Range 65 West, 6th P.M.
Section 16: S $\frac{1}{2}$ NW $\frac{1}{4}$, N $\frac{1}{2}$ SW $\frac{1}{4}$
Section 17: S $\frac{1}{2}$ N $\frac{1}{2}$, N $\frac{1}{2}$ S $\frac{1}{2}$
Section 18: S $\frac{1}{2}$ N $\frac{1}{2}$, N $\frac{1}{2}$ S $\frac{1}{2}$

Weld County, Colorado.

A reference map of the Application Lands is attached hereto.

1. Rule 318A.a.(4)D. provides, in relevant part, that where a drilling and spacing unit does not exist for a horizontal well, the horizontal wellbore spacing unit shall be comprised of the governmental quarter-quarter sections in which the wellbore lateral penetrates the productive formation as well as any governmental quarter-quarter sections that are located less than four

hundred sixty (460) feet from the portion of the wellbore lateral that penetrates the productive zone regardless of section or quarter section lines. Rule 318A.a.(4)D. further provides that a horizontal wellbore spacing unit may overlap portions of another horizontal wellbore spacing unit or other wellbore spacing unit designated in accordance with subsection a.(4)C. The Application Lands are subject to this Rule.

2. Applicant plans to drill and complete the following wells in individual wellbore spacing units covering the Application Lands in the corresponding formation:

- a. **WSU No. 1:** VT-Alles 1-16-18 well (API No. Pending). Estimated spud date third quarter 2016. Located 2,006 feet FNL and 472 feet FWL, Section 15, Township 5 North, Range 65 West, 6th P.M. to produce oil, gas and associated hydrocarbons from the Niobrara Formation.

Hereinafter, the "Well."

3. Pursuant to the relevant provisions of Section 34-60-116(6) & (7), C.R.S., and COGCC Rule 530, Applicant seeks an order pooling all interests in the Application Lands for the development and operation of the Niobrara Formation in WSU No. 1.

4. Applicant certifies that, at least thirty-five (35) days prior to the date of the scheduled protest deadline for this Application, each owner which Applicant was able to locate, not already leased or voluntarily pooled, will be provided with the well proposals and information required by Rule 530 and tendered a reasonable offer to lease (if an unleased mineral owner), or participate and bear costs associated with the drilling and completion of the Wells.

5. Applicant requests that a pooling order be entered as a result of this Application and that it be made effective as of the earlier of the date of this Application, or the date costs specified in Section 34-60-116(7)(b)(II), C.R.S., are first incurred for the drilling of the wells the Niobrara Formation.

6. The granting of this Application would be in accord with the Oil and Gas Conservation Act, found at Section 34-60-101, *et seq.*, C.R.S., and Commission rules.

7. The names and addresses of the interested parties (persons who own an interest in the mineral estate of the tracts to be pooled, except owners of overriding royalty interest) are attached hereto and marked Exhibit A. Applicant certifies that copies of this Application will be served on all locatable interested parties within seven (7) days of the date hereof, as required by Commission Rule 507.b.(2), and that at least thirty-five (35) days prior to the date of the scheduled protest deadline for this Application, each such owner not already leased or voluntarily pooled will be offered the opportunity to lease, or to participate in the drilling of the Wells, and will be provided with the information required by Rule 530.

WHEREFORE, Applicant respectfully requests that this matter be set for hearing, that notice be given as required by law and that upon such hearing this Commission enter its order:

A. Pooling all interests in the Application Lands for the development and operation of the Niobrara Formation in WSU No. 1.

B. Providing that the pooling order is made effective as of the date of this Application, or the date that the costs specified in Section 34-60-116(7)(b)(II), C.R.S., are first incurred for the drilling of a well in the Niobrara Formation in WSU No. 1 on the Application Lands, whichever is earlier;

C. Providing that the interests of any owners, with whom the Applicant has been unable to secure a lease or other agreement to participate in the drilling of the authorized wells, are pooled by operation of statute, pursuant to Section 34-60-116(7), C.R.S., and made subject to the cost recovery provisions thereof;

D. For such other findings and orders as the Commission may deem proper or advisable in the premises.

Dated this 30th day of June, 2016

Respectfully submitted,
WELBORN SULLIVAN MECK & TOOLEY, P.C.

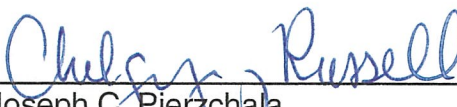
By: 

Joseph C. Pierzchala
Chelsey J. Russell
Welborn Sullivan Meck & Tooley, P.C.
Attorney for Applicant
1125 - 17th Street, Suite 2200
Denver, CO 80202
303-830-2500
jpierzchala@wsmtlaw.com
crussell@wsmtlaw.com

Applicant's Address:

370 17th Street, Suite 5400
Denver, CO 80202
Attn: Drew Stout, Landman
Phone: 720-557-8325

VERIFICATION

STATE OF COLORADO)
) ss.
CITY & COUNTY OF DENVER)

Drew Stout, Landman with Extraction Oil & Gas, LLC, upon oath deposes and says that he has read the foregoing Application and that the statements contained therein are true to the best of his knowledge, information and belief.

EXTRACTION OIL & GAS, LLC



Drew Stout, Landman

Subscribed and sworn to before me this 30th day of June, 2016 by Drew Stout, Landman for Extraction Oil & Gas, LLC.

Witness my hand and official seal.

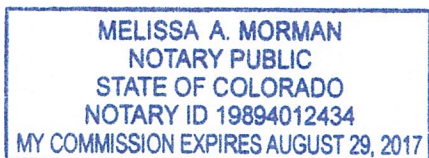

Melissa A. Morman
Notary Public
My Commission Expires: 8/29/2017

EXHIBIT A
VT-ALLES

1017 5TH STREET LLC
1717 ESTATE, LLC
1811 21ST ST RD LLC
2237 9TH AVENUE LLC
2425 14 AVENUE LLC
2438 10 AVE LLC
2439 9TH LLC
24TH ST PROPERTIES LLC
2500 14TH AVENUE COURT
LLC
2620 14 LLC
3 MARGARITAS XX INC
4 BY 4 LLC
4K REAL ESTATE LLC
824 24ST LLC
A & G CONCEPTS INC
A A M INVESTMENTS LLC
AAM INVESTMENTS LLC
AAS HERMAN WALLACE
ADAME JOSE C REY
ADAMS ELISE K AND
LESLIE R
ADAMS FRANCES
ADAMS MYRON T
MARINE SHIRLEY A
ADRIAN O. TARIN AND LUZ
ESTELA TARIN
AFFORDABLE COMMUNITY
HOUSING
AGAN KEVIN S
AGAN WILLIAM T
AGHAJANI SAMAD D
AGHAJANI SUSAN K
AGUAYO TERESA
AGUERO EDWARD A
AGUILAR MAURICIO
ALBERTS CLARA
ALCUDIA-PEREZ
ANGELICA
ALEXANDER ROSS LEE
AND RITA GEVENE
ALIG CHRISTOPHER J
ALIREZ ANTHONY D
MARTINEZ JOZETTA L
ALIREZ ANTHONY J AND
MARIE R
ALIREZ JOE L AND
JOSEPHINE
ALLEN JOHN P
DENGLER TONI L -
ALLEN PAUL G AND
KATHERINE E
ALLES MARION K DOERR
ALLGAIER IRENE M

ALLISON JOHN M AND
SHIRLEY
ALLISON SHIRLEY FLOT
TRUST
ALMANZA HECTOR
GONZALEZ JUDITH
ALONSO VINCENT
ALSTON JOSEPH B
ALVACANO FRANCISCO
ALVA-VILLALOBOS MARIA
ISABEL
ALVAREZ JUAN E
ALVAREZ MONICA
ALVIDREZ DINO C
ANDERSON CLARENCE R
III
ANDERSON ERICA S
ANDERSON LARRY D
ANDERSON SARAH A
ANTOMMARIA AMY
APARICIO CARLOS
APARICIO CARLOS A
SEGOVIA JOSE E
APPLEGATE MARC A
APPLEGATE PATRICIA A
ARCHABALD JOSEPH
DAVID
ARCHDIOCESE OF
DENVER
ARGONAUT VENTURES
LLC
ARGUELLO YVONNE
ARREDONDO VICTOR
MANUEL
ARREDONDO JULIANA
ARREOLA JUSTINO
ARREOLA TAYDE
ASHER JUNKO TOKIWA
ASHLAND DEBRA
AVALOS EDWIN
AXTELL STANLEY B AND
VIRGINIA E
Aztec Exploration LLC
B & B LOCAL
CONSTRUCTION LLC
B&B LLC
B&B LOCAL
CONSTRUCTION LLC
BAER NORMAN W AND
MARY H
BAESSLER PROPERTIES
LLC
BAIRD GRAHAM B
BAKER BECKY ANN
BAKER DONALD L

BAKER GARY L AND LINDA
D
BALL CODY ROLLAND
BALLARD DENNIS R AND
ROBERT J
BALZER PAMELA A
BALZER TIMOTHY J
BAMRICK MICHAEL G AND
DONNA J
BANC OF AMERICA
MORTGAGE CAPITAL
CORP
BANEY TERRIE L
BANKER EMILY J
BARBARA H BAILEY LIVING
TRUST
Barbara Scott Moore
BARCO BENJAMIN JAMES
BARLETT LORRAINE EMMA
TRUST
BARRAZA NOLBERTO
PINEDA
BARRIER HAROLD GRAY
BAYSWATER BLINHEIM
HOLDINGS II, LLC
BAYSWATER
EXPLORATION AND
PRODUCTION LLC
BEATON DENNIS C
BEATON LINDA M
BEHNING RICHARD A JR
BELL GAIL LAVON
BELOIN ALLEN M
BENDER LARISSA
BENTER ROBERT
D(TRUST)& ADELE
C(TRUST)
BENTON BRIAN B
BERETT DALTON E
BERGER JOHSUA AND
JAMES
BERUMEN ANIBAL
BETTS AMANDA K
BETTS EDWIN H JR
BICKELL JOAN M
BIG DOG ENTERPRISES
LLC
BIRMINGHAM
CORPORATION
BLAKELEY SHARON C
BLAKELEY JOHNNY M
BLAKLEY ALAN R
BLOSKAS PAMELLA JO
BLUE DOOR PROPERTIES
LLC

EXHIBIT A
VT-ALLES

BMC WEST CORPORATION
BOARD OF TRUSTEES OF
UNIVERSITY OF
BOCANEGRA GUADALUPE
BOCANEGRA VICENTE
AND GUADALUPE
BODE DENNIS A
BODE ELLEN L
BOLEK SHEILA
BOLTZ BRADLEY A
BOLTZ LAURIE ANN
BOLTZ BRIAN M
BOMARETO ROBERT
BONDS JEFFREY J AND
KIMBERLY A
BONELL GOOD
SAMARITAN CENTER
BOOTHE DENNIS L AND
CHERYL J
BORST JAMES H
BORYS RICHARD M
BOTTERILL DAVID F AND
LISA A
BOWEN DAVID WAYNE
BOWEN KIRA A
BOWEN ROBERT FOSTER
BOWL FORT COLLINS LLC
BOWLES MATTHEW C
BOWSER DENISE L H
BOWSER MICHAEL H
BOWSER THOMAS L
BOYD YUEBO FENG
BOYD-GIBONEY KATHY B
BOYS CLUB OF GREELEY
INC
BRADFIELD MELISSA A
AND GREGORY N
BRADFORD JASON L
BRANDRUP KIT DEAN
BREEDEN EDWARD E
BRIGHAM BARBARA A
BRIGHAM K PAUL
BROOKS ALFRED LEE
BROWN A M
BROWN CARL
BROWN CHRIS A
BROWN DUDLEY E
BROWN CORINA E
BROWN FENESSA C
BROWN G HAL
BROWN G HAL
BROWN ROGER LLOYD
AND BETTY BURDORFF
BROWN THELMA M
STEEL SHARON F BROWN

STEEL JAMES
BRUCHS MICHAEL R AND
AMY G
BRUCKNER TRUCK SALES,
INC.
BRUNER DAN S AND RUTH
ANN
BRUNNER G JOHN &
SHERRON A
MORGAN SUSAN J
BUCKLEN VELDA
BUDENSIEK DALE
ANDREW AND JENNIFER
DAWN
BUEL DONALD L AND LOLA
F
BUENO VERONICA
BUETTNER DARREL L AND
DIANE L
BUHLER MARK AND
BECKY
BUNI ABCILLAHL JAMA
BURHAM CAROL JEAN
BURNELL JIMMIE B
BURNS LUTHER HAROLD
AND FRANCES C
BURSON DENNIS B
BUSS BEVERLY S
BUSTILLOS RAMON
BUSTILLOS ALMA
PATRICIA
BUTZINE CHARLES P
BUTZINE ROSEMARY E
BUXMAN LARRY
C & D INVESTMENT CO
C BAESSLER PROPERTIES
LLC
CALDERON VICTOR
CONTRERAS
CAMPBELL MICHAEL C
CAMPBELL ZETH AND
KRISTEN
CANNON DELBERT
DWIGHT
CANNON LINDA JEAN
VERVERS ROBERT
CARCELLERO FRANKIE T
CARLSON SJON A
CARMICHAEL MICHAEL A
AND NINA K
CARMICHAEL MICHAEL
AND NINA
CARRANZA JOSE C
CARRANZA JUAN CARLOS
MEJIA

CARRON BRUCE C
CARRON CHERIE
CARTER BENJAMIN
CARTER JAMIE O
CARTER KELLY L
CARTER JASON
CARTER LISA
CARY JOLEEN A
CASTILLO OTILIO P AND
GLORIA L
CATHOLIC CHARITIES &
COMMUNITY SERVICES
CATHOLIC CHARITIES &
COMMUNITY SERVICES
CAUDILLO VEGA ANA K
CEMER ROBERT L
CEMER LINDA MARIE
CENTRAL WELD CO
WATER DISTRICT
CHARLOTTE WORSTER
CHAVEZ LLOYD
CHAVEZ LORRETTA
CHAVEZ LUIS
CHERNOFF LEONARD
TRUST
CHESTER SCOTT
CHRISTOFFERSEN EDWIN
K AND DIANA S
CIRCLE CORP
CITIMORTGAGE INC
CLARK GENEVA A TRUST
CLARKSON COLLETTE J
CLEMMER M SCOTT AND
AUDREY K
COCKROFT DEAN D
COLE SANDRA L
COLLEGE ESTATES LLC
COLLEGE ESTATES LLC
COLORADO CORN
ADMINISTRATIVE
COMMITTEE
COLORADO JOE, LLC
COLORADO STATE LAND
BOARD
COLUMBINE CHURCH OF
CHRIST
COLUNGA ANGELINA A
COMANCHE ENTERPRISES
INC - 2.56308%
CONFER KRISTY L AND
ROBERT W JR
CONLEY CLOYD C III
CONLEY JAMES L
CONNELL CAROL F
"CONNELLY HAROLD H

EXHIBIT A
VT-ALLES

CONNELLY GERALDINE "
COOK ROBERT J
COOPER BRUCE D
COOPER SHERRY LYNN
COOPER STEVE DBA
CORDOVA ERMINIO
COREAS PETRONA
NAVARRO CARLOS E
CORRALES JOAN
ANTONIO
COWAN KEITH
COWLING SHAWN M AND
WHITNEY
COX CURTIS J
COX VANESSA B
COZENS ROGER W AND
ALICE L
CRITTENDEN BRAD A AND
LEA
CROMPTON THOMAS J
AKAHOSHI LOIS F
CROP PRODUCTION
SERVICES INC
CROWELL CHARLES W
AND KATHLEEN A
CULVER JESSE R
GABBERT MORGAN DIANA
CUNNINGHAM ARTHUR P
AND ROXANNE M
CUNNINGHAM CHRISTIE L
CURRIE & WALKER LLC
DAHARSH TERRY N AND
UNDEE D
DAILY DAN M
DAILY J T MITCHELL AND
LISA L
DALLOW KURT THOMAS
AND CYNTHIA LOUISE
DANIEL LARRY W AND
LORI A
DANNAR DARYL V AND
JOYCE LYNN
DANNAR JUDY L
DAUM CHARLES W AND
DOROTHY B
DAWSON DANIELLE L
DE LA TORRE TANIA
ALEJANDRA REYES
DE VOE DIANA B
DE VOE DOUGLAS B
DEACON GREGGORY B
DECKER S D AND SHIRLEY
A
DEEP BLUE L P
DELEVANTE VIVIAN

DELGADO ERMELINDA
DENT RENEE
DERN NONNA M
DESOUSA MANUEL R AND
TERESA
DEVANEY CATHLEEN
DEVANEY CHRISTINE AND
CATHLEEN A
DEVORE DANIELLE A
DEVRIES JERARD L AND
MARY G
DIAZ LUCILA
DICE TOMMY A
DIETZ LA VERNE E
REVOCABLE TRUST
DIETZ REAH B
REVOCABLE TRUST
DILL PAULETTE C
DILLON SARA C
DIXON ROBERT L AND
VIRGINIA J
DOLLARD LINNEA S
DOLLARD ROBERT G
DOMINGUEZ ILDEFONSA
DORLAND JEFFREY S
DORLAND MARY L
DOWD ALAN J AND
TERESA
DOWNING MARISE R
DOWNING MARY V
DOWNS DARIN R
DOWNS ROSE L
DUDLEY DONNA K REV
LVNG TRUST
DUMMETT NICOLE AND
SETH
DURAN KANDICE L
DURR CARRIE
DURR DONALD D
TRUSTEE
DVORAK NEAL
DWYER MICHAEL J AND
MICHELLE L
DYBEN COREY
ANDERSON STEPHENIE
E SPEAR INVESTMENTS
LLC
E.S.K.LLC
EAKLE JAMES R
EBY BETTY J
EBY STEPHEN E
ECKHARDT BENJAMIN A
ECKHARDT DONALD W
ECKHARDT DOROTHY L

Edwin K Christoffersen;
Diana S Christoffersen
EIRING DONALD L AND
ANNE E
EL BANDIDO NIGHT CLUB
LLC
EL RICK INVESTMENTS
LLC
ELLIOTT WANETA R
ELLSWORTH CLARA L
ENDICOTT EDWARD C
AND PHYLLIS S
END-IRA INC FBO FBO
JEREMY LEWCHUK IRA
ENGLAND CARL B
ENGLAND CAROLYN J
ENMAN RICHARD H
EOS LLC
EQUITY ASSOCIATES
LIMITED
ERICKSON DANA R (50%)
ERICKSON KENT R BETTY
JANE
ERICKSON TRACY ANNE
TRUST (50%)
ESCOBAR ALEX
ESQUIBEL ADRIAN G
ESTATE OF MYRTLE L.
WILCOX
ESTRADA MEDALIA
EVANGELICAL LUTHERAN
GOOD SAMARITAN
EVANS JANET
EVANS MARY EMILY
EZ STORAGE LLC
F & H HOLDINGS LLC
F & S PETROLEUM INC
F&H HOLDINGS LLC
FABRIZIUS GINA D
FABRIZIUS LOUIE S
FALCONER J SCOTT
FALCONER SYLVIA A
FAMILY FABRICARE LLC
FARLEY KAREN L
FARR 2526 LLC
FARRINGTON CHILDREN'S
TRUST
FARRINGTON PATRICIA H
TRUST
FARRINGTON WALTER L III
FARRINGTON WALTER L
JR
FBO INVESTMENTS LLLP
FEHLMANN FRANK
OTOOLE ANGELICA

EXHIBIT A
VT-ALLES

FELLOWSHIP CHAPEL INC
FELTON CAROL A
FERGUSON BARBARA J
FERGUSON JAMES A
FERNANDEZ ENRIQUE
FERNANDO ANGELA
FERRARI JOHN A II
FEUERSTEIN JOHN E
FIECHTER CHARLES AND
DELILAH
FILES MARY KATHERINE
TRUST
FINDLEY ELVERA MAE
AND RODNEY
GLIEM LAUREL A
FINK DOUGLAS V AND
HILLARY A
FINKE DOYLE H
FIREHOOK PROPERTIES
LLC
FIRST FARM BANK
FITZGERALD DANIEL F
FLANAGAN DANIEL F
FLESHER JAMES AND
MALINDA
FOCHT WILLIAM C AND
CYNTHIA S
FOOS DON AND VIRGINIA
V
FOOTE DAVID L
FORD JENNIFER DANIELLE
FORSTER DONALD A
FORSTER PAMELA R
FORSYTHE W H AND
CAREN S
FOSTER MARC D
FOSTER NANCY L
FOUGASSE VENTURES
LLC - 10%
FOUR PILLARS 10TH AVE
LLC
FOX JUSTIN
FRANK MARLIN D AND
JUDITH J
FRASER JOHN (60% INT)
FREEMYER JOLEEN W
FRICK ROBERT L
FRICK LORETTA J
FRIED JEFFREY A
FRITZ WILLIAM J AND
ELSIE M
FRYZEK REBECCA MAE
FUSCO JEREMY D
GAISER GREGORY P AND
TONIA R

GALE FRANK A
FIRESTONE KATHRYN ANN
GALLEGOS ERNIE L AND
MARYLIN J
GALLEGOS VINCENTE
GALLEGOS LISA
GAMBRELL SHARLA RAE
GANDELMAN GARY
GARCIA ADRIANA
GARCIA CONNIE DIANE
GARCIA ELIAS I
GARCIA ENRIQUE PARRA
PARRA MARIA D
GARCIA GABRIEL M
GARCIA GLADIS
GARCIA MARIA VENANCIA
GARCIA MARTIN
GARCIA SONYA RIOS
GARCIA LAZARO H
GARDEN CITY
ENTERTAINMENT INC
GASTON KARRIE J
GAUNA SILVA
GENTRY CHERYL L
GEORGE MARK J AND
LINDA S
GERINGER CHRISTINA
GESICK DONALD L AND
JERAN L
GIBSON JASON J BRAMER
DESIREE N
GIESICK JOYCE E
GILBREATH SANDRA L
GODWIN EVAN RAYMOND
GOETZ MILBERN H AND
KATHERINE L
GOFF LAURA L AND RYAN
GOLD LEAF REAL ESTATE
INVESTMENTS LLC
GOMEZ MARIA C GUZMAN
GONZALES DANIEL
THOMAS
GONZALES JOSEPH
LEONARD
GONZALES MANUEL C III
GONZALES YOLANDA R
GONZALEZ CRISELDO
GOOD SAMARITAN
HERITAGE COMMUNITIES
LLC
GOODALE TIMOTHY
GORDON TROY LEE
GORDON TROY LEE
GOSS DAVID CHARLES
AND KELLEY ANN

GRAF LAURIE L
GRAHAM CARMEN
GRAY DEBRA
HISSUN CHARLEY RULING
GREAT NORTHERN
PROPERTIES LLLP
WHEELER PROPERTIES
LLC
GREELEY COLUMBUS
CLUB ASSOCIATION INC
GREELEY SEED REAL
ESTATE LLC
GREEN ERICH A
GREEN MICHAEL S AND
JOSHUA D
GREENE TASHA RAE
GREGORIO JOSHUA DAVID
GREGORIO CELESTINE N
Gregory J Scallon
GREGORY STEPHEN W
AND PEGGY J
GRIFFIN PEGGY A AND
JAMES M
GRIMALDO MICHAEL A
ROBERTS CRISTINA E
GRIMES ELDON D
REVOCABLE TRUST
GRIMM CARROLL G AND
SUSAN Y
GROVER JEREMY
GTA PROPERTIES LLC
GUERIN LANCE AND
DIANA
GUERRERO FRANK JR
GUERRERO MARIA DIANA
GUSTAFSON DEBRA L
GUTIERREZ HERIBERTO
GUTIERREZ JOE I AND
MARY
HAEFELI DEANNA
HAGGAN RICHARD AND
PAULETTE
HALL ANDREA
HALL RYDELL ROBIN REV
LIVING TRUST
HAMANN HOLLY K
HAMILTON MARTIN B
BAKER SHERRY JEAN
HAMMONS IMPLEMENT
INC
HAMOA PROPERTIES LLC
HANISCH ARIC
HANKE BARBARA
HANSEN CHARLES A
CORNELIUS LYNN M

EXHIBIT A
VT-ALLES

HARMAN MANAGERS
INVESTMENT
HARMON ANNE M
HARMON ROGER DEAN
AND SANDRA MARLENE
HARMUTH HEATHER M
HARO ALFREDO AND
JUANA
HARPER DENISE AND
DONN
HARPER VIRGIL G
HARPER WENDY G
HARRIS CHARLES H
HARRIS JILL M
HARRIS LORI
HARRISON CATHALINE
ANN
VAUGHN SARAH
ELIZABETH
HARRISON JOHN WM
REVOCABLE TRUST DTD
HART JUDY G
HART LINDA M AKA LINDA
MARIE
HART ROBERT T
HARTWICK HOLLY A
HATCH MARK
HATCH CINDA
HAUG CHRISTOPHER
WILLIAM
HAUG LYNN BASSETT
HAWLEY DEANNA D
HAYDEN THOMAS H
HAYES JANNET DEE
HEARD RAE MARIE
HEILBRUN TOM L AND
RANAE N
HEIN JEREMY R AND
CARLA A
HELGESON SARONDA,
JACQUELINE AND PAUL
HENEFIELD MARGARET
RUTH
HERMAN LAUREN A
HERNANDEZ FREIA H
HERNANDEZ JOHN
HERNANDEZ RUTH A
HERREN JIM D
HERRERA JOSE F
HERRERA OMAR RAY AND
KAREN NICOLE
HERRICK WENDI
HETTINGER JERAMY W
AND LISA R

HETTINGER TIFFANY E
AND JASON N
HEWITT JOHN T
HIJAR DONALD A
HIJAR JANINE A
HILL JAMES E, JACK AND
DENISE
HILLMAN RICHARD AND
LINDA M
HILLMANN ERWIN
HILLSIDE BAPTIST
CHURCH
HILLSIDE CARWASH LLC
HILLSIDE PROPERTIES
LLC
HILZER KIRK W
HILZER KIRK W AND
MICKIE A
HILZER MICKIE A
HINE ELLEN L
HINOJOSA ANTONIA LARA
HINOJOSA SAMUEL F
HOCH EMILY L LAURA M
AND THOMAS E
HOFFELT STEPHEN D AND
DEBORAH S
HOFFMAN KATHRYN E
HOFFMAN LOUANN
HOFFMAN MICHAEL S AND
JESSICA L
HOFFNER ALICE C
HOLCOMB WALTER E AND
DANA L
HOLGUIN IGNACIO
Holly S. King
HOLOHAN ANNE J
HOLSTEIN STANLEY E
HOPKINS RYAN L
HORNER MOSES
HORNER MOSES
HORST KRISTI L
HORST LAWRENCE E
HOTCHKISS MICHAEL C
HOUSING AUTHORITY OF
CITY OF GREELEY
HOUTCHENS JANE
HOWARD SHIRLEY JUNE
HOWELL KENNETH
HUBBARD CAROLYN K
AND OTTO C
HUDSON MARK EDWARD
AND ANN HUMMEL
HUERTA ADAM LEE
HUMPHREY NANCY
HUNTER REBECCA S

HURT LYNN M
HURT MAXINE K
IDE MAXINE R
IKENOUE GARY A (75.01
INT)
IKENOUE KENNETH E
(24.99 INT)
INDA MIGUEL AND
JENNIFER D
INDEPENDENT ORDER OF
ODD FELLOWS OF COLO
INGINO CAROL A
INGRAM JAMES E AND
GLORIA
INHULSEN BRAD JR
IYER R VISHWANATHAN
J & G PROPERTIES LLC
J & W ENTS LLC
JACKSON JEFF
JACKSON LINDA K
JACKSON NELLIE M
JACOBSON G LORENE
(BN)
JACOBSON VICKY L
JAKEL LARRY W AND
PAMELA J
JAMES MAUREEN A AND
STEVEN D
JANDREAU NEAL J AND
RAQUEL D
JANES MICHAEL G AND
SHAVONN S
GRAY ROBERT H
JANSTE GROUP LLC
JAYSIX LLC
JAYSIX LLC
JD INVESTMENTS III LLC
JELDEN ROSE M
JENSON ANDREW
JESSICA WALKER
JETT DEBRA S
JEWETT VICTORIA L
JIMENEZ PEREZ PEDRO
JMAC 1016 LLC
JMPS CORPORATION LLC
JO ENTERPRISES LLLP
JOHNSON GERALD L
JOHNSON GRANT
JOHNSON KALA
JOHNSON TANA
JOHNSON JAY A AND
MILLER CONSTANCE R
JOHNSON LUCIE ANN
JOHNSON RICHARD R AND
JOYCE J

EXHIBIT A
VT-ALLES

JOHNSON SARA J
REVOCABLE TRUST
JONES ANTIONETTE R
JONES KENNETH C AND
JANICE T
JONES PAUL T
JORGENSEN JUILS D AND
DIXIE C
JOSEPH C. FILIPPONI
JUDISCH MARLYS JEAN
JUDY JERRY S AND
LEONOR N
JURANEK RACHEL L
KALCICH RUDOLPH J AND
LINDA
KARAKOK GULDEN
KARL CHRISTOPHER C
OLIVER-JACOBSON
ADRIENNE M
HOBBS ROBIN LISA
KASTNER PETE
KRAMLICH JEAN A
KATHLEEN KAY MILES
KAUFFMAN JANE F
KEBERLEIN TOM
KEFFLER LOUISE -
2.1359%
KEIL GLEN R LIVING
TRUST
KELLY RICHARD
KENNETH H BURDEN AND
CLARITA F BURDEN
FAMILY TRUST 6/19/1994
KIDD PATRICIA A
KIDD BRENT D
BEITZEL COURTNEY J
KIELIAN STEVEN C AND
KAREN L
KIESLING MARY
KILKER WENDY WRIGHT
KIM SOON BOON
KIMBALL LOUIS M
KING LAURA KATHLEEN
KINNEY MICHAEL A AND
VIRGINIA M
KISHIMOTO KAZU T
KJT INVESTMENTS INC
KLEIN ROBERT
KLINGENBERG GOLDIE
IRENE
KNAUB KELVIN K AND
HOLLY A
KNESPEL BETTY LOU
KNOB JOANN
KNOX BILL G

KNOX LILA R
KODER LUELLA M (BN)
KOEHN BILL AND VIOLA
KOEHN SOPHIA WYNNE
KONONUK PHILIP L
KOSMICKI DAVID D
KRAMER BEVERLEY J
KRAMER ELAINE FERN
KRAMER JACK E
KRAMER JACK E AND
BEVERLY J
KRAMER LISA M
KRAMER TIM
KRANTZ KYLE S
KRAUSE MATTHEW
KREPS ROBERT D &
JEANNE M 1/2
KRL BLACK RIVER
ROYALTY - 3.21382%
KUCHMAN LAUREL AND
TODD
KUNTZ JOSEPH F
KWON LILY
KWON YOUNG JIN
LABAN ELIZABETH P
LIVING TRUST
LABONDE JACK J JR AND
SUSAN M
LAFI LLC
LAKE NANCY ANN AND
THOMAS L
LAM RESOURCES LLC
LANCASTER BLANE
LANNING STEVEN B
LARA PLACIDO S AND
DORA E
LARRY R. BESACK
LARSON L MAUREEN
LARSON MARK
LARSON MARK A
LARSON KAROLYNN S
LASART MICHAEL
MILLER PAMELA J
BOWEN ALLAN F
LASART MICHAEL
LASART SHERRY
LAURA ELIZABETH
LEONARD INSURANCE
TRUST
LAWRENCE HEATHER
HUGHES BRIAN
LAWRENCE LORA K AND
GEORGE R
LAZO ESTRADA JESUS
LEBSACK RUTH ELAINE

LECHUGA BLANCA E
LECHUGA DELIA M
LECHUGA EVERARDO
LECHUGA JOSE LUIS
LECHUGA MARIA E
LECHUGA SERGIO
LEDERMAN HEIDI
LEDERMAN JEFF
LEE ROBERT E
LEEVERS DEVELOPMENT
LLC
LEFFLER BEVERLY JEAN
LEFKOWITZ DAVID NEIL
AND WEIL JOYCE
LEI INVESTMENTS LLC
LEISHER SARAH
LENNAN MAIN LTD
LENNEMANN KERRY LEE
LEONARD O PAUL III
LESSER STEVEN E AND
ADELE M
LETH STEVEN C
LEWCHUCK JEREMY R IRA
LIBSACK TIMOTHY
LIDIAK DANIELLE RAE
LIESER RANDY LEE AKA
RANDIE LEE
LINDE STEVE W AND JERI
R
LINDSTROM DON W AND
DELORES M
LISCUM GARY A
ZONG XIFAN
LLOYD JOHN E AND
PATRICIA L
LOCKMAN RONALD J
LOCKMAN SHERYL L
LOEFFLER SANDRA L
LOHR RICHARD T
LOMA JOSE A
LOMA RAMON
LOMBARDELLI MARK E
AND ROXENE K
LOOKHART DEAN
LOPEZ ALBERTO
LUCERO BILL
LUCERO DYLAN S
LUNA REGINALDO
CONCHAS
LUNA CAROLS CONCHAS
LUNA-IBARRA ALVARO
LUNBERRY OLIVER W JR
LUNBERRY KATHY E
LUNN STEPHEN L
LUSTER AMY C

EXHIBIT A
VT-ALLES

LUTGEN LAWRENCE E
AND GREENDA L
LUTZ JEREMY
M&C HOLDINGS LLC
Mac Kenzie Enterprises, Inc.
MACHOVEC RENEE
MACKENZIE EMMETT E JR
LOVING TRUST
MACOTELA ISRAEL
CHAVEZ
MAHONEY JOHN F
MAIN LORRAINE R
MAINLAND HOLDINGS LLC
MALLARD SHEILA KAY
AND RICHARD F
MAMICH DAVID M
QUADE MARJORIE R
MANRIQUEZ DAEN
MANTLE MARGARET A
MANTLE RAY E
MANTYCH CAROL A AND
DAVID G
MARDI GRAS PROPERTIES
LLC
MARJORY A. GREENWOOD
MARQUEZ ALVARO
MARSALA FRANCES B
MARTIN E L
MARTIN ERNEST L
REVOCABLE TRUST
MARTIN JEAN M
MARTIN KENNETH J AND
DORIS E MARTIN
MARTINEZ ELIAS RAMOS
LOMA OLIVIA
MARTINEZ LUCIA T
MARTINEZ RAUL S
MASTERSON VERNA M
MASTERSON VERNON J
MATHEWS ERIN KYLE
MATHIS PHILIP A
MATTHEWS JAMES
WILLIAM
MATTHEWS MARGARET M
MAWSON RICHARD IRL II
LEVELLE WYNNE MERYL
MAYER RANDY AND
NANCY
MAYORGA GIOVANNI A
MAYORGA JOSEPH L
MAYORGA MANUELLA
MC CONNELL ALLEN W
AND CAROL K
MC GRATH JOHN I AND JO
ANN

MCCANN LINDA C
MCCLUGGAGE-HART
DANA
MCCOY HELEN C TRUST
MCCOY JAMES A JR
MCDONALD'S CORP.
MCDONALDS
RESTAURANTS OF CO INC
MCKNIGHT MARILYN J
MCMAHON MARY E
MCSWAIN LINDA S LIVING
TRUST
MCVICKER MICHAEL P
AND BARBARA S
MEDIANO SANTIAGO JR
AND BERNADETTE P
MEDINA LUPE
SEGELKE THERESA
MEDINA RAMON
MEDINA LINDA T
MEDRANO MARIA
ENRIQUETA
MEJIA SORIMELDA
SEGOVIA
MELBY DAWN M
MELBY DEWAYNE C
MENDIOLA MARIA LORETO
GOMEZ
MENDOZA YOLANDA AND
ARROYO SAMUEL
CERVANTES
MEREDITH JAMES M
MEREDITH MIRIAM A
MERRILL CHARLES S AND
MARIANNE
MEYER GEORGINA
MEYERS LETA M
MEYERS LLOYD A (HEIRS
OF)
MEZA CHRISTIAN
MICHAEL B. SMITH AND JO
ELLEN SMITH
Michael I. Schaffer
MICHELLE L. NORMAN
(BENEFICIARY GRANTEE)
MICKENS HOWARD M &
NELDA M REVOCABLE
TRUST
MIDDLETON MARK R
MIECZKOWSKI GARY A
MIECZKOWSKI MARCELLA
R
MILAN PROPERTIES LLC
MILLER DANIEL M

MILLER DAVID J AND
LINDA G
MILLER JESSE O
MILLER KENDALL K
MILLER RUBIN H
MILLER RUTH A
MILLS BRIAN C
STUCKENSCHMIDT LINDY
R
MILO GENERATIONS LP
MILO GENERATIONS LP
MOHLER JANA L
MOHNEY MICHAEL
MOLINAR JOHN JOSEPH
MOLINAR BRENDA LEE
MONDT DAVID E AND
KRISTIN E
MONHOLAND SETH
MONHOLAND CHELSEA
MONROE G T
DINNEL-MONROE
DARLENE J
MONROE G T
DINNEL-MONROE
DARLENE J
DINNEL DONALD L
DINNEL PATRICIA PARKER
MONTES ALVARO
MONTEY KEITH D AND
VIVIAN M
MONTROYA MARINO
RUMALDO JR AND
PATRICIA L
MOORE DIANA L
MOORE HAROLD L
TIPPING MADGE A
MOORE SHEILA RAE
MORGAN MICHAEL S
MORGAN SARAH E
MOSER RANDY LEE
MOSSBERG JANICE SUE
MOUNTAINS & PLAINS
APPRAISAL SERVICE INC
MUCK ALICE H
MUCK DENNIS R
MUCK DONALD H
MUNOZ BONIFACIO H AND
CYNTHIA K
MURPHY & HOFFMAN
JOINT VENTURES LP
MURPHY COLLEEN L
MYERS MARK M
NAJERA EVARISTO H
NAJERA JOSEPHINE J
NANCE JEFFREY A

EXHIBIT A
VT-ALLES

NARANJO LEO
NDIRA INC
NDIRA INC ACCT 1006811
(35% INT)
NDIRA INC ACCT 1006812
(65% INT)
NEDRA A. ZAMORA
NELSON DEBRA J
NIEHOFF PETER H AND
NANCY G
NUNO CARLOS
NYX, LLC
OB PROPERTIES LLC
OCHOA NICOLAS
OETMAN LAURETTA GALE
OGDEN LUCINDA D
OLETSKI VICKI L
OLIN MARLENE K
OLIVER ANNETTE
OPPELT PATRICIA BAST
ORD JERRY W AND
JEANNETTE L
ORLANDO ESPARZA-
GONZALEZ
OROSZ CATHERINE L
ORTEGA HILDA
ORTIZ IGNACIO
OSBORN MARCIA LEE
OSTER BONNALEE
OSTER MARK W
OTTEM DAVID R
OTTEM JULIE C
OTTO JERRY D
SAUBLE-OTTO LORIE
GWENN
OVERSON TODD
OVERTURF ELLIS E AND
JEAN E
PACHL ROBERT A AND
TAMARA LYNN
PACKARD KEITH L AND
ZELMA E
CHOATE BRENDA K
SCHAFFER KAREN G
PACKARD KEITH M
PADILLA JOSEPH R AND
NOEMI
PADILLA-HANAN LAUREL
M AND KATHY A
PAGE EVAN S AND
KIMBERLY L
PALERMO BCE LLC
PALOMARES ALONSO
PARKVIEW SOUTH
PROPERTIES LLC

PARRAVANI CHRISTEENA
ANN GROSS MARTIN
RANDALL
PATRICK RICHARD K II
PENDERGRAFT JESSICA M
PEREA ANDY
RIVERA DE NUMO SARA
PERL DONALD A
MARSHALL MIRIAM
ANNETTE
PERRICH LINDA R
PERRICH ROBERT A
PERRINE JOHN R
WILSON BEATRIX G
PERRY CAROL J
PETERSON BRENT M
PETERSON NATALIE J
PETREA MICHAEL D
PETTENGILL STAN A
PFANKUCH JOHNSTOWN
VENTURE LLC
PHILLIPS LIVING TRUST
DONALD G AND DONA S
PHILLIPS MARK L AND
FORREST E
PIERCE LOWEL E TRUST
PIETRYKA WAYNE
RICHARD
PINKSTAFF CARL D AND
MARY E
PIONEER POST CLUB OF
GREELEY
POTTER CINDY L
POUDRE VALLEY LODGE
No. 12 THE
POWELL SHANE
POWER DOWN LLC
PRESTON RONALD L
PRICE DAVID C
PRO GLASS & PAINT
PRO GLASS & PAINT LLP
PROPERTY ASSOCIATES
LLLP
PUBLIC SERVICE CO COLO
PULDA RANDY L AND
HELEN M
PVEATTE MICHAEL A
QUINBY JESSE L AND
REBECCA E
RAGSDALE FRANK J
RAISLEY DEBRA S
RAISLEY DENA K
RAISLEY JEFF G
RAISLEY JERRY
RAKOWSKI MITCHELL R

RAKOWSKI DIANE M
RAMOS ENRIQUE FLORES
RANDALL FRANK
HENDERSON JR
RARE ENERGY LLC
RASTATTER DAVID
PATRICK
MANRING RACHEL LOUISE
RCL INC
REA CHARLES (HEIRS OF)
REA DONNA M
REAM MARGARET E
REED JACQUELYN C
REED NORENE S
REED ROBERT W
REED ROSS M AND
DANIELLE
REGAL INVESTMENT
PROPERTIES LLC
REIBER BRADEN A
REIBER CHERYL A
REIBER DAVID V
REIF CASEY A
REINERT BRENNAN AND
ELAINE
REINERT MARY ANN
TRUST DATED MAR 15
1993
REITEN ALTON C AND
CAROLE S
REYES CAROLINA
ANALCO PABLO
REYES GUADALUPE
REYES MARIA S
REYES SAUL
REYES MARIA LUCILA
CONTRERAS REYES NOEL
IVAN
REYNOLDS SCOT ALAN
RHINE CHARLES D AND
BARBARA B
RHOADES MAGDALENA
ANITA
RICE MIKE
RICH APRIL M
RICH ARTHUR W JR
RICHARDSON ARLO L AND
CHRISTINE L
RICHMARK DEVELOPMENT
LLC
RICHMARK MINERAL
PARTNERS, LLC
RICKERS KENT
RIDDLE KENNITH B AND
MARILYN E

EXHIBIT A
VT-ALLES

RIGG TONI J
RIOJAS JAIME
RIOJAS MARIA D
RIOTT JOHN W
RIOTT SHARLA L
RIZO REFUGIO
RIZO DOLORES
RIZO YVONNE V
DOMINGUEZ ANGELO A
RJ&C INVESTMENTS LLC
ROBINS MICHAEL T
HENDERSON RANDALL R
ROBISON THOMAS C
RODRIGUEZ ADAM
ORTEGA JENNIFER
RODRIGUEZ GABRIEL T
RODRIGUEZ VELIA
RODRIGUEZ JOSE A
RODRIGUEZ JUAN M
DE LOS ANGELES
RODRIGUEZ MARIA
RODRIGUEZ KRISTY J
ROGAKIS THERESA J
ROGERS JOHN C
ROGERS ANGELA M
THORNE MICHELE L
ROGERS MICHAEL W AND
RHODA FAITH
ROMERO RAMON G
GARCIA MARIA LUZ
ROSALES OBED ROJAS
ROSENBLOOM PERRY
ROSENGRANTS MARK A
MAES SHARON KAY
ROSENOFF ROBERT
LEROY
ROSSMAN KAREN L
ROTH MIRIAM
ROTH RAYMOND E
ROTH VERDA D
ROWLAND BILLY J
ROYBAL SAMMIE
ROYBAL URSULA
RPM HOLDINGS LLC
RPM PROPERTIES RLLLP
RUDD RONALD B, B A AND
COLLET K
RUIBAL DIANA LYNN
RUIZ KATHY
RUIZ CARLOS
RUPPERT DAVID C
RUSCH GARY LEE AND
VICKI L
RUYLE LYDIA M
REVOCABLE TRUST

RYLAND ROYALTY
SAENZ DULCES N
HERNANDEZ
HERNANDEZ LORENZA
SAENZ LOIDA AGUIRRE
SALAZAR CONSUELO
SALAZAR DOMINGO SR
SALL CLARENCE P AND D
DARLENE
SANCHEZ BELINDA
SANCHEZ CHRISTINE A
SANCHEZ EUGENIO JR
SANCHEZ HELEN
SANCHEZ HELEN A
SANDERS DANNY L AND
SHERRY L
SANDOVAL CLARENCE J
SATER JARRED
SATHER ROSE ANNE AND
DAVID
SAURINI DAVID M
SAURINI DIANE K
SAURINI FALON G
SAV-O-MAT INC
SAYOTOVICH J T
SCHAEFER
REHABILITATION CENTER
INC
SCHELL DONALD J AND
BEVERLY A
SCHMIDT WILLIAM H
SCHMITT LYNN F
SCHMITT PATSY L
SCHNEIDER EDWARD E
SCHNEIDER REBECCA
GAY
SCHOOL DIST No. 6
SCHOTT BRENDA
SCHOTT RONALD E
SCHUCH KAYLA M,
MICHAEL J AND BRENDA M
SCHULTE CATHY L
SCHULTE DENNIS L
SCHULTE JOHN C AND
CHERYL D
SCHULTZ KIMBERLY KAY
SCHUMAN DEAN D AND
PHYLLIS M
SCHWEERS DAVID H AND
AMY S
SEARS JENNIFER D
SEDILLOS JOE JR
SEDILLOS OFELIA GLORIA
SELF BILLY D AND
LORENA M

SERRANO CRISTIAN
BANUELOS
SHADE WILLIAM E
SHATRAW LOWELL M
SHAW BARBARA A
SHAW JAMES L
SHEETS JUNE M
SIEGEL ERIN F
SIEGEL MINDY H
SIEGEL RICHARD N
SILVERMAN PAULA A
SILVERMAN RICHARD
ALAN
SIMER JIMMY D
SIMPSON DANA T
SIMPSON FRANK E AND
MAXINE H
SJOBORG ROBERT K
SKAAR STEVEN K
SLAYMAKER JEFF D
SLEIGHT BEVERLY GRACE
SLEIGHT RANDALL
BRADFORD
SLUYTER ZACHARY
SMITH CHAD A
SMITH GEORGE R AND
SHIELA C
SMITH GEORGE W
SMITH MICHAEL A
SMITH NANCY H
SMITH RICHARD D SR
SNYDER ALLAN D
SNYDER CHRISTOPHER C
SNYDER SHERRY L
SOCIETY DBA
SODMAN KELLY W AND
EVA RHEA A
SOLEIMANPOUR SORAYA
AND MEHDI
SOTELO MARIA T
SOTELO JUAN U
SOTO ELISEO
RUIZ LUZ MARIA
SOTO PAULINE LIVING
TRUST UTD
SOTO RAMON
RAMOS DO CASTRO OLGA
SOULONG SALAMAH
SOUTH COYOTE
JUNCTION LLC
SOUTHERN FOODS
GROUP LP
SPARKS DAVID O
SPARKS DAVID O

EXHIBIT A
VT-ALLES

SPECIAL TRUSTEE FOR
OUT OF CALIFORNIA
PROPERTY, SUCCESSOR
TRUSTEE OF TRUST B
8/2/1978
SPENCER BRENT D AND
JHOVANA VARGAS
SPERRY PATRICK D AND
NORENE K
SPIGHT DOUGLAS G
SPIGHT LISA R
SPIKA KAREN L
SPONAUGLE RICK L AND
TERESA K
SSMD LLC
STANLEY GWENDOLYN
STANSKE ROBIN K
STEEL JAMES W AND
SHARON A
STEELE TERESA K
STEVENS DORA JEAN
STEVENSON JUSTIN T
STILLWATER/GREELEY
LLC
STINSON ALAN
STINSON JULIE
STOLTE HELEN O
STONE TIMOTHY R AND
ALETA
STOTTS HARRIS
STOUT JAMES R
STOUT ONETA E
STREET STEPHEN P
STREET SHAWNA M
STUART TODD M AND AMY
P
SULLIVAN AMBER L
SULLIVAN JENNIFER L
SULLIVAN JOHN W
SULLIVAN PAUL C
SUMEARLL JOEL D
SUMEARLL JOEL D IRA
SUMERFORD ASHLEY M
SUSAN ELAINE
CROISSANT
SWANSON JUDITH R
SWOPE NANCY L
T & B HOLDINGS LLC
TACO JOHNS
INTERNATIONAL INC
TALAMANTES JUAN
TALL GRASS ENERGY LLC
TARANTO JOHN H
TARANTO RENICE
TAYLOR NOMA

TAYLOR PATRICK KELLY
TAYLOR SHARON K
THE JOHN WM. AND JOAN
JOINER HARRISON
REVOCABLE TRUST
DATED 1/6/2000
THE SUMMERS FAMILY
TRUST
THOMAS KEVIN M
THOMAS SURVIVORS
TRUST
THOMAS WENDY M
THOMPSON CYNTHIA
SMITH MATTHEW R
SMITH SPENCER K
THOMPSON DEAN AND
VENEVA
THOMSEN RYAN L
THORNTON JACK NIELSON
AND SYLVIA
THRAPP JOAN A
THREE BEARS LLC
TIM KRAMER & STEVE
COOPER PROPERTY
MGMT
TODD ALEXANDER F
TODD CAROL A
TODD CHERYL
TODD GREGORY L
TODD WILLIAM W
TOEPFER ALLEN L AND
BILLIE K
TRAN AM SOAI
TRAN FRED
TRASK CY J
TRIGOS MARTIN DAVID
TRIGOS MARIA CARMEN
TRIMAC
TRANSPORTATION
CENTRAL INC
TRIMBER CYNTHIA J
TRINH MINH HUE
TRINITY RESOURCES LLC
- 10%
TROWBRIDGE DOROTHEE
K TRUST
TRUEMAN TRAVIS A
TRUMBO STEVEN C AND
SARAH J
TURNER MONOLITO M
TURNER SHALA
TWENTIETH AVE 2218 LLC
TWO RIVERS.FELLOWSHIP
UHRIG ALFRED H AND
ELAINE

UNION COLONY BANK
United States of America
UPTON ELIZABETH ANN
V F W No. 2121
VALLEJO CRYSTAL M
MORA RAUL VALLEJO
VAN ASSELT STEVEN
VAN ASSELT KATHRYN
WATKINS
VAN HERWAARDEN
JACOBUS C AND ODETE H
VASQUEZ JULIAN
VASQUEZ LORENZO
VEDAS INVESTMENTS LLC
VELAZQUEZ DE LA CRUZ
SOTERO
GARCIA MARTINEZ
CANDELARIA MARIA
VERETTO PATRICIA A
VERETTO CATHI LEA
VERETTO JIMMY CHARLES
FRITZ CORINNA SUE
VERVERS CINDY
VESTECKA JENNIFER M
VESTECKA JOHN P
VICKROY DONNA J
VIGIL MARY ANN
VILLALOBOS MAYRA Z
VILLALOBOS ALEJANDRO
VILLANUEVA MELITON
VILLANUEVA REYNALDO
VILLANUEVA TERESA C
VILLELA JOSE ANTONIO
VOGEL FRANCIS H AND
LINDA R
VONK JULIANNE JEAN
VOSS CALVIN K
WADSWORTH CHARLEY G
AND TERRY E
WAGG ERIK O
WAGG RUTH E
WAGNER ARLENE CAROL
WAKKINEN HOWARD B
WALL LISA G
WALLACE RICK L
WALLEN WOOD BETTY
JANE
WALSH JOHN P
WALSH ANN MARIE
WALTER CATHLEEN R
WALTER EDDIE G
WALTER EDDIE G AND
NANCY V
WALTER JAMIN B
WALTER NANCY V

EXHIBIT A
VT-ALLES

WALTER SCOTT
WAREHIME CODY L
WARNER RUTH V
WARREN LAND INC
WASILIK BERNADETTE
WASSON ROBERT
EDWARD AND PATRICIA
ANN
WBJP 5, LLC
WEAVER HEIGHTS
ASSOCIATION INC
WEBER DORIS E
WEIMER MARK A AND
KRISTI L
WEINMEISTER DONALED E
FAMILY TRUST TRUST
WEISER PHILIP J
WEISER PHILIP N
WELCH ANDREW THOMAS
WELLS RANCH LLLP
WERNER JUDITH E
WERTZ LORENA M
WESTCO FAMILY LIMITED
PARTNERSHIP
WESTERN EQUIPMENT &
TRUCK INC
WESTON CHARLES K AND
PATRICIA A
WHEELER MARGARET J
WHEELER PROPERTIES
LLC
WHEELER SHIRLEY M
WHITAKER HEATHER
SHADDEAU BRENT
WHITCOMB VERA M
WHITE DENISE I
WHITE ELEPHANT LLC
WHITE PHILIP R
WHITE PHILIP R AND
DENISE
WIEDEMAN TERRY L &
JANICE L 1/2 INT
WIEGAND EDWARD L AND
GRETCHEN L
WIGHT LAURA M
WILCZYNSKI TED J
WILCZYNSKI TOM
WILD JEFFREY T
WILD KEVIN J
WINKLER JAMES N AND
JANET K
WIRICK EDWARD R AND
ELISABETH P
WIRTH AMELIA MARIE

WISCHMEIER FAMILY
TRUST DTD 12/17/2014
WISNEWSKI BETHEL
WISNEWSKI JERRELL
WOLF BERNICE
WOLF RICHARD
WOODFIN THOMAS W
WOODRUFF
CHRISTOPHER M AND
KAROLINE J
WRIGHT JON MICHAEL
WYNN KENDE S
WYNN ROBERT T
WYNN TREVOR N
YASMAR LLC
YAWS CLINTON AND
STEFANIE
YOST JACKIE AND LANA
YOUNG HAROLD S
ZAMARRIPA EDUARDO
ZAMORA ELOY J AND SUE
ANN
ZENDEJAS MIGUEL
PAYAN ANN MARIA
ZIEDINS AIVARS
ZIEMAN CHARLES E AND
ANITA L
ZIGMAN MARVIN AND LOIS
BEBE TRUST 11/30/1989
ZIMMERMAN DONALD L
TRUST
ZIMMERMAN NANCY C
(BN)
ZIMMERMAN SCOTT A
ZIMMERMANN MARJORIE
MAY

SPACING UNIT: S/2 N/2 & N/2 S/2 SEC 18, S/2 N/2 & N/2 S/2 SEC 17, S/2 NW/4 & N/2 SW/4 SEC 16, T5N, 65W UNIT ACREAGE: 800

NAME: ALLES

WELL NAME	SURFACE LOCATION			LANDING POINT\BEGIN HORIZONTAL COMPLETION ZONE			BOTTOM HOLE\END HORIZONTAL COMPLETION ZONE			COMPLETION ZONE BEARING	COMPLETION ZONE LENGTH
	DIST.	DIR.	FWL	DIST.	DIR.	FWL	DIST.	DIR.	FWL		
VT-ALLES 1-16-18	2006'		472'	2372'		2189'	2332'		460'	S89°48'42"W	12294.75'



0 2000
SCALE: 1" = 2000'
U.S. SURVEY FEET

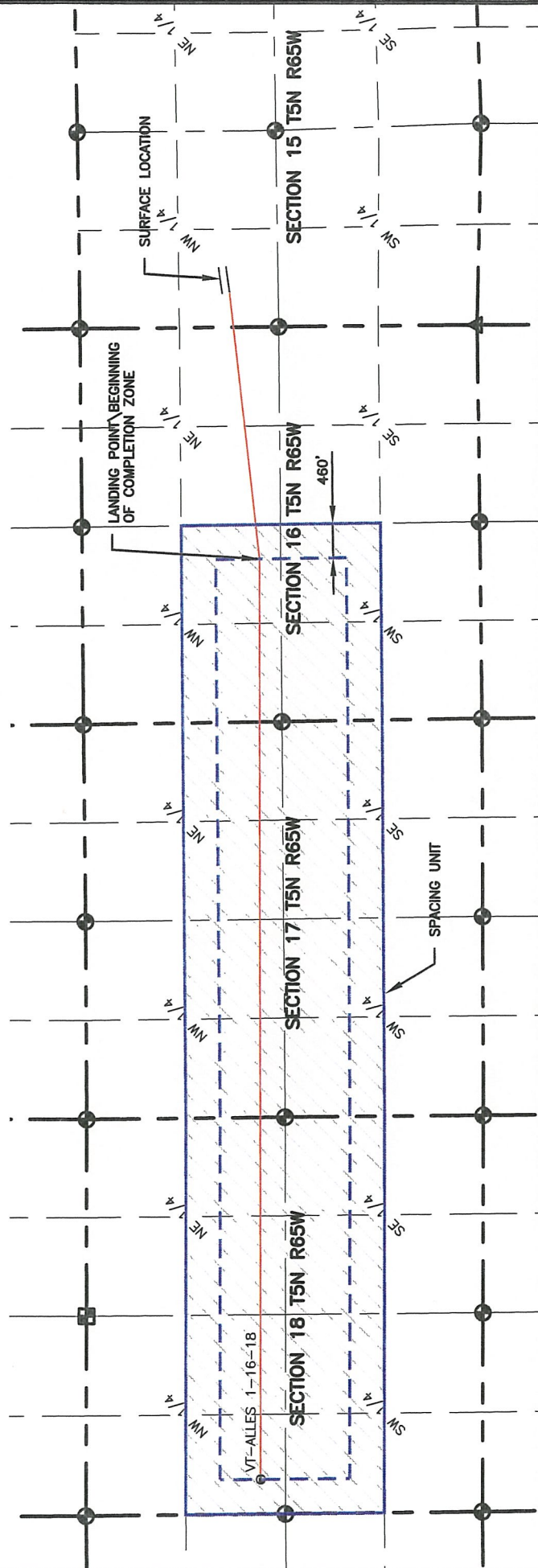

LEGEND

- ⊕ ALIQUOT CORNER
- ⊙ BOTTOM HOLE
- ⊙ COMPUTED ALIQUOT CORNER FROM MONUMENT ACCESSORIES
- ⊙ COMPUTED FROM GLO RECORDS

PLANNED SPACING UNIT EXHIBIT
VETTING 15-H

ALLES SPACING UNIT

SURFACE - LOCATION
SW /4, NW /4, SEC 15 T5N R65W

4715 Innovation Drive 970.226.0342 | P
Fort Collins, CO 80525 970.226.0879 | F
www.LRA-inc.com



BOOK AND PAGE
MRI-04 PG-6

PROJECT - TASK NUMBER
0215036.00

COGCC ID

DATE
10/30/15

DRAWN BY
KJW

PATH\FILENAME

P:_Engineering\0215036_Vetting_15_H\DRAWINGS\EXHIBITS\0215036PSU-ALLES.dwg

BEFORE THE OIL AND GAS CONSERVATION COMMISSION
OF THE STATE OF COLORADO

IN THE MATTER OF THE APPLICATION OF)
EXTRACTION OIL & GAS, LLC FOR AN ORDER)
POOLING ALL INTERESTS IN THE NIOBRARA)
FORMATION IN ONE 800-ACRE WELLBORE)
SPACING UNIT COVERING CERTAIN LANDS)
IN SECTIONS 16, 17 AND 18, TOWNSHIP 5)
NORTH, RANGE 65 WEST, 6TH P.M.,)
WATTENBERG FIELD, WELD COUNTY,)
COLORADO.)

Cause No. 407
Docket No. 160800326
Type: POOLING

AFFIDAVIT OF MAILING

STATE OF COLORADO §
CITY AND COUNTY OF DENVER §

I, Joseph C. Pierzchala, of lawful age, and being first duly sworn upon my oath, state and declare:

That I am the attorney for Extraction Oil & Gas, LLC and that on or before July 8, 2016, I caused a copy of the attached Application to be deposited in the United States mail, postage prepaid, addressed to the parties listed on Exhibit A to the Application.

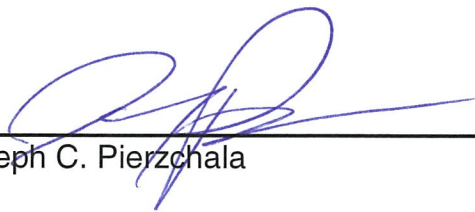

Joseph C. Pierzchala

Subscribed and sworn to before me July 8, 2016

Witness my hand and official seal.



Notary Public
My commission expires: 8/29/2017

