



02617442

FORM 31 Rev 6/99

State of Colorado Oil and Gas Conservation Commission

1120 Lincoln Street, Suite 801, Denver, Colorado 80203 (303)894-2100 Fax:(303)894-2109



RECEIVED FOR OGCC USE ONLY DEC 15 2011 COGCC

UNDERGROUND INJECTION FORMATION PERMIT APPLICATION

Complete the Attachment Checklist Oper OGCC

- 1. Submit original and one copy of this form.
2. If data on this form is estimated, indicate as such.
3. Attachments - see checklist and explanation of attachments.
4. Aquifer exemption is required for all injection formations with water quality <10,000 TDS (Rule 322B).
5. Attach a copy of the certified receipt to each notice to surface and mineral owner(s) or submit a sample copy of the notice and an affidavit of mailing or delivery with names and addresses of those notified.

Attachment Checklist table with items like 'Form 31 Original & 1 Copy', 'Analysis for Injection Zone Water', 'Proposed Injection Program', etc.

Project Name: PWD Federal 21-6-91 Project Location: 7 miles south of Silt, Colorado
Project Type: [] Enhanced Recovery [x] Disposal [] Simultaneous Disposal
Single or Multiple Well Facility? [x] Single [] Multiple
IF UNIT OPERATIONS, ATTACH PLAT SHOWING UNIT AREA
County: Garfield Field Name and Number: Kokopelli, 47525

SWSE 2165 91W 6

OGCC Operator Number: 10301
Name of Operator: Dejour Energy (USA) Corporation
Address: 1401 Seventeenth Street, Suite 1000
City: Denver State: CO Zip: 80202

Contact Name and Telephone: Gary Haefele
No: 303-296-3535
Fax: 303-296-3888

Injection Fluid Type: [x] Produced Water [] Natural Gas [] CO2 [] Drilling Fluids
[] Exempt Gas Plant Waste [] Used Workover Fluids [] Other Fluids (describe):
Commercial Facility? [] Yes [x] No
If Yes, describe area of operation and types of fluids to be injected at this facility:

PROPOSED INJECTION FORMATIONS
FORMATION A (Name): Williams Fork Formation, Iles Member Porosity: 8% estimated
Formation TDS: _____ Frac Gradient: 0.6 estimated psi/ft Permeability: 0.5-1.0 md estimated
Proposed Stimulation Program: [] Acid [] Frac Treatment [] None
FORMATION B (Name): _____ Porosity: _____
Formation TDS: _____ Frac Gradient: _____ psi/ft Permeability: _____
Proposed Stimulation Program: [] Acid [] Frac Treatment [] None

Anticipated Project Operating Conditions
Under normal operating conditions, estimated fluid injection rates and pressures:
FOR WATER: A minimum of 200 bbls/day @ 1300 psi to a maximum of 1600 bbls/day @ 1600 psi.
FOR GAS: A minimum of _____ mcf/day @ _____ psi to a maximum of _____ bbls/day @ _____ psi.

I hereby certify that the statements made in this form are, to the best of my knowledge, true, correct, and complete.

Print Name: Gary Haefele Signed: [Signature]
Title: Operations Manager Date: 11/15/2011

OGCC Approved: _____ Title: _____ Date: _____

UIC FACILITY NO: 159381

Order No: _____
CONDITIONS OF APPROVAL, IF ANY:



02617443

FORM 33 Rev 5/99

State of Colorado Oil and Gas Conservation Commission

1120 Lincoln Street, Suite 801, Denver, Colorado 80203 (303) 894-2100 Fax: (303) 894-2109



FOR OGCC USE ONLY
RECEIVED
DEC 15 2011
COGCC

INJECTION WELL PERMIT APPLICATION

Submit a completed Form 33 with or after approval obtained on Form 31 (Underground Injection Permit Application) or you must have a previously approved Injection Well Permit.

1. Operator may not commence injection into this well until this form is approved.
2. Each individual injection well must be approved by this form.

Well Name and Number: PWD Federal 21-6-91 API No: _____
 UIC Facility No: _____ (as assigned on an approved Form 31)
 Project Name: PWD Federal 21-6-91 Operator Name: Dejour Energy (USA) Corporation
 Field Name and Number: Kokopelli; 47525 County: Garfield
 Qtr: SWSE Sec: 21 Twp: T6S Range: R91W Meridian: 6th

Complete the Attachment Checklist

	Oper	OGCC
Current Wellbore Diagram		
Proposed Wellbore Diagram		

CURRENT WELLBORE INFORMATION

	SIZE	DEPTH	NO. SACKS	CEMENT TOP	Cement Top Determined By:		
					CBL	CIRCULATED	CALCULATED
Surface Casing	8 5/8	1500	800	Surface	<input type="checkbox"/>	<input checked="" type="checkbox"/>	<input type="checkbox"/>
Intermediate Casing (if any)					<input type="checkbox"/>	<input type="checkbox"/>	<input type="checkbox"/>
Production Casing	4 1/2	9050	665	1300	<input type="checkbox"/>	<input checked="" type="checkbox"/>	<input type="checkbox"/>

Plug Back Total Depth: _____ Tubing Depth: _____ Packer Depth: _____

WFILS _____ Formation Gross Perforation Interval: _____ to _____

_____ Formation Gross Perforation Interval: _____ to _____

_____ Formation Open Hole Interval (if any): _____ to _____

List below all Plugs, Bridge Plugs, Stage Cementing or Squeeze Work performed on this wellbore: (if more space needed, continue on reverse side of this form.)

1. _____
2. _____
3. _____
4. _____

Describe below any changes to the wellbore which will be made upon conversion. (This includes but not limited to changes of tubing and packer setting depths, any additional squeeze work for aquifer protection or casing leaks, setting of bridge plugs to isolate non-injection formations.)

1. Well is to be drilled and completed as an injection well. No changes are anticipated
2. _____
3. _____
4. _____

Comments: _____

I hereby certify that the statements made in this form are, to the best of my knowledge, true, correct, and complete.

Print Name: Gary Haefele

Signed: _____ Title: Operations Manager Date: 11/15/2011

OGCC Approved: _____ Title: _____ Date: _____

MAX. SURFACE INJECTION PRESSURE: _____ If Disposal Well, MAX. INJECTION VOL. LIMIT: _____

CONDITIONS OF APPROVAL, IF ANY:

State of Colorado
Oil and Gas Conservation Commission

1120 Lincoln Street, Suite 801, Denver, Colorado 80203 (303)894-2100 Fax:(303)894-2109

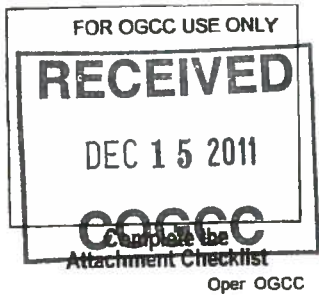

UNDERGROUND INJECTION FORMATION PERMIT APPLICATION

1. Submit original and one copy of this form.
2. If data on this form is estimated, indicate as such.
3. Attachments – see checklist and explanation of attachments.
4. Aquifer exemption is required for all injection formations with water quality <10,000 TDS (Rule 322B). Immediately contact the Commission for further requirements if the total dissolved solids (TDS) as determined by water analysis for the injection zone is less than 10,000 ppm.
5. Attach a copy of the certified receipt to each notice to surface and mineral owner(s) or submit a sample copy of the notice and an affidavit of mailing or delivery with names and addresses of those notified. Each person notified shall be specified as either a surface or mineral owner as defined by C.R.S. 34-60-103(7).

Form 31 Original & 1 Copy	✓
Analysis to Injection Zone Water	
Analysis of Injection Water	
Proposed Injection Program	
Resistivity or Induction Log	
Cement Bond Log	
Surface or Salt Water Displ Agmt	
Notice to Surface/Mineral Owners	✓
Remedial Correction Plan for Wells	
Map Oil/Water Wells w/in 1/4 Mile	✓
List Oil/Gas Wells w/in 1/2 Mile	
Map Surface Owners w/in 1/4 Mile	
List Surface Owners w/in 1/4 Mile	
Map Mineral Owners w/in 1/4 Mile	
List Mineral Owners w/in 1/4 Mile	
Surface Facility Diagram	
Wellbore Diagram	
If Commercial Facility, Description of Ops & Area Served	
Unit Area Plat	

Project Name: PWD Federal 21-6-91 Project Location: 7 miles south of Silt, Colorado
 Project Type: Enhanced Recovery Disposal Simultaneous Disposal
 Single or Multiple Well Facility? Single Multiple
 IF UNIT OPERATIONS, ATTACH PLAT SHOWING UNIT AREA
 County: Garfield Field Name and Number: Kokopelli, 47525

OGCC Operator Number: 10301
 Name of Operator: Dejour Energy (USA) Corporation
 Address: 1401 Seventeenth Street, Suite 1000
 City: Denver State: CO Zip: 80202
 Contact Name and Telephone: Gary Haeefe
 No: 303-296-3535
 Fax: 303-296-3888

Injection Fluid Type: Produced Water Natural Gas CO₂ Drilling Fluids
 Exempt Gas Plant Waste Used Workover Fluids Other Fluids (describe): _____
 Commercial Facility? Yes No
 If Yes, describe area of operation and types of fluids to be injected at this facility:

PROPOSED INJECTION FORMATIONS
 FORMATION A (Name): Williams Fork Formation, lles Member Porosity: 8% estimated
 Formation TDS: _____ Frac Gradient: 0.6 estimated psi/ft Permeability: 0.5-1.0 md estimated
 Proposed Stimulation Program: Acid Frac Treatment None
 FORMATION B (Name): _____ Porosity: _____
 Formation TDS: _____ Frac Gradient: _____ psi/ft Permeability: _____
 Proposed Stimulation Program: Acid Frac Treatment None
Anticipated Project Operating Conditions
 Under normal operating conditions, estimated fluid injection rates and pressures:
 FOR WATER: A minimum of 200 bbls/day @ 1300 psi to a maximum of 1600 bbls/day @ 1600 psi.
 FOR GAS: A minimum of _____ mcf/day @ _____ psi to a maximum of _____ bbls/day @ _____ psi.

I hereby certify that the statements made in this form are, to the best of my knowledge, true, correct, and complete.
 Print Name: Gary Haeefe Signed: [Signature]
 Title: Operations Manager Date: 11/15/2011

OGCC Approved: _____ Title: _____ Date: _____
 Order No: _____
CONDITIONS OF APPROVAL, IF ANY:

UIC FACILITY NO: _____



**State of Colorado
Oil and Gas Conservation Commission**

1120 Lincoln Street, Suite 801, Denver, Colorado 80203 (303) 894-2100 Fax: (303) 894-2109

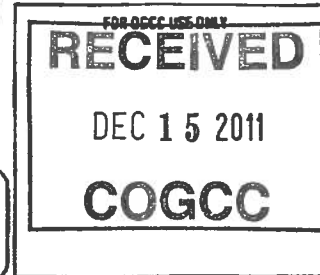

INJECTION WELL PERMIT APPLICATION

Submit a completed Form 33 with or after approval obtained on Form 31 (Underground Injection Permit Application) or you must have a previously approved Injection Well Permit.

- Operator may not commence injection into this well until this form is approved.
- Each individual injection well must be approved by this form.

Well Name and Number: PWD Federal 21-6-91 API No: _____
 UIC Facility No: _____ (as assigned on an approved Form 31)
 Project Name: PWD Federal 21-6-91 Operator Name: Dejour Energy (USA) Corporation
 Field Name and Number: Kokopelli; 47525 County: Garfield
 Qtr/Sec: SWSE Sec: 21 Twp: T6S Range: R91W Meridian: 6th

Complete the Attachment Checklist

	OGCC
Current Wellbore Diagram	
Proposed Wellbore Diagram	

CURRENT WELLBORE INFORMATION

	SIZE	DEPTH	NO. SACKS	CEMENT TOP	Cement Top Determined By:		
					CBL	CIRCULATED	CALCULATED
Surface Casing	8 5/8	1500	800	Surface	<input type="checkbox"/>	<input checked="" type="checkbox"/>	<input type="checkbox"/>
Intermediate Casing (if any)					<input type="checkbox"/>	<input type="checkbox"/>	<input type="checkbox"/>
Production Casing	4 1/2	9050	665	1300	<input type="checkbox"/>	<input checked="" type="checkbox"/>	<input type="checkbox"/>

Plug Back Total Depth: _____ Tubing Depth: _____ Packer Depth: _____
 WFILS _____ Formation Gross Perforation Interval: _____ to _____
 _____ Formation Gross Perforation Interval: _____ to _____
 _____ Formation Open Hole Interval (if any): _____ to _____

List below all Plugs, Bridge Plugs, Stage Cementing or Squeeze Work performed on this wellbore: (if more space needed, continue on reverse side of this form.)

- _____
- _____
- _____
- _____

Describe below any changes to the wellbore which will be made upon conversion. (This includes but not limited to changes of tubing and packer setting depths, any additional squeeze work for aquifer protection or casing leaks, setting of bridge plugs to isolate non-injection formations.)

- Well is to be drilled and completed as an injection well. No changes are anticipated
- _____
- _____
- _____

Comments: _____

I hereby certify that the statements made in this form are, to the best of my knowledge, true, correct, and complete.

Print Name: Gary Haeefe
 Signed: Title: Operations Manager Date: 11/15/2011

OGCC Approved: _____ Title: _____ Date: _____

MAX. SURFACE INJECTION PRESSURE: _____ If Disposal Well, MAX. INJECTION VOL. LIMIT: _____

CONDITIONS OF APPROVAL, IF ANY:

T. 6 S., R. 91 W., 6th P.M.

N 89°47'53" W 2662.44' (Calc.)

N 89°33'42" W 2664.96' (Calc.)

Found Aluminum Cap
"LS 27925" 2008
Properly Marked

OPERATOR: *Dejour Energy (USA) Corp.*

RECEIVED
DEC 15 2011
COGCC

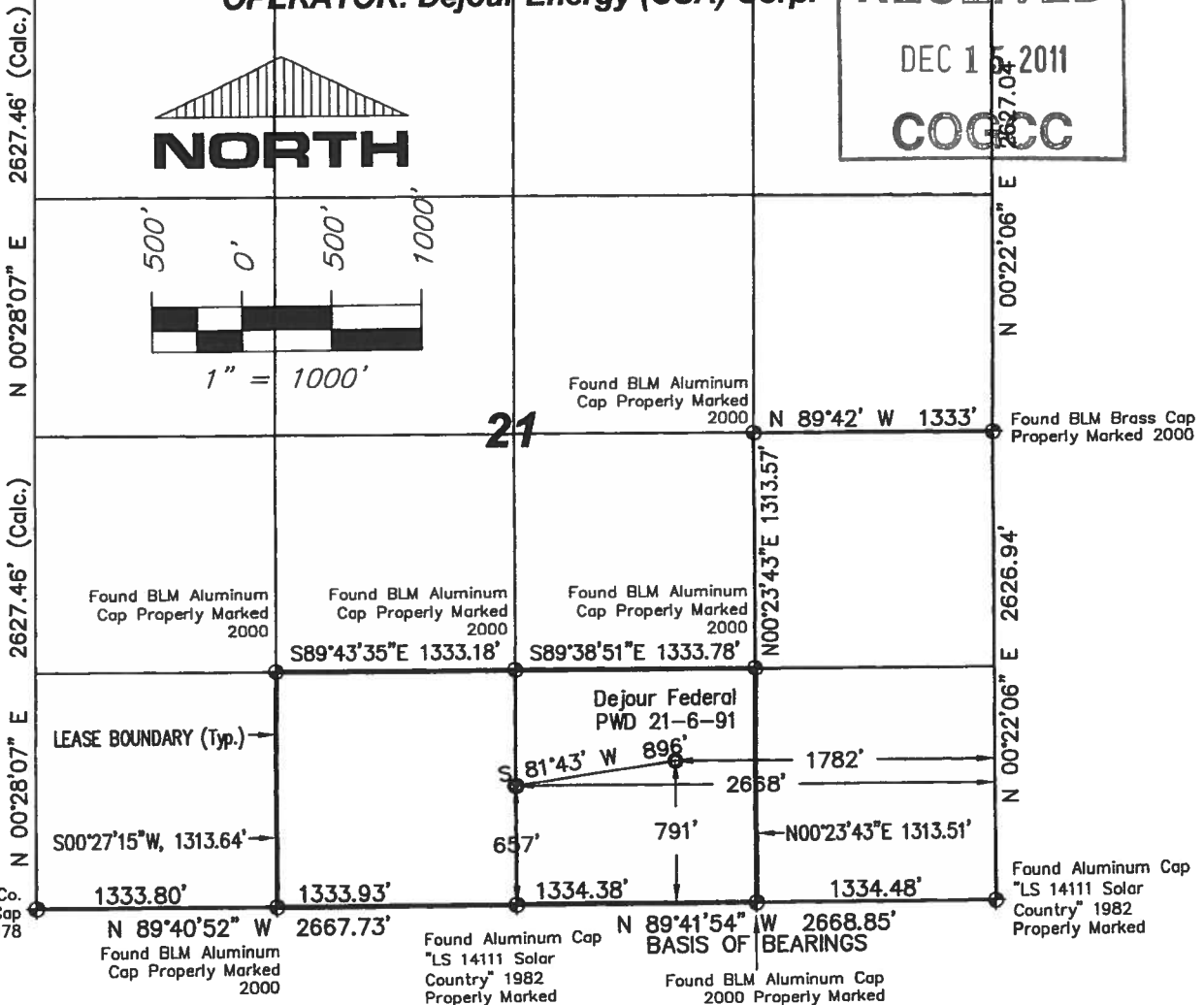

NOTES:

- 1: GEODETIC POSITIONS ARE SHOWN IN DECIMAL DEGREES BASED ON NAD83.
- 2: UNITS OF MEASUREMENT: U.S. SURVEY FOOT
- 3: EXISTING GROUND ELEVATION: 7009.5'. PROPOSED PAD ELEVATION: 7008.0'. ELEVATIONS HAVE BEEN DERIVED USING GPS OBSERVATIONS, GEOID 08, NAVD 88.
- 4: ALL TOP AND BOTTOM OF HOLE LOCATIONS ARE MEASURED AT 90° ANGLES FROM SECTION LINES.
- 5: BASIS OF BEARINGS: N 89°41'54" W BETWEEN FOUND MONUMENT AS SHOWN HEREON.
- 6: SEE SHEET 1E FOR EXISTING IMPROVEMENTS LOCATED IN THE VICINITY OF PROPOSED WELL.
- 7: SURFACE USE: RANGELAND
- 8: USGS QUAD MAP: NEW CASTLE
- 9: GPS OPERATOR: KYLE TESKY OBSERVED AN AVERAGE PDOP OF ≤ 3.0 FOR ALL SURVEY MEASUREMENTS DEPICTED ON THIS AN SUBSEQUENT SHEETS. ALL GPS OBSERVATIONS ARE IN COMPLIANCE WITH COGCC RULE NO. 215

FEDERAL PWD 21-6-91 NAD83	
SURFACE HOLE LOCATION	SECTION LINE TIES
LATITUDE = 39.508541°N	FEL = 1782'
LONGITUDE = 107.556063°W	FSL = 791'
BOTTOM HOLE LOCATION	
LATITUDE = 39.508131°N	FEL = 2668'
LONGITUDE = 107.559195°W	FSL = 657'

LEGEND:

- ⊕ - FOUND MONUMENT AS DESCRIBED HEREON
- - SURFACE HOLE LOCATION (SHL)
- ⊙ - BOTTOM HOLE LOCATION (BHL)

SURVEYORS STATEMENT

I, ELWOOD BARRY GILES, BEING A REGISTERED LAND SURVEYOR IN THE STATE OF COLORADO, DO HERBY CERTIFY THAT THIS PLAT REPRESENTS A SURVEY PERFORMED BY ME OR UNDER MY DIRECT SUPERVISION BETWEEN APRIL, 2010 & JANUARY, 2011, AND IS TRUE TO THE BEST OF MY KNOWLEDGE AND BELIEF. THE REFERENCE POINT WAS STAKED IN THE FIELD AS SHOWN HEREIN APRIL 21, 2010.

Elwood Barry Giles
ELWOOD BARRY GILES
COLORADO LS 38150
DATE: 12/13/2011

Revised 12/13/11: Correct Bottom Hole label in table

	SGM INC. 118 W. 6th Street, Suite 200 Glenwood Springs, Co. 81601 (970)945-1004 www.SGM-Inc.com 320 Third St. Meeker, Co. 81641	1" = 1000' Sheet 1F of 9 PWD 21-6-91	Well Location Plat - Federal PWD 21-6-91 SW¼SE¼, Section 21, T.6S., R.91W., 6TH P.M.
	Job# 2010-112.001 Date: 5/12/2011 By: BG File: APD-SWSE_Sec21		

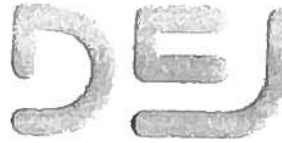

Dejour Energy (USA) Corp.
A subsidiary of Dejour Energy Inc.
1401 17th St., Ste. 1000
Denver, CO 80202
P: (303) 296-3535
F: (303) 296-3888

October 10, 2011

Richard and Mary Jolley Family LLLP
c/o: Mr. Kent Jolley
832 Canyon Creek Road
Glenwood Springs, CO 81601

COPY

RECEIVED

DEC 15 2011

COGCC

**RE: Dejour Drilling Pad 21A
Portion of BLM Lease COC-66370
Section 21: SW/4SE/4, SE/4SW/4
Township 6 South-Range 91 West of the 6th P.M.
Garfield County, CO**

Dejour Energy (USA) Corp. hereby provides you, as offset surface Landowner, "advance notice" pursuant to Colorado Oil and Gas Conservation Commission ("COGCC") Rule 305e. of application for approval to the COGCC Director of the Oil and Gas Location Assessment, Form 2A.

Major equipment to be used will be a standard type drilling rig with associated support equipment. The drilling pad is designed to accommodate both a cuttings pit with temporary storage pile and a produced water impoundment to facilitate temporary water storage and subsequent trucking to offsite disposal. After successful drilling operations, completions operations will occupy the same pad location. Future placement of production equipment will require six condensate and water storage tanks and three separators with a combustor.

Enclosed please find scaled plats showing pad layout detail and area access roads with pipeline routing. Also, included is a topographic plat showing existing area surface water and riparian drainages with distances to the pad location.

All information provided herewith was contained in the completed Form 2A package submitted for regulatory approval of Application for Permit to Drill and available for review on the COGCC website. Any comments you think appropriate may be submitted to the Director on the website.

Any questions related to this information or this matter may be directed to the unsigned.

Very truly yours,

Robert W. Richardson, CPL
Land Manager
Dejour Energy USA Corp.

cc: registered Garfield County designee

RECEIVED
10-17-11

RECEIVED
DEC 15 2011
COGCC

SENDER: COMPLETE THIS SECTION	COMPLETE THIS SECTION ON DELIVERY
<ul style="list-style-type: none">Complete items 1, 2, and 3. Also complete item 4 if Restricted Delivery is desired.Print your name and address on the reverse so that we can return the card to you.Attach this card to the back of the mailpiece, or on the front if space permits.	A. Signature X <i>Kent Jolley</i> <input type="checkbox"/> Agent <input type="checkbox"/> Addressee
1. Article Addressed to: Kent Jolley 832 Canyon Crk Rd Glenwood Sprgs CO 81601	B. Received by (Printed Name) C. Date of Delivery 10-13-11
2. Article Number (Transfer from service label) 7010 1870 0000 4535 5060	D. Is delivery address different from item 1? <input type="checkbox"/> Yes If YES, enter delivery address below: <input checked="" type="checkbox"/> No
PS Form 3811, February 2004	3. Service Type <input checked="" type="checkbox"/> Certified Mail <input type="checkbox"/> Express Mail <input type="checkbox"/> Registered <input type="checkbox"/> Return Receipt for Merchandise <input type="checkbox"/> Insured Mail <input type="checkbox"/> C.O.D.
Domestic Return Receipt	4. Restricted Delivery? (Extra Fee) <input type="checkbox"/> Yes
102595-02-M-1540	

SENDER: COMPLETE THIS SECTION	COMPLETE THIS SECTION ON DELIVERY
<ul style="list-style-type: none">Complete items 1, 2, and 3. Also complete item 4 if Restricted Delivery is desired.Print your name and address on the reverse so that we can return the card to you.Attach this card to the back of the mailpiece, or on the front if space permits.	A. Signature X <i>Denice Brown</i> <input type="checkbox"/> Agent <input type="checkbox"/> Addressee
1. Article Addressed to: Denice Brown Garfield County 0375 CR 352 Bldg 266 Rifle CO 81650-8412	B. Received by (Printed Name) C. Date of Delivery
2. Article Number (Transfer from service label) 7010 1870 0000 4535 5077	D. Is delivery address different from item 1? <input type="checkbox"/> Yes If YES, enter delivery address below: <input type="checkbox"/> No
PS Form 3811, February 2004	3. Service Type <input checked="" type="checkbox"/> Certified Mail <input type="checkbox"/> Express Mail <input type="checkbox"/> Registered <input type="checkbox"/> Return Receipt for Merchandise <input type="checkbox"/> Insured Mail <input type="checkbox"/> C.O.D.
Domestic Return Receipt	4. Restricted Delivery? (Extra Fee) <input type="checkbox"/> Yes
102595-02-M-1540	

T. 6 S., R. 91 W., 6th P.M.

RECEIVED
DEC 15 2011
COGCC

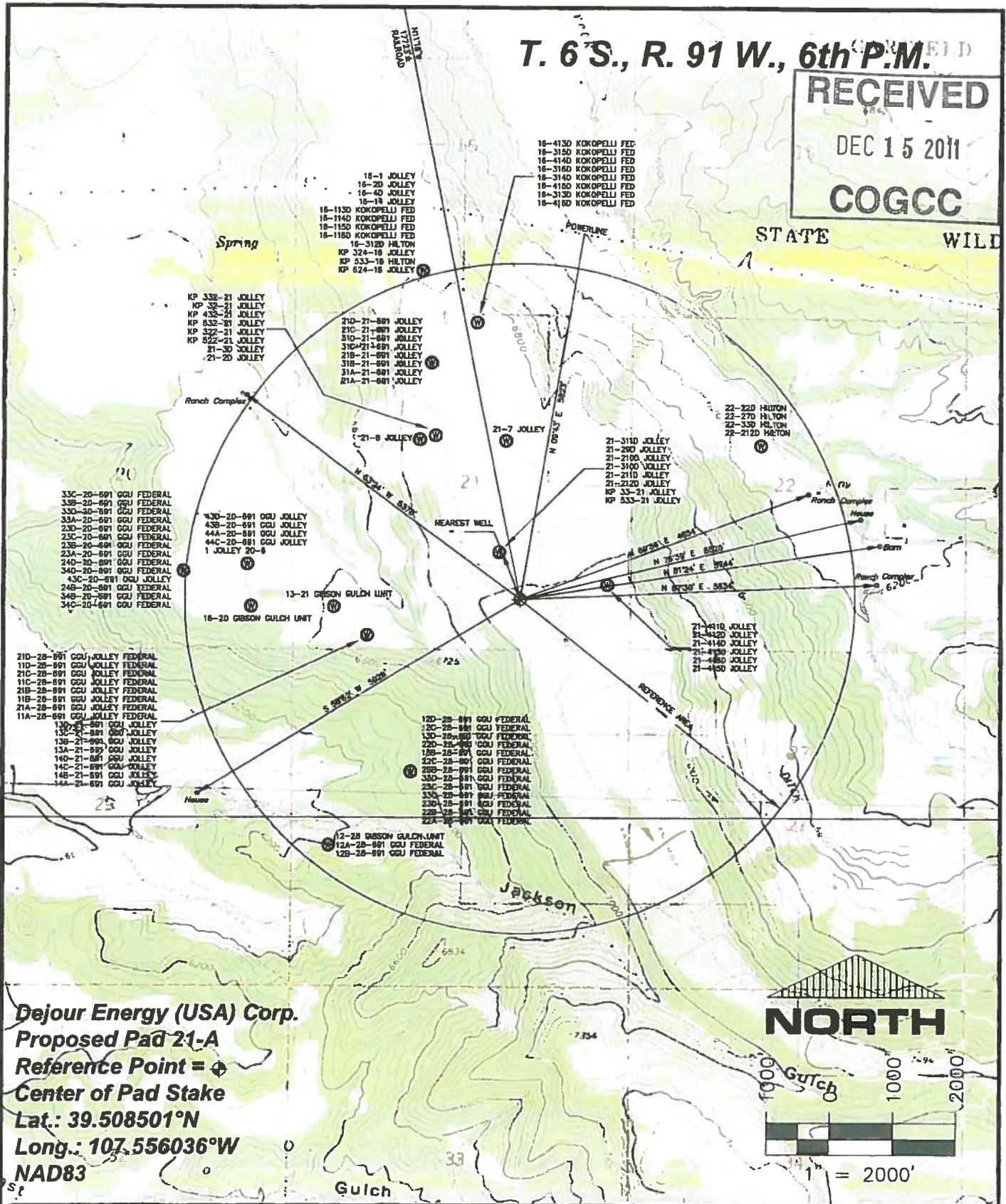

Dejour Energy (USA) Corp.
Proposed Pad 21-A
Reference Point = 
Center of Pad Stake
Lat.: 39.508501°N
Long.: 107.556036°W
NAD83

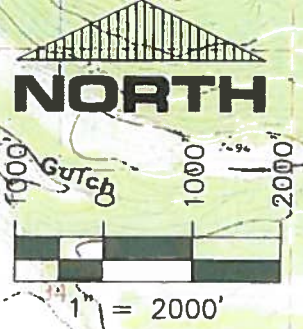

SGM INC.
 118 W. 6th Street, Suite 200
 Glenwood Springs, Co. 81601
 (970)945-1004 www.SGM-Inc.com
 320 Third St. Meeker, Co. 81641

1" = 2000'
 Sheet 3 of 9
 Dejour Pad 21A

Topographic & Reference Area Map
Dejour Energy (USA) Corp. Pad 21-A
 Job# 2010-112.001 Date: 4/22/2011 By: BG File: APD-SWSE_Sec21

RECEIVED

DEC 15 2011

COGCC

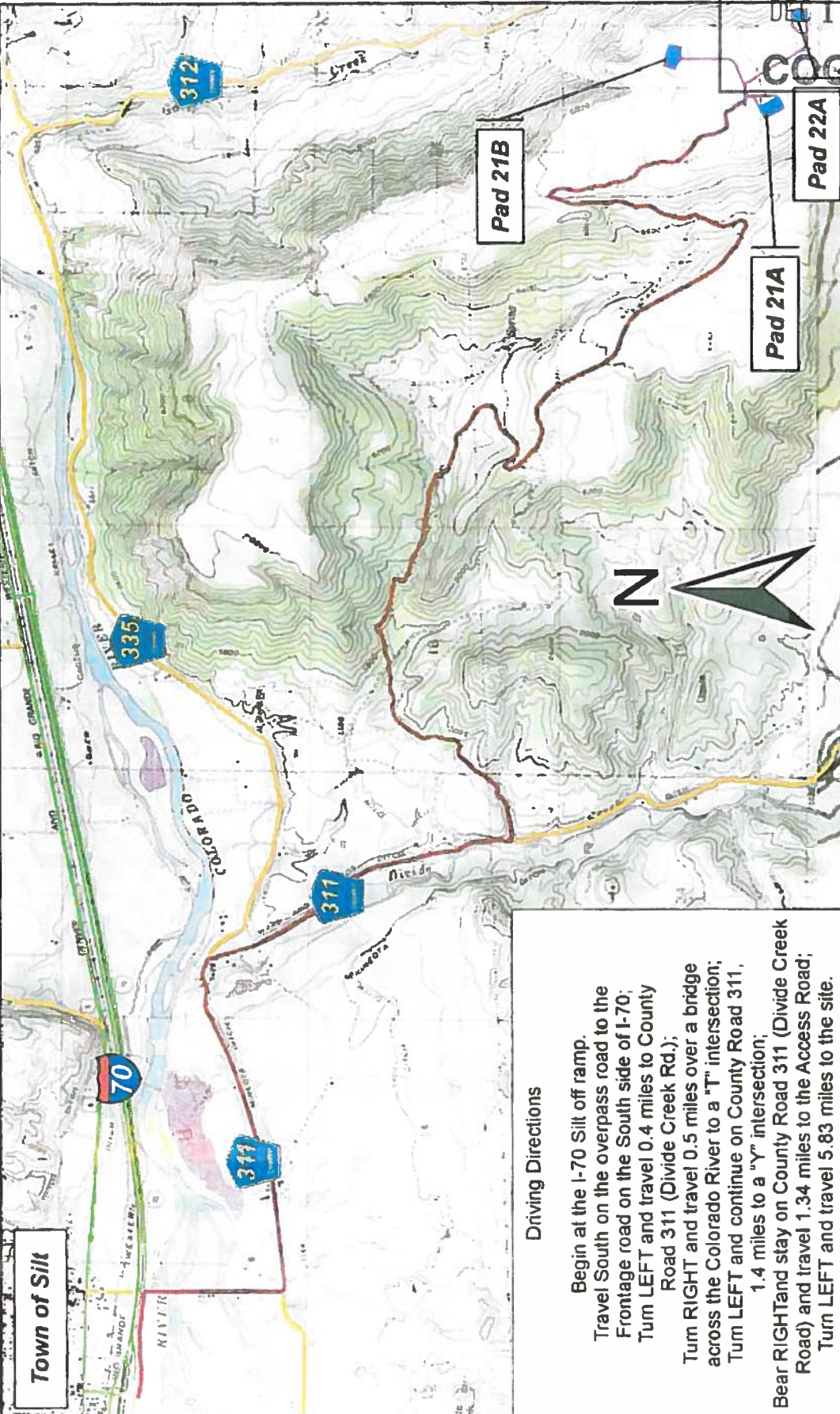

Town of Silt

Driving Directions

Begin at the I-70 Silt off ramp.
 Travel South on the overpass road to the Frontage road on the South side of I-70;
 Turn LEFT and travel 0.4 miles to County Road 311 (Divide Creek Rd.);
 Turn RIGHT and travel 0.5 miles over a bridge across the Colorado River to a "T" intersection;
 Turn LEFT and continue on County Road 311, 1.4 miles to a "Y" intersection;
 Bear RIGHT and stay on County Road 311 (Divide Creek Road) and travel 1.34 miles to the Access Road;
 Turn LEFT and travel 5.83 miles to the site.



SCHMUESER GORDON MEYER
 ENGINEERS SURVEYORS

SGM INC.
 118 W. 6th Street, Suite 200
 Glenwood Springs, Colorado 81601
 (970)945-1004 www.SGM-Inc.com
 Meeker, Colorado (970)878-5180

NO SCALE
 Sheet 8 of 9
 Pad 21A

Dejour Energy (USA) Pad 21A Access Map
 Sec. 21, T.6S., R.91W., 6th P.M., Garfield County, CO
 Job# 2010-112.001 Date: 4/22/11 By: BG File: JM_Access

Onyskiw, Denise

From: Faith, Melanie [Melanie.Faith@williams.com]
Sent: Tuesday, December 27, 2011 4:52 PM
To: Onyskiw, Denise; Nelson, Sandra; Hotard, Bryan; Woodworth, Ty; Gates, Trevor; Roberts, Kim; Kent Jolley; 'Brett Jolley'; Romatzke, JT; rrichardson@dejour.com; Bill Mitchell
Subject: Dejour PWD Federal 21-6-91
Attachments: Williams Letter 12_27_11.pdf

All—

Please see the attached letter from Williams to COGCC Director, Mr. David Neslin, regarding Dejour's application for Produced Water Disposal well, Dejour PWD Federal 21-6-91.

Please don't hesitate to contact me should you have any questions or concerns.

Thank you,

Melanie

Melanie Rooke Faith, CPL

Williams Production RMT Company LLC
Exploration & Production
1001 17th Street
Suite 1200
Denver, Colorado 80202
melanie.rooke@williams.com
303/606-4391 (Direct)
303/629-8281 (Fax)



Sent Via Federal Express Overnight Mail



December 27, 2011

Attn: Mr. David Neslin, Director
Colorado Oil & Gas Conservation Commission
1120 Lincoln Street, Suite 801
Denver, CO 80203

EXPLORATION & PRODUCTION
Williams Production RMT Company LLC
1001 17th Street, Suite 1200
Denver, CO 80202
303/572-3900 main
303/629-8281 fax

**RE: Produced Water Disposal Well (Dejour PWD Federal 21-6-91)
Dejour Drilling Pad 21A; Portion of BLM Lease COC-66370
Township 6 South – Range 91 West of the 6th P.M.
Section 21: SW/4SE/4, SE/4SW/4
Garfield County, Colorado**

Dear Mr. Neslin:

We were recently informed of Dejour Energy (USA) Corp. ("Dejour") plans for the Produced Water Disposal ("PWD") well referenced above. Williams Production RMT Company LLC ("Williams") has leasehold in the immediate vicinity of Dejour's proposed operation. We are most concerned about the impact Dejour's PWD well would have on Williams' drilled wells producing from the Cozette and Corcoran formations. Williams is concerned that Dejour's disposed water will impact at minimum two (2) of Williams' wells producing from these formations. It is conceivable that injecting into these zones would also impact additional Williams' wells due to frac communication. Therefore, Williams hereby protests Dejour's application for the said PWD well.

Please don't hesitate to contact me at (303) 606-4391 regarding any questions or concerns you may have. Thank you in advance for your consideration.

Very truly yours,

WILLIAMS PRODUCTION RMT COMPANY LLC

A handwritten signature in blue ink that reads "Melanie Rooke Faith".

Melanie Rooke Faith, CPL
Senior Landman

cc: Denise Onyskiw, Colorado Oil and Gas Conservation Commission/ Denver (via e-mail)
Bryan Hotard, Ty Woodworth; Williams/Parachute (via e-mail)
Sandra Nelson, Trevor Gates, Kim Roberts; Williams/Denver (via e-mail)
Richard and Mary Jolley Family LLLP (via e-mail)
JT Romatzke, Colorado Department of Wildlife (via e-mail)
Robert Richardson, Dejour Energy (USA) Corp./Denver (via e-mail)
Bill Mitchell, BBC/Denver (via e-mail)

FORM
2

Rev
12/05

State of Colorado Oil and Gas Conservation Commission

1120 Lincoln Street, Suite 801, Denver, Colorado 80205 Phone: (303) 894-2100 Fax: (303) 894-2109



DE ET OE ES

Document Number:

400222082

PluggingBond SuretyID

APPLICATION FOR PERMIT TO:

1. Drill, Deepen, Re-enter, Recomplete and Operate

2. TYPE OF WELL

OIL GAS COALBED OTHER Water Injection Well
SINGLE ZONE MULTIPLE COMMINGLE

Refiling

Sidetrack

3. Name of Operator: DEJOUR ENERGY (USA) CORPORATION 4. COGCC Operator Number: 10301

5. Address: 1401 17TH STREET #1000
City: DENVER State: CO Zip: 80202

6. Contact Name: Gary Haefele Phone: (303)296-3535 Fax: (303)296-3888
Email: ghaefele@dejour.com

7. Well Name: PWD Federal Well Number: 21-6-91

8. Unit Name (if appl): N/A Unit Number: N/A

9. Proposed Total Measured Depth: 9054

WELL LOCATION INFORMATION

10. QtrQtr: SWSE Sec: 21 Twp: 6S Rng: 91W Meridian: 6
Latitude: 39.508541 Longitude: -107.556063

Footage at Surface: 791 feet FSL 1782 feet FEL
FNL/FSL FEL/FWL

11. Field Name: Kokopelli Field Number: 47525

12. Ground Elevation: 7009.5 13. County: GARFIELD

14. GPS Data:

Date of Measurement: 04/12/2010 PDOP Reading: 3.0 Instrument Operator's Name: Kyle Tesky

15. If well is Directional Horizontal (highly deviated) **submit deviated drilling plan.**

Footage at Top of Prod Zone: FNL/FSL FEL/FWL Bottom Hole: FNL/FSL FEL/FWL
657 FSL 2668 FEL 657 FSL 2668 FEL
Sec: 21 Twp: 6S Rng: 91W Sec: 21 Twp: 6S Rng: 91W

16. Is location in a high density area? (Rule 603b)? Yes No

17. Distance to the nearest building, public road, above ground utility or railroad: 4854 ft

18. Distance to nearest property line: 448 ft 19. Distance to nearest well permitted/completed in the same formation(BHL): 700 ft

20. LEASE, SPACING AND POOLING INFORMATION

Objective Formation(s)	Formation Code	Spacing Order Number(s)	Unit Acreage Assigned to Well	Unit Configuration (N/2, SE/4, etc.)
Iles	ILES	191-70		
Williams Fork	WMFK	191-70		

21. Mineral Ownership: Fee State Federal Indian Lease #: COC66370

22. Surface Ownership: Fee State Federal Indian

23. Is the Surface Owner also the Mineral Owner? Yes No Surface Surety ID#:

23a. If 23 is Yes: Is the Surface Owner(s) signature on the lease? Yes No

23b. If 23 is No: Surface Owners Agreement Attached or \$25,000 Blanket Surface Bond \$2,000 Surface Bond \$5,000 Surface Bond

24. Using standard QtrQtr, Sec, Twp, Rng format enter entire mineral lease description upon which this proposed wellsite is located (attach separate sheet/map if you prefer):

T6S, R91W, 6th PM; Sec 21: E2NE, SESW, SWSE; Sec 22: SWNW, W2SW, SESW; Sec 25: SWSW; Sec 26: S2.

25. Distance to Nearest Mineral Lease Line: 657 ft 26. Total Acres in Lease: 680

DRILLING PLANS AND PROCEDURES

27. Is H2S anticipated? Yes No If Yes, attach contingency plan.

28. Will salt sections be encountered during drilling? Yes No

29. Will salt (>15,000 ppm TDS CL) or oil based muds be used during drilling? Yes No

30. If questions 28 or 29 are yes, is this location in a sensitive area (Rule 901.e)? Yes No

31. Mud disposal: Offsite Onsite

If 28, 29, or 30 are "Yes" a pit permit may be required.

Method: Land Farming Land Spreading Disposal Facility Other: _____

Note: The use of an earthen pit for Recompletion fluids requires a pit permit (Rule 905b). If air/gas drilling, notify local fire officials.

Casing Type	Size of Hole	Size of Casing	Wt/Ft	Csg/Liner Top	Setting Depth	Sacks Cmt	Cmt Btm	Cmt Top
CONDUCTOR	18+0/0	14+0/0	54	0	80	100	80	0
SURF	12+1/4	8+5/8	24	0	1,500	800	1,500	0
1ST	7+7/8	4+1/2	11.6	1300	9,050	665	9,050	1,300

32. BOP Equipment Type: Annular Preventer Double Ram Rotating Head None

33. Comments Air drilling may be required to set surface casing. The well is deviated to put the well bore in the center of the lease at the injection zone thus maximizing the distance to lease lines in all directions. forms 31 and 33 have been mailed to COGCC separately from this filing. Surface above the injection well BHL is also leased (federal lease #66370).

34. Location ID: 426533

35. Is this application in a Comprehensive Drilling Plan? Yes No

36. Is this application part of submitted Oil and Gas Location Assessment? Yes No

I hereby certify all statements made in this form are, to the best of my knowledge, true, correct, and complete.

Signed: _____ Print Name: Gary Haefele

Title: Operations Manager Date: 12/8/2011 Email: ghaefele@dejour.com

Based on the information provided herein, this Application for Permit-to-Drill complies with COGCC Rules and applicable orders and is hereby approved.

COGCC Approved: _____ Director of COGCC Date: _____

API NUMBER

05

Permit Number: _____ Expiration Date: _____

CONDITIONS OF APPROVAL, IF ANY:

All representations, stipulations and conditions of approval stated in the Form 2A for this location shall constitute representations, stipulations and conditions of approval for this Form 2 Permit-to-Drill and are enforceable to the same extent as all other representations, stipulations and conditions of approval stated in this Permit-to-Drill.

- (1) COMPLIANCE WITH THE MOST CURRENT REVISION OF THE NORTHWEST COLORADO NOTIFICATION POLICY IS REQUIRED.
- (2) GARFIELD COUNTY RULISON-FIELD NOTICE TO OPERATORS. NOTE: ALL NOTICES SHALL BE GIVEN VIA E-MAIL. SEE ATTACHED NOTICE.
- (3) NEW MAMM CREEK FIELD NOTICE TO OPERATORS APPLIES TO THIS WELL. NOTE: ALL NOTICES SHALL BE GIVEN VIA E-MAIL. SEE ATTACHED NOTICE.
- (4) COMPLIANCE WITH THE NOTICE TO OPERATORS DRILLING WELLS IN THE BUZZARD, MAMM CREEK, AND RULISON FIELDS, GARFIELD COUNTY AND MESA COUNTY – PROCEDURES AND SUBMITTAL REQUIREMENTS FOR COMPLIANCE WITH COGCC ORDER NOS. 1-107, 139-56, 191-22, AND 369-2 (JULY 8, 2010) -- IS REQUIRED. SEE ATTACHED NOTICE.
- (5) APPROVAL OF THIS FORM DOES NOT AUTHORIZE INJECTION. AUTHORIZATION TO INJECT REQUIRES APPROVAL OF FORM 31 AND FORM 33.
- (6) NO PORTION OF ANY PIT THAT WILL BE USED TO HOLD LIQUIDS SHALL BE CONSTRUCTED ON FILL MATERIAL, UNLESS THE PIT AND FILL SLOPE ARE DESIGNED AND CERTIFIED BY A PROFESSIONAL ENGINEER, SUBJECT TO REVIEW AND APPROVAL BY THE DIRECTOR PRIOR TO CONSTRUCTION OF THE PIT. THE CONSTRUCTION AND LINING OF THE PIT SHALL BE SUPERVISED BY A PROFESSIONAL ENGINEER OR THEIR AGENT. THE ENTIRE BASE OF THE PIT MUST BE IN CUT.
- (7) THE SURFACE CASING IS MORE THAN 50' BELOW THE DEPTH OF THE DEEPEST WATER WELL WITHIN 1 -MILE OF THE SURFACE LOCATION WHEN CORRECTED FOR ELEVATION DIFFERENCES. THE DEEPEST WATER WELL WITHIN 1-MILE IS 160 FEET DEEP.

Attachment Check List

Att Doc Num	Name
2537695	WELL LOCATION PLAT
400222082	FORM 2 SUBMITTED
400230767	WELL LOCATION PLAT
400230768	DEVIATED DRILLING PLAN

Total Attach: 4 Files

General Comments

<u>User Group</u>	<u>Comment</u>	<u>Comment Date</u>
Permit	off hold--oper. emailed corrected plat for BHL. corrected dist. to nearest well to 700', dist. to nearest min. lease to 657', added ILES fm. tab spacing order 191-70 per oper.'s emailed instructions. also added comment about surface ownership above the BHL.	12/13/2011 2:23:29 PM
Permit	on hold--attached plat mistakenly lists proposed BHL as SHL for lat/long., dist. to nearest well 700', not 1800', disagree w/ dist. to nearest min. lease, added ILES formation tab and spacing order 191-70	12/13/2011 8:01:13 AM
Permit	Operator answered #23, 34, and 36. This form has passed completeness.	12/12/2011 9:37:29 AM
Permit	Returned to draft. Missing #23, 34, 36	12/9/2011 7:57:18 AM

Total: 4 comment(s)

BMP

<u>Type</u>	<u>Comment</u>

Total: 0 comment(s)

SENDER: COMPLETE THIS SECTION	COMPLETE THIS SECTION ON DELIVERY	
<ul style="list-style-type: none"> Complete items 1, 2, and 3. Also complete item 4 if Restricted Delivery is desired. Print your name and address on the reverse so that we can return the card to you. Attach this card to the back of the mailpiece, or on the front if space permits. 	<p>A. Signature <input checked="" type="checkbox"/> <i>Tammy Hob</i> <input type="checkbox"/> Agent <input type="checkbox"/> Addressee</p> <p>B. Received by (Printed Name) _____ C. Date of Delivery _____</p>	
<p>1. Article Addressed to:</p> <p>Mr Bryan Hotard Williams Prod RMT Co. LLC 1058 CR 215 Parachute CO 81635</p>	<p>D. Is delivery address different from item 1? <input type="checkbox"/> Yes If YES, enter delivery address below: <input type="checkbox"/> No</p> <p>3. Service Type <input checked="" type="checkbox"/> Certified Mail <input type="checkbox"/> Express Mail <input type="checkbox"/> Registered <input type="checkbox"/> Return Receipt for Merchandise <input type="checkbox"/> Insured Mail <input type="checkbox"/> C.O.D.</p> <p>4. Restricted Delivery? (Extra Fee) <input type="checkbox"/> Yes</p>	
<p>2. Article Number (Transfer from service label) ... 7010 1870 0000 4535 5183</p>		
<p>PS Form 3811, February 2004 Domestic Return Receipt 102595-02-M-1540</p>		

SENDER: COMPLETE THIS SECTION	COMPLETE THIS SECTION ON DELIVERY	
<ul style="list-style-type: none"> Complete items 1, 2, and 3. Also complete item 4 if Restricted Delivery is desired. Print your name and address on the reverse so that we can return the card to you. Attach this card to the back of the mailpiece, or on the front if space permits. 	<p>A. Signature <input checked="" type="checkbox"/> <i>Molly Child</i> <input type="checkbox"/> Agent <input type="checkbox"/> Addressee</p> <p>B. Received by (Printed Name) _____ C. Date of Delivery _____</p>	
<p>1. Article Addressed to:</p> <p>Ms Denice Brown Garfield County Ø375 CR 352 #2060 Rifle CO 81650-8412</p>	<p>D. Is delivery address different from item 1? <input type="checkbox"/> Yes If YES, enter delivery address below: <input type="checkbox"/> No</p> <p>3. Service Type <input checked="" type="checkbox"/> Certified Mail <input type="checkbox"/> Express Mail <input type="checkbox"/> Registered <input type="checkbox"/> Return Receipt for Merchandise <input type="checkbox"/> Insured Mail <input type="checkbox"/> C.O.D.</p> <p>4. Restricted Delivery? (Extra Fee) <input type="checkbox"/> Yes</p>	
<p>2. Article Number (Transfer from service label) ... 7010 1870 0000 4535 5169</p>		
<p>PS Form 3811, February 2004 Domestic Return Receipt 102595-02-M-1540</p>		



Dejour Energy (USA) Corp.
A subsidiary of Dejour Energy Inc.
1401 17th St., Ste. 1000
Denver, CO 80202
P: (303) 296-3535
F: (303) 296-3888

COPY

December 13, 2011

Mr. Bryan Hotard
Williams Production RMT Company LLC
1058 CR 215
Parachute, CO 81635

**RE: Produced Water Disposal Well (Dejour PWD Federal 21-6-91)
Dejour Drilling Pad 21A
Portion of BLM Lease COC-66370
Section 21: SW/4SE/4, SE/4SW/4
Township 6 South-Range 91 West of the 6th P.M.
Garfield County, CO**

Dear Bryan:

Dejour Energy (USA) Corp. hereby provides you, as offset owner, notice of our application pursuant to Colorado Oil and Gas Conservation Commission ("COGCC") Rule 325j. requesting approval from the COGCC Director of Oil and Gas for dedicated injection well, Form 2.

The surface well location will utilize the existing Drilling Pad 21A which is designed to accommodate produced water temporary storage tanks and associated standard production equipment.

Completed Form 2A package submitted by Dejour for pending regulatory approval of Application for Permit to Drill as document 400222082 is available for review on the COGCC website. Any comments you think appropriate may be submitted to the Director on the website.

Any questions related to this information or this matter may be directed to the unsigned.

Very truly yours,

Robert W. Richardson, CPL
Land Manager
Dejour Energy USA Corp.

cc: registered Garfield County designee
Richard and Mary Jolley Family LLLP
Bill Barrett Corporation
State of Colorado, Div. of Parks and Wildlife

T. 6 S., R. 91 W., 6th P.M.

N 89°47'53" W 2662.44' (Calc.) N 89°33'42" W 2664.96' (Calc.)

Found Aluminum Cap
"LS 27925" 2008
Properly Marked

OPERATOR: Dejour Energy (USA) Corp.

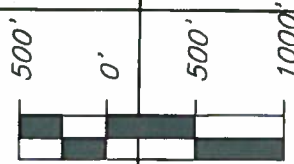

2627.46' (Calc.)
N 00°28'07" E
2627.46' (Calc.)
N 00°28'07" E

2627.04'
N 00°22'06" E
2626.94'
N 00°22'06" E

21

Found BLM Aluminum
Cap Properly Marked
2000

N 89°42' W 1333'

Found BLM Brass Cap
Properly Marked 2000

Found BLM Aluminum
Cap Properly Marked
2000

Found BLM Aluminum
Cap Properly Marked
2000

Found BLM Aluminum
Cap Properly Marked
2000

S89°43'35"E 1333.18'

S89°38'51"E 1333.78'

N00°23'43"E 1313.57'

LEASE BOUNDARY (Typ.)

Dejour Federal
PWD 21-6-91

S00°27'15"W, 1313.64'



1333.80'

1333.93'

1334.38'

1334.48'

Found Garfield Co.
Surveyor Brass Cap
Properly Marked 1978

N 89°40'52" W 2667.73'

Found BLM Aluminum
Cap Properly Marked
2000

Found Aluminum Cap
"LS 14111 Solar
Country" 1982
Properly Marked

N 89°41'54" W 2668.85'
BASIS OF BEARINGS

Found BLM Aluminum Cap
2000 Properly Marked

Found Aluminum Cap
"LS 14111 Solar
Country" 1982
Properly Marked

NOTES:

- 1: GEODETIC POSITIONS ARE SHOWN IN DECIMAL DEGREES BASED ON NAD83.
- 2: UNITS OF MEASUREMENT: U.S. SURVEY FOOT
- 3: EXISTING GROUND ELEVATION: 7009.5'. PROPOSED PAD ELEVATION: 7008.0'. ELEVATIONS HAVE BEEN DERIVED USING GPS OBSERVATIONS, GEOID 09, NAVD 88.
- 4: ALL TOP AND BOTTOM OF HOLE LOCATIONS ARE MEASURED AT 90° ANGLES FROM SECTION LINES.
- 5: BASIS OF BEARINGS: N 89°41'54" W BETWEEN FOUND MONUMENT AS SHOWN HEREON.
- 6: SEE SHEET 1E FOR EXISTING IMPROVEMENTS LOCATED IN THE VICINITY OF PROPOSED WELL.
- 7: SURFACE USE: RANGELAND
- 8: USGS QUAD MAP: NEW CASTLE
- 9: GPS OPERATOR: KYLE TESKY OBSERVED AN AVERAGE PDOP OF ≤ 3.0 FOR ALL SURVEY MEASUREMENTS DEPICTED ON THIS AND SUBSEQUENT SHEETS. ALL GPS OBSERVATIONS ARE IN COMPLIANCE WITH COGCC RULE NO. 215

FEDERAL PWD 21-6-91 NAD83	
SURFACE HOLE LOCATION	
LATITUDE = 39.508541°N	FEL = 1782'
LONGITUDE = 107.556063°W	FSL = 791'
BOTTOM HOLE LOCATION	
LATITUDE = 39.508131°N	FEL = 2668'
LONGITUDE = 107.559195°W	FSL = 657'

LEGEND:

- ⊕ - FOUND MONUMENT AS DESCRIBED HEREON
- - SURFACE HOLE LOCATION (SHL)
- ⊙ - BOTTOM HOLE LOCATION (BHL)

SURVEYORS STATEMENT

I, ELWOOD BARRY GILES, BEING A REGISTERED LAND SURVEYOR IN THE STATE OF COLORADO, DO HEREBY CERTIFY THAT THIS PLAT REPRESENTS A SURVEY PERFORMED BY ME OR UNDER MY DIRECT SUPERVISION BETWEEN APRIL, 2010 & JANUARY, 2011, AND IS CORRECT TO THE BEST OF MY KNOWLEDGE AND BELIEF. THE REFERENCE POINT WAS STAKED IN THE FIELD AS SHOWN HEREIN APRIL 2, 2010.

Elwood Barry Giles
ELWOOD BARRY GILES
COLORADO LS 38150

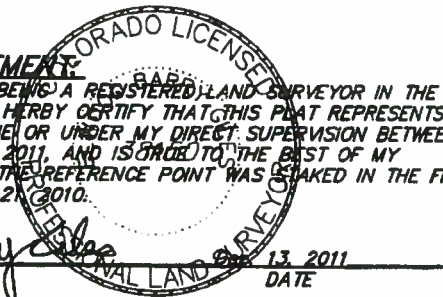

Revised 12/13/11: Correct Bottom Hole label in table



SGM INC.
118 W. 6th Street, Suite 200
Glenwood Springs, Co. 81601
(970)945-1004 www.SGM-Inc.com
320 Third St. Meeker, Co. 81641

1" = 1000'

Sheet 1F of 9

PWD 21-6-91

Well Location Plat - Federal PWD 21-6-91
SW¼SE¼, Section 21, T.6S., R.91W., 6TH P.M.

Job# 2010-112.001

Date: 5/12/2011

By: BG

File: APD-SWSE_Sec21

Onyskiw, Denise

From: Faith, Melanie [Melanie.Faith@williams.com]
Sent: Thursday, December 29, 2011 8:21 AM
To: Gretchen VanderWerf; Onyskiw, Denise; Hotard, Bryan; Woodworth, Ty; Nelson, Sandra; Gates, Trevor; Roberts, Kim; Kent Jolley; 'Brett Jolley'; Romatzke, JT; rrichardson@dejour.com; Bill Mitchell
Subject: Dejour PWD Federal 21-6-91
Attachments: Revised Williams letter packet.pdf

Good morning.

Please see the attached letter with regard to Dejour's proposed PWD Federal 21-6-91.

Please don't hesitate to contact me should you have any questions or concerns.

Thank you,

Melanie

Melanie Rooke Faith, CPL

Williams Production RMT Company LLC

Exploration & Production

1001 17th Street

Suite 1200

Denver, Colorado 80202

melanie.rooke@williams.com

303/606-4391 (Direct)

303/629-8281 (Fax)



Hand Delivered via Messenger

December 28, 2011

Attn: Mr. David Neslin, Director
Colorado Oil & Gas Conservation Commission
1120 Lincoln Street, Suite 801
Denver, CO 80203



EXPLORATION & PRODUCTION
Williams Production RMT Company LLC
1001 17th Street, Suite 1200
Denver, CO 80202
303/572-3900 main
303/629-8281 fax

**RE: Produced Water Disposal Well (Dejour PWD Federal 21-6-91)
Dejour Drilling Pad 21A; Portion of BLM Lease COC-66370
Township 6 South – Range 91 West of the 6th P.M.
Section 21: SW/4SE/4, SE/4SW/4
Garfield County, Colorado**

Dear Mr. Neslin:

As a follow up to my letter to you dated December 27, 2011 (attached hereto for your reference), for clarification, and as provided in Rule 325 I and m, Williams Production RMT Company LLC ("Williams") hereby requests a public hearing before the Commission with regard to the application before the Commission for Dejour's PWD Federal 21-6-91 well.

Please don't hesitate to contact me at (303) 606-4391 regarding any questions or concerns you may have. Thank you in advance for your consideration.

Very truly yours,

WILLIAMS PRODUCTION RMT COMPANY LLC

A handwritten signature in blue ink that reads "Melnic Rooke Faith".

Melnic Rooke Faith, CPL
Senior Landman

cc: Gretchen VanderWerf, Gretchen VanderWerf, P.C./ Denver (via e-mail)
Denise Onyskiw, Colorado Oil and Gas Conservation Commission/ Denver (via e-mail)
Bryan Hotard, Ty Woodworth; Williams/Parachute (via e-mail)
Sandra Nelson, Trevor Gates, Kim Roberts; Williams/Denver (via e-mail)
Richard and Mary Jolley Family LLLP (via e-mail)
JT Romatzke, Colorado Parks and Wildlife (via e-mail)
Robert Richardson, Dejour Energy (USA) Corp./Denver (via e-mail)
Bill Mitchell, BBC/Denver (via e-mail)

COPY



Sent Via Federal Express Overnight Mail

December 27, 2011

Attn: Mr. David Neslin, Director
Colorado Oil & Gas Conservation Commission
1120 Lincoln Street, Suite 801
Denver, CO 80203

EXPLORATION & PRODUCTION
Williams Production RMT Company LLC
1001 17th Street, Suite 1200
Denver, CO 80202
303/572-3900 main
303/629-8281 fax

**RE: Produced Water Disposal Well (Dejour PWD Federal 21-6-91)
Dejour Drilling Pad 21A; Portion of BLM Lense COC-66370
Township 6 South – Range 91West of the 6th P.M.
Section 21: SW/4SE/4, SE/4SW/4
Garfield County, Colorado**

Dear Mr. Neslin:

We were recently informed of Dejour Energy (USA) Corp. ("Dejour") plans for the Produced Water Disposal ("PWD") well referenced above. Williams Production RMT Company LLC ("Williams") has leasehold in the immediate vicinity of Dejour's proposed operation. We are most concerned about the impact Dejour's PWD well would have on Williams' drilled wells producing from the Cozette and Corcoran formations. Williams is concerned that Dejour's disposed water will impact at minimum two (2) of Williams' wells producing from these formations. It is conceivable that injecting into these zones would also impact additional Williams' wells due to frac communication. Therefore, Williams hereby protests Dejour's application for the said PWD well.

Please don't hesitate to contact me at (303) 606-4391 regarding any questions or concerns you may have. Thank you in advance for your consideration.

Very truly yours,

WILLIAMS PRODUCTION RMT COMPANY LLC

A handwritten signature in blue ink that reads "Melanie Rooke Faith".

Melanie Rooke Faith, CPL
Senior Landman

cc: Denise Onyskiw, Colorado Oil and Gas Conservation Commission/ Denver (via e-mail)
Bryan Holard, Ty Woodworth; Williams/Parachute (via e-mail)
Sandra Nelson, Trevor Gates, Kim Roberts; Williams/Denver (via e-mail)
Richard and Mary Jolley Family LLLP (via e-mail)
JT Romatke, Colorado Department of Wildlife (via e-mail)
Robert Richardson, Dejour Energy (USA) Corp./Denver (via e-mail)
Bill Mitchell, BBC/Denver (via e-mail)

Sent Via Federal Express Overnight Mail

December 27, 2011

Attn: Mr. David Neslin, Director
Colorado Oil & Gas Conservation Commission
1120 Lincoln Street, Suite 801
Denver, CO 80203

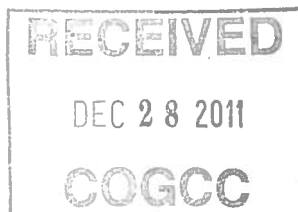

EXPLORATION & PRODUCTION
Williams Production RMT Company LLC
1001 17th Street, Suite 1200
Denver, CO 80202
303/572-3900 main
303/629-8281 fax

**RE: Produced Water Disposal Well (Dejour PWD Federal 21-6-91)
Dejour Drilling Pad 21A; Portion of BLM Lease COC-66370
Township 6 South – Range 91 West of the 6th P.M.
Section 21: SW/4SE/4, SE/4SW/4
Garfield County, Colorado**

ORIGINAL

Dear Mr. Neslin:

We were recently informed of Dejour Energy (USA) Corp. (“Dejour”) plans for the Produced Water Disposal (“PWD”) well referenced above. Williams Production RMT Company LLC (“Williams”) has leasehold in the immediate vicinity of Dejour’s proposed operation. We are most concerned about the impact Dejour’s PWD well would have on Williams’ drilled wells producing from the Cozette and Corcoran formations. Williams is concerned that Dejour’s disposed water will impact at minimum two (2) of Williams’ wells producing from these formations. It is conceivable that injecting into these zones would also impact additional Williams’ wells due to frac communication. Therefore, Williams hereby protests Dejour’s application for the said PWD well.

Please don’t hesitate to contact me at (303) 606-4391 regarding any questions or concerns you may have. Thank you in advance for your consideration.

Very truly yours,

WILLIAMS PRODUCTION RMT COMPANY LLC

Melanie Rooke Faith, CPL
Senior Landman

cc: Denise Onyskiw, Colorado Oil and Gas Conservation Commission/ Denver (via e-mail)
Bryan Hotard, Ty Woodworth; Williams/Parachute (via e-mail)
Sandra Nelson, Trevor Gates, Kim Roberts; Williams/Denver (via e-mail)
Richard and Mary Jolley Family LLLP (via e-mail)
JT Romatzke, Colorado Department of Wildlife (via e-mail)
Robert Richardson, Dejour Energy (USA) Corp./Denver (via e-mail)
Bill Mitchell, BBC/Denver (via e-mail)

Hand Delivered via Messenger

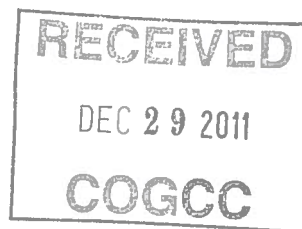

December 28, 2011

Attn: Mr. David Neslin, Director
Colorado Oil & Gas Conservation Commission
1120 Lincoln Street, Suite 801
Denver, CO 80203

EXPLORATION & PRODUCTION
Williams Production RMT Company LLC
1001 17th Street, Suite 1200
Denver, CO 80202
303/572-3900 main
303/629-8281 fax

**RE: Produced Water Disposal Well (Dejour PWD Federal 21-6-91)
Dejour Drilling Pad 21A; Portion of BLM Lease COC-66370
Township 6 South – Range 91 West of the 6th P.M.
Section 21: SW/4SE/4, SE/4SW/4
Garfield County, Colorado**

Dear Mr. Neslin:

As a follow up to my letter to you dated December 27, 2011 (attached hereto for your reference), for clarification, and as provided in Rule 325 l and m, Williams Production RMT Company LLC (“Williams”) hereby requests a public hearing before the Commission with regard to the application before the Commission for Dejour’s PWD Federal 21-6-91 well.

Please don’t hesitate to contact me at (303) 606-4391 regarding any questions or concerns you may have. Thank you in advance for your consideration.

Very truly yours,

WILLIAMS PRODUCTION RMT COMPANY LLC

Melanie Rooke Faith, CPL
Senior Landman

- cc: Gretchen VanderWerf, Gretchen VanderWerf, P.C./ Denver (via e-mail)
Denise Onyskiw, Colorado Oil and Gas Conservation Commission/ Denver (via e-mail)
Bryan Hotard, Ty Woodworth; Williams/Parachute (via e-mail)
Sandra Nelson, Trevor Gates, Kim Roberts; Williams/Denver (via e-mail)
Richard and Mary Jolley Family LLLP (via e-mail)
JT Romatzke, Colorado Parks and Wildlife (via e-mail)
Robert Richardson, Dejour Energy (USA) Corp./Denver (via e-mail)
Bill Mitchell, BBC/Denver (via e-mail)